



# TRAC 12

Miniature Low Voltage Trac System

## TRAPEZIA™ & GYRUS™

### TL130 and TL140

Project: \_\_\_\_\_

Fixture Type: \_\_\_\_\_

Location: \_\_\_\_\_

Contact/Phone: \_\_\_\_\_

#### PRODUCT DESCRIPTION

**Trapezia** suspends the MR16 lamp down from the trac with the grace of a trapeze artist. Slender 9-inch long tubes conceal lamp lead wires feeding into an elegantly sculpted die cast lamp housing. The light airy appearance is great for display, exhibition and gallery lighting and the downward reach can make pendant mounting of trac unnecessary.

**Gyrus** combines dramatic aerodynamic styling with an integrated accessory holder that accepts up to two standard 2" diameter lenses and louvers. The snap-on design makes this an easy to accessorize fixture for more demanding display lighting applications.

**Socket** Ceramic bi-pin.

**Aiming** 90° vertical aiming capability and 358° rotation.

**Labels** UL listed, CSA certified.

Specifications subject to change without notice.

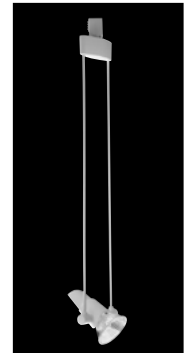

#### Low Voltage MR16 – Trapezia™

**Lamp** 50W MR16 lamps maximum • Must be used with MR16 lamps with integral lens (cover glass) except when combined with 2" accessories.

**Construction** Die cast aluminum lamp housing with integral aiming handle  
• Steel tubes conceal lamp lead wires.

**Accessories** May be used with up to two 2" accessories and/or Barn Doors simultaneously with Accessory Holder.

Catalog Number	Description	Finish	Lamp
TL130 9IN WH	9" Rods	White	50W MR16CG with integral lens (cover glass), 12V or 24V

#### ACCESSORIES

Cat. No.	Description	Cat. No.	Description	Cat. No.	Description
CGF 200	Color Glass Filter	HCLBL 200	Hexagonal Cell Louver - Black	LSPREAD 200	Linear Spread Glass Lens
DCCF 200	Dichroic Color Correction Filter	DIFF 200	Diffusion Glass Lens	SOLITE 200	Uniformity Lens (Solite)
DGF 200	Dichroic Glass Filter	UVF 200	UV Filter	PRISM 200	Prismatic Spread Glass Lens
T7400BL	Accessory Holder - Black	T7470BL	2" Diameter Barn Doors- Black		

See specification sheet [D1.2.2](#) for details.

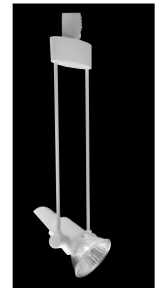
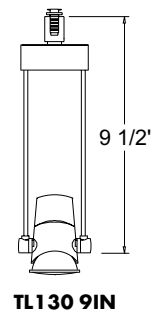

#### Low Voltage MR16 – Gyrus™

**Lamp** 50W MR16 lamps maximum.

**Lens** Glass lens included with lampholder • May be used with up to two 2" accessories simultaneously.

**Construction** Die cast aluminum lamp housing • Extruded aluminum support stem conceals lamp lead wires.

Catalog Number	Description	Finish	Lamp
TL140 WH	Gyrus™	White	50W MR16, 12V or 24V
TL140 BL	Gyrus™	Black	50W MR16, 12V or 24V
TL140 SL	Gyrus™	Silver	50W MR16, 12V or 24V

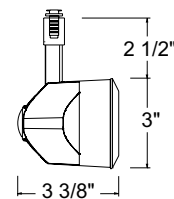

#### ACCESSORIES

Cat. No.	Description	Cat. No.	Description	Cat. No.	Description
CGF 200	Color Glass Filter	HCLBL 200	Hexagonal Cell Louver - Black	LSPREAD 200	Linear Spread Glass Lens
DCCF 200	Dichroic Color Correction Filter	DIFF 200	Diffusion Glass Lens	SOLITE 200	Uniformity Lens (Solite)
DGF 200	Dichroic Glass Filter	UVF 200	UV Filter	PRISM 200	Prismatic Spread Glass Lens

See specification sheet [D1.2.2](#) for details.



# TRAC 12

Miniature Low Voltage Trac System

## TRAPEZIA™ & GYRUS™

### TL130 and TL140

CBCP • Centerbeam candlepower  
 FC • Footcandles at beam center (aim point)

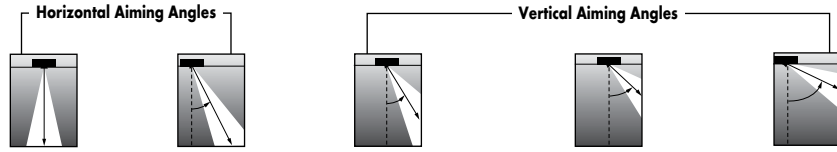

Lamp	Beam Type	Beam Spread°	Rated Life	CBCP	0°		30°			30°					45°				60°						
					MH	FC	L	W	FC	L	W	D	FC	X	L	W	FC	X	L	W	D	FC	X	L	W
Q35W MR16	SP	20°	5000	3900	4	244	1.4	1.4	158	1.9	1.6	2	122	3.5	3.1	1.4	345	2.0	1.5	1.0	4	158	2.3	1.9	1.6
					6	108	2.1	2.1	70	2.8	2.4	3	54	5.2	4.7	2.1	153	3.0	2.2	1.5	6	70	3.5	2.8	2.4
					8	61	2.8	2.8	40	3.8	3.3	4	31	6.9	6.2	2.8	86	4.0	2.9	2.0	8	40	4.6	3.8	3.3
					10	39	3.5	3.5	25	4.7	4.1	5	20	8.7	7.8	3.5	55	5.0	3.6	2.5	10	25	5.8	4.7	4.1
	FL	40°	5000	1000	4	63	2.9	2.9	41	4.1	3.4	2	31	3.5	9.6	2.9	88	2.0	3.4	2.1	4	41	2.3	4.1	3.4
					6	28	4.4	4.4	18	6.1	5.0	3	14	5.2	14.5	4.4	39	3.0	5.0	3.1	6	18	3.5	6.1	5.0
					8	16	5.8	5.8	10	8.1	6.7	4	8	6.9	19.3	5.8	22	4.0	6.7	4.1	8	10	4.6	8.1	6.7
					10	10	7.3	7.3	6	10.2	8.4	5	5	8.7	24.1	7.3	14	5.0	8.4	5.1	10	6	5.8	10.2	8.4
	NFL	15°	6000	9100	4	638	1.0	1.0	414	1.3	1.1	2	319	3.5	2.1	1.0	902	2.0	1.0	0.7	8	104	4.6	2.6	2.3
					6	283	1.5	1.5	184	2.0	1.7	3	142	5.2	3.1	1.5	401	3.0	1.5	1.0	10	66	5.8	3.3	2.8
					8	159	2.0	2.0	104	2.6	2.3	4	80	6.9	4.1	2.0	225	4.0	2.0	1.4	12	46	6.9	3.9	3.4
					10	102	2.5	2.5	66	3.3	2.8	5	51	8.7	5.1	2.5	144	5.0	2.5	1.7	14	34	8.1	4.6	4.0
FL	25°	6000	3200	4	213	1.9	1.9	138	2.6	2.2	2	106	3.5	4.6	1.9	301	2.0	2.0	1.4	4	138	2.3	2.6	2.2	
				6	94	2.9	2.9	61	3.9	3.3	3	47	5.2	7.0	2.9	134	3.0	3.1	2.0	6	61	3.5	3.9	3.3	
				8	53	3.8	3.8	35	5.2	4.4	4	27	6.9	9.3	3.8	75	4.0	4.1	2.7	8	35	4.6	5.2	4.4	
				10	34	4.8	4.8	22	6.5	5.5	5	17	8.7	11.6	4.8	48	5.0	5.1	3.4	10	22	5.8	6.5	5.5	
FL	40°	6000	1700	4	116	2.9	2.9	75	4.1	3.4	2	58	3.5	9.6	2.9	164	2.0	3.4	2.1	4	75	2.3	4.1	3.4	
				6	51	4.4	4.4	33	6.1	5.0	3	26	5.2	14.5	4.4	73	3.0	5.0	3.1	6	33	3.5	6.1	5.0	
				8	29	5.8	5.8	19	8.1	6.7	4	14	6.9	19.3	5.8	41	4.0	6.7	4.1	8	19	4.6	8.1	6.7	
				10	19	7.3	7.3	12	10.2	8.4	5	9	8.7	24.1	7.3	26	5.0	8.4	5.1	10	12	5.8	10.2	8.4	
FL	60°	6000	1700	4	116	2.9	2.9	75	4.1	3.4	2	58	3.5	9.6	2.9	164	2.0	3.4	2.1	4	75	2.3	4.1	3.4	
				6	51	4.4	4.4	33	6.1	5.0	3	26	5.2	14.5	4.4	73	3.0	5.0	3.1	6	33	3.5	6.1	5.0	
				8	29	5.8	5.8	19	8.1	6.7	4	14	6.9	19.3	5.8	41	4.0	6.7	4.1	8	19	4.6	8.1	6.7	
				10	19	7.3	7.3	12	10.2	8.4	5	9	8.7	24.1	7.3	26	5.0	8.4	5.1	10	12	5.8	10.2	8.4	
FL	60°	6000	1700	4	116	2.9	2.9	75	4.1	3.4	2	58	3.5	9.6	2.9	164	2.0	3.4	2.1	4	75	2.3	4.1	3.4	
				6	51	4.4	4.4	33	6.1	5.0	3	26	5.2	14.5	4.4	73	3.0	5.0	3.1	6	33	3.5	6.1	5.0	
				8	29	5.8	5.8	19	8.1	6.7	4	14	6.9	19.3	5.8	41	4.0	6.7	4.1	8	19	4.6	8.1	6.7	
				10	19	7.3	7.3	12	10.2	8.4	5	9	8.7	24.1	7.3	26	5.0	8.4	5.1	10	12	5.8	10.2	8.4	

The beam spread in degrees and the beam "L" and "W" in the following tables are computed at 50% of centerbeam candlepower and represent areas of "effective illumination."

\*\*Due to steep aiming angle, length of beam extends beyond 25'.