

Broan – NuTone Fan Replacement Parts

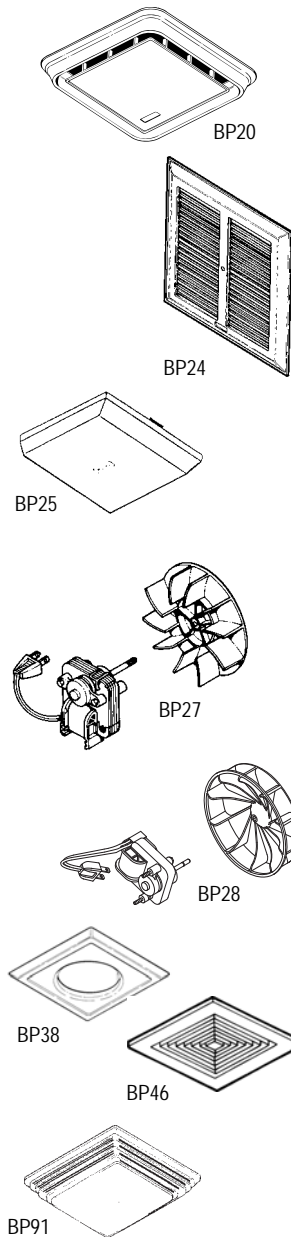

| Model No. | Description | Std. Pk. | List Price | Code |
|-----------|---|----------|------------|------|
| BP20 | Grille — Bath Fan (663, 670, 671, 675, 688 and 689) | 6 * | \$7.38 | AC |
| BP24 | Grille — Bath Fan (Metal) (660, 662, 664, 665, 666 and 668) | 15 * | \$16.72 | AC |
| BP25 | Light Lens — Fan/Light (678, 679, 679FL, 655, 656, 657, 659, 695 and 696) | 6 * | \$10.70 | AC |
| BP27 | 50 CFM Bath Fan Motor and Blower Wheel — Compatible with Broan 662, 668, 678-A, B, C, D, E, F and 688-A, B, C, D, E; Nautilus N678-A, B, C, D, E and N688-A, B, C | 6 * | \$34.66 | AC |
| BP28 | Motor/Wheel — 70 CFM (655, 657, 658, 679, 671 and 671-A) | 6 * | \$35.38 | AC |
| BP33 | Grille — Spring-Mounted (AC2650, AC2660, AC2900, 7550 and 7650) | 6 * | \$11.20 | AC |
| BP34 | Grille — Center Screw-Mounted (Aubrey 7570) | 6 * | \$11.20 | AC |
| BP35 | Grille/Knob — Utility Fan (8") | 12 * | \$14.66 | AC |
| BP36 | Light Lens (AC2550, AC25501C and 682L) | 5 * | \$14.04 | AC |
| BP38 | Grille — Single Bulb Heater | 10 * | \$14.66 | AC |
| BP46 | Grille Assembly — Spring-Mounted (663, 670, 671, 675, 688, 689, Sears and others) | 12 * | \$5.94 | AC |
| BP50 | Motor/Wheel — 50 CFM (663N, 663LN, and 696N ver. A) | 6 * | \$25.18 | AC |
| BP51 | Motor/Wheel — 70 CFM (694 and 695 ver. A) | 6 * | \$35.38 | AC |
| BP90 | Replacement Grille for 688 Fan | 4 * | \$8.42 | AC |
| BP91 | Replacement Grille and Light Lens — Each grille and light lens is individually poly bagged and labeled with installation guide. Grille and Light Lens — Fits Fan/Light for Broan 678, 679, 679FL, 679FLT, 680, 680FL, 680FLT, HD50L, HD80L, FL2679FT and FL2680FT; NuTone HD50LNT and HD80LNT; Nautilus N678, N679, N679FL and N680. Light Lens Only — Broan 655, 656, 657, 659, 695, 696 and 707; Nautilus N707. | 4 * | \$18.12 | AC |
| C350BN | 50 CFM Replacement Motor/Wheel (NuTone 696N A housing) | 1 | \$34.28 | AC |
| C350GN | Grille — NuTone 695 and 696N with 8" x 7-1/4" housing | 4 * | \$10.18 | AC |
| C370BN | 70 CFM Replacement Motor/Wheel (NuTone 695 A housing) | 1 | \$48.98 | AC |
| CVG4 | 4" Grille | 1 | \$34.34 | AC |
| CVG6 | 6" Grille | 1 | \$46.18 | AC |
| CVL4 | 4" Sleeve | 1 | \$31.98 | AC |
| CVL5 | Grille Sleeve for 5" Round Duct | 1 | \$20.00 | AC |
| CVL6 | 6" Sleeve | 1 | \$29.92 | AC |
| CVLD4 | 4" Sleeve with Damper | 1 | \$46.44 | AC |
| CVLD6 | 6" Sleeve with Damper | 1 | \$55.46 | AC |
| G686N | Grille for NuTone 686 | 4 * | \$12.32 | AC |
| RG4 | Grille for NuTone 8832SA | 1 | \$34.60 | AC |
| 834 | Filter for 8" Exhaust Fans (807C, 821C, 822C and 831C) | 1 | \$18.94 | AC |
| 854 | Filter for 10" Exhaust Fans | 6 * | \$22.84 | AC |

For model specific information, please refer to Broan Retail Parts publication (No. 99850402).

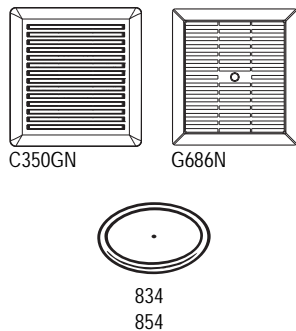

- Item too large to ship via UPS/FedEx. Item shipped common carrier at minimum rates.
- * All pricing reflects the individual item cost. You must order in multiples as indicated.
- ◆ UL listed for use over bathtubs and showers when connected to a GFCI protected branch circuit.