

Speaker Selectors

Single Source Selectors



SS-4.2 4 Pair

100W/channel RMS. Works with 4Ω stable amplifiers & receivers. Resettable circuit protection. Impedance bypass switch for use with impedance matching volume controls. Zone labels included.

Dimensions:
8.5" W x 1.875" H x 6.25" D
(220 x 48 x 160 mm)

Shipping Weight: 2.75 lbs (1.2 kg)

3630-520679 SS-4.2



SS-6.2 6 Pair

70W/channel RMS. Works with 4Ω stable amplifiers & receivers. Resettable circuit protection. Impedance bypass switch for use with impedance matching volume controls. Zone labels included.

Dimensions:
11.5" W x 1.875" H x 6.25" D
(295 x 48 x 160 mm)

Shipping Weight: 3.5 lbs (1.6 kg)

3630-520686 SS-6.2

Autoformer-Based Selectors with Volume Control



SDB-2.1 2 Pair

100W/channel RMS. Color-coded detachable 14-gauge snap connectors. Standard configuration is 2x, and installer may change configuration to 4x or 8x. Zone labels included.

Dimensions:
8.5" W x 3" H x 6.25" D
(220 x 80 x 160 mm)

Shipping Weight: 4.8 lbs (2.2 kg)

3615-604010 SDB-2.1



SDB-4.1 4 Pair

200W/channel RMS. Color-coded detachable 14-gauge snap connectors. Standard configuration is 4x, and installer may change configuration to 2x or 8x. Zone labels included.

Dimensions:
17" W x 3" H x 6.25" D
(435 x 80 x 160 mm)

Shipping Weight: 8.6 lbs (3.9 kg)

3615-604027 SDB-4.1



SDB-6.1 6 Pair

150W/channel RMS. Color-coded detachable 14-gauge snap connectors. Standard configuration is 4x, and installer may change configuration to 2x or 4x. Zone labels included.

Dimensions:
17" W x 3" H x 6.25" D
(435 x 80 x 160 mm)

Shipping Weight: 10.1 lbs (4.6 kg)

3615-604034 SDB-6.1

Autoformer-Based Selectors/Impedance Matching



PRO-6 HP 6 Pair

100W/channel RMS with subsonic filter built in. Color-coded detachable 14-gauge snap connectors. Zone labels included.

Dimensions:
17" W x 2.875" H x 8" D (435 x 75 x 205 mm)

Shipping Weight: 9.5 lbs (4.3 kg)

3610-603075 PRO-6 HP



PRO-8 HP 8 Pair

100W/channel RMS with subsonic filter, built in. Color-coded detachable 14-gauge snap connectors. Zone labels included.

Dimensions:
17" W x 2.875" H x 8" D (435 x 75 x 205 mm)

Shipping Weight: 10 lbs (4.5 kg)

3610-603136 PRO-8 HP



PRO-12 HP 12 Pair

100W/channel RMS with subsonic filter built in. Color-coded detachable 14-gauge snap connectors. Zone labels included.

Dimensions:
17" W x 2.875" H x 8" D (435 x 75 x 205 mm)

Shipping Weight: 10 lbs (4.5kg)

3610-603037 PRO-12 HP

Miscellaneous Speaker Selectors



AB-2.2 Tabletop Dual-Source

A single pair of speakers to be driven by either of two amplifiers or allow a single amplifier to drive either of two pairs of speakers.

Dimensions:
5.5" W x 2.875" H x 3" D (140 x 73.5 x 76.5 mm)

Shipping Weight: 1.25 lbs (0.57 kg)

3699-520525 AB-2.2



AB-3.2 Source Selector

Automatic A/B speaker selector, speaker level switching, selectable delay and sensitivity. Color-coded detachable 14-gauge snap connectors. Detachable 12v DC power supply.



Dimensions:
6.25" W x 2" H x 1.55" D (159 x 51 x 39 mm)

Shipping Weight: 1.7 lbs (0.8 kg)

3699-520914 AB-3.2

3699-521270 AB-3.2 EU

3699-521287 AB-3.2 UK



AB-1.2 Dual-Source

Allows a single pair of speakers to be driven by either of two amplifiers or allows a single amplifier to drive either of two pairs of speakers. Decora® wallplate not included.

Dimensions:

1" W x 2.75" H x 1.75" D (25.5 x 70 x 44.5 mm)

Shipping Weight: 3 oz (85 g)

3699-520501 White AB-1.2

3699-520532 Almond AB-1.2

Volume Controls

RUSSOUND'S VOLUME CONTROL WARRANTY

Hassle-Free Gold Guarantee

Three Reasons to Purchase Russound Volume Controls

EASY INSTALLATION

ALTx volume controls are now available with snap connection for faster, easier installation as well as more reliable connections.

BULLETPROOF

The ALTx line of Volume Controls has a high power handling capability of 126W for superior performance, added reliability and durability.

HASSLE-FREE GOLD GUARANTEE

Russound is so confident in the performance and reliability of its ALTx Volume Controls that if one should fail for any reason, we'll send you a replacement free of charge (no return necessary).

Simply contact Russound customer support with your shipping address and we will promptly send a free replacement to you. Proof of purchase may be required.

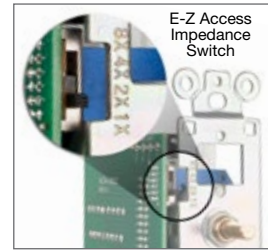

ALT-126R 126 Watt Impedance Matching Volume Control

- Easy access impedance switch behind front plate
- 126W peak, 42W RMS continuous
- 12 steps of attenuation including Off
- Accepts up to 12AWG cable
- Includes both white and Lt. Almond Decora® plates, inserts and knobs
- Easily converts to standard style plate with ALT-VC Standard Color Kit
- Lifetime warranty

Dimensions: 1.625"W x 2.675"H x 2.5"D (41 x 73 x 63 mm)

Shipping Weight: 1.2lbs (0.54kg)

6100-536281 ALT-126R White and Lt. Almond



ALT-VC Decora Color Kit

Contains 1 each of: Decora insert, Decora cover plate, screws (pair), knob.

Shipping Weight: 1 lb (0.5 kg)

- 6100-536670 Almond
- 6100-536694 Black
- 6100-536717 Bone
- 6100-536731 Brown
- 6100-536755 Lt Almond
- 6100-536779 White



ALT-VC Standard Color Kit

Converts ALT-126R to standard plate style. Contains one each of: Standard plate, knob and screws (pair).

Shipping Weight: 1 lb (0.5 kg)

- 6100-536687 Almond
- 6100-536700 Black
- 6100-536724 Bone
- 6100-536748 Brown
- 6100-536762 Lt Almond
- 6100-536786 White



WALTx-2

Weatherproof volume control with standard gray plate and knob. 12 position switch. Provides 1x, 2x, 4x, 8x impedance matching. Fits a standard 3/4" PVC outdoor conduit.



Dimensions: 3" W x 5" H x 3.75" D (76.5 x 127 x 95.5 mm)

Shipping Weight: 1.75 lbs (0.79 kg)

6500-114113 WALTx-2



EZB-8 E-Z Connect Speaker Terminal Block

Simplifies system wiring with volume control installations. Connects up to 8 pairs of speakers. Removable, screw-down connectors. Easily mounts to a wall, cabinet or structured wiring can with push-lock plugs included. Easily add additional speakers. Works with up to 12AWG wire.

Dimensions: 6.85 W x 3.0 H x 1.0" D (17.4 x 7.6 x 2.5cm)

Shipping Weight: 0.7 lbs (0.3 kg)

8100-536106 EZB-8



TBL-75 Table Top Volume Control

126 watt volume control with headphone jack speaker override. Installer configurable from 1x, 2x, 4x or 8x impedance matching.

Dimensions: 6.1" W x 2.5" H x 2" D (154 x 63.5 x 49.3 mm)

Shipping Weight: 2.5 lbs (1.1 kg)

6400-113161 TBL-75

Speaker Selector and Volume Control Diagrams

6-Zone Speaker Selector System



8-Zone Impedance Matching Volume Control System (8X setting)

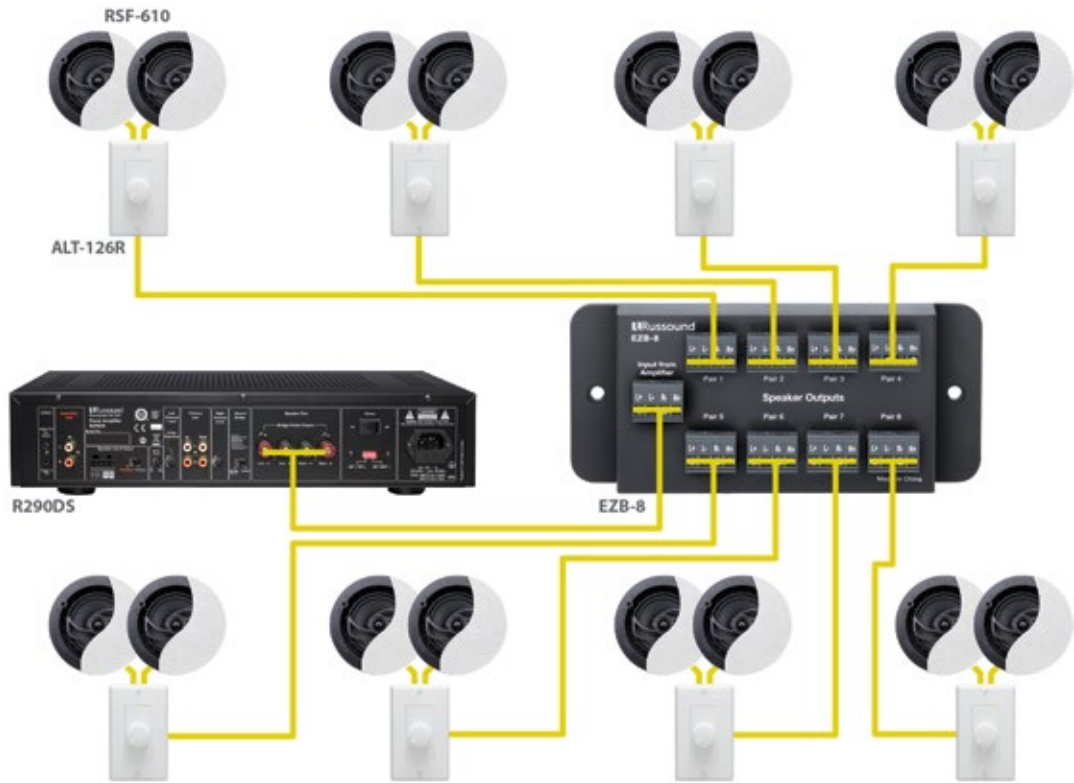

Impedance matching charts for speakers selectors and volume controls

Impedance Matching For 8-ohm Amplifiers	
4-ohm Speaker Pairs	0 1 2 3 4 5 6 7 8
0	- 1X 2X 4X 4X 8X 8X 8X 8X
1	2X 4X 4X 8X 8X 8X 8X
2	4X 8X 8X 8X 8X
3	8X 8X 8X
4	8X

Impedance Matching For 4-ohm Amplifiers	
4-ohm Speaker Pairs	0 1 2 3 4 5 6 7 8 9 10 11 12 13 14 15 16
0	- 2X 1X 2X 2X 4X 4X 4X 4X 8X 8X 8X 8X 8X 8X 8X 8X
1	1X 4X 2X 4X 4X 4X 4X 8X 8X 8X 8X 8X 8X 8X
2	2X 4X 4X 4X 4X 8X 8X 8X 8X 8X 8X 8X
3	4X 8X 4X 8X 8X 8X 8X 8X 8X 8X
4	4X 8X 8X 8X 8X 8X 8X 8X 8X
5	8X 8X 8X 8X 8X 8X
6	8X 8X 8X 8X 8X
7	8X 8X 8X
8	8X



Impedance Matching

Impedance Matching VCs vs. Impedance Matching Speaker Selectors

Examples use the RS290DS amplifier that delivers 90W/ch at 8Ω and RSF-610 Speakers that are 8Ω.

ALT-126R Volume Controls non-impedance matching (1X setting) with SS-4.2 Impedance Matching Speaker Selector
 Allows you to turn off unused zones to provide more power to the remaining zones.
 This could be useful for when a party is happening in the outdoor zone.

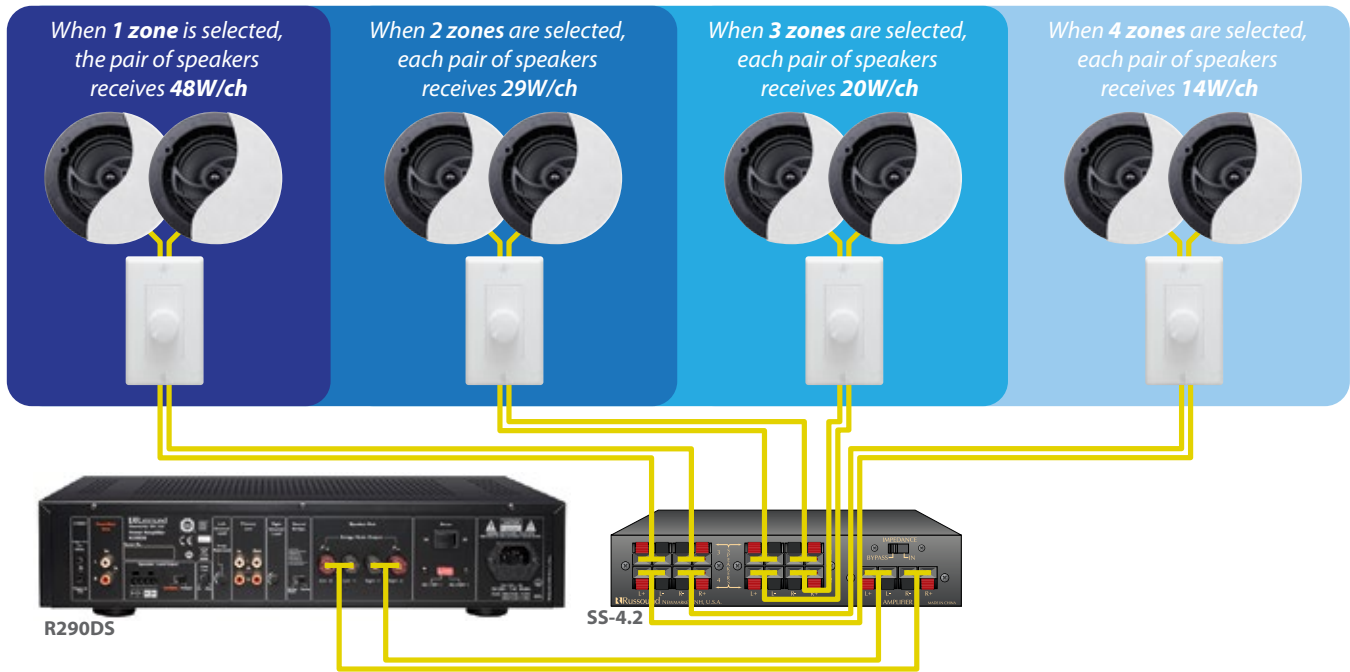

ALT-126R Volume Controls with impedance matching at 4X setting without speaker selector
 Provides protection of the power amplifier at all times. Shares power equally among the speakers regardless of demand.



Infrared Systems

SLM-1K Universal Surface Mount IR Kit

Includes:

- (1) SLM-1 IR Receiver
- (4) IRE-1 IR Emitters
- (1) CB-140 Connecting Block
- (1) CB-PS power supply

Shipping Weight: 1.5 lbs (0.68 kg)

5300-536496 SLM-1K

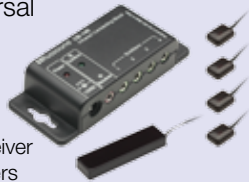

IRE-1 IR Emitter

- Low-profile design
- Blocking cover included
- Plug and Play connections with 3.5mm plug
- Emits IR from both front and rear for cabinet mounting when desired

Dimensions (emitter without cable):
0.47"W x 0.35"D x 0.18"H (11.9 x 8.9 x 4.6 mm)

Shipping Weight: 2 oz (57 g)

5300-536519 IRE-1



SLM-1 Slim-Design Surface Mount IR Receiver

- Low-profile design to blend seamlessly with modern television bezels
- Plug and Play connections with 3.5mm plug
- Universal LCD, LED, Fluorescent and Plasma friendly design

Dimension (without cable):
1.0"W x 0.52"D x 0.25"H (25.4x 13.2 x 6.4 mm)

Shipping Weight: 2 oz (57 g)

5300-536502 SLM-1



CB-140 Connecting Block

- Compact design
- Plug and Play with color-coded 3.5mm jacks
- Expands to up to 8 emitters with dual emitters
- IR confirmation LED for troubleshooting

Dimensions:
1.75"W x 4.3"D x .375"H (44.5 x 63.5 x 9.5 mm)

Shipping Weight: 2 oz (57 g)

5300-536540 CB-140



857 Connecting Block

IR receiver, accommodates up to 6 emitters, 12V power supply and 12V status power supply. LED indicators.

Shipping Weight: 4 oz (113 g)

5100-115455 857



IRJ-3 Kit

Includes connecting block (857) and power supply. Pair with other IR components.

Shipping Weight: 1 lbs (0.5 kg)

5100-521522 IRJ-3



IRJ-1 Kit

Includes IR receiver (854), connection block (857), power supply (846C) and 4 IR emitters (845.1).

Shipping Weight: 1.5 lbs (0.68 kg)

5100-521508 IRJ-1



854 Mini-Tabletop IR Receiver

CFL-friendly receiver with front panel blue talk-back indicator. 84" cable with 3.5mm plug. 12V DC.

Shipping Weight: 3 oz (85 g)

5100-121951 854



1584.1 Dual Head Emitter

Dual heads control two devices from one IR output. Miniature round design. 77" cable with 3.5 mm plug.

Shipping Weight: 6 oz (0.2 kg)

5100-113789 1584.1



IRJ-2 Kit

Includes IR receiver (862), connection block (857), power supply (846C) and 4 IR emitters (845.1).

Shipping Weight: 1.5 lbs (0.68 kg)

5100-521515 IRJ-2



862 Eye IR Receiver

CFL-friendly receiver designed for flush-mount in 1/2" hole. Blue talk-back indicator. Packaged with trim bezels in white, black and brass. 77" cable, stripped and tinned leads, and a screw terminal strip. Not compatible with CB-140 connecting block.

Shipping Weight: 2 oz (57 g)

5100-521362 862



845.2 Low Output Emitter/Blinker

Low output for compatibility with problematic cable or satellite receivers. 77" cable with 3.5 mm plug. Red IR confirmation LED for problem solving.

Shipping Weight: 6 oz (0.2 kg)

5100-530340 845.2

