

The Portable Program Download Device is simple to use. The example below demonstrates the four easy steps of downloading an application and emailing it to a remote location for application upgrade.

**Step 1.**  
Slide PPDD selector toward USB memory stick. Press PPDD download button. The PPDD will store/verify the VersaMax Micro application and configuration onto the USB memory stick.

**Step 4.**  
Place the USB memory stick in the PPDD, slide selector toward controller. Press PPDD download button. The PPDD will stop the CPU and download/verify file. The CPU can be placed in the Run mode via the key switch or cycling power.

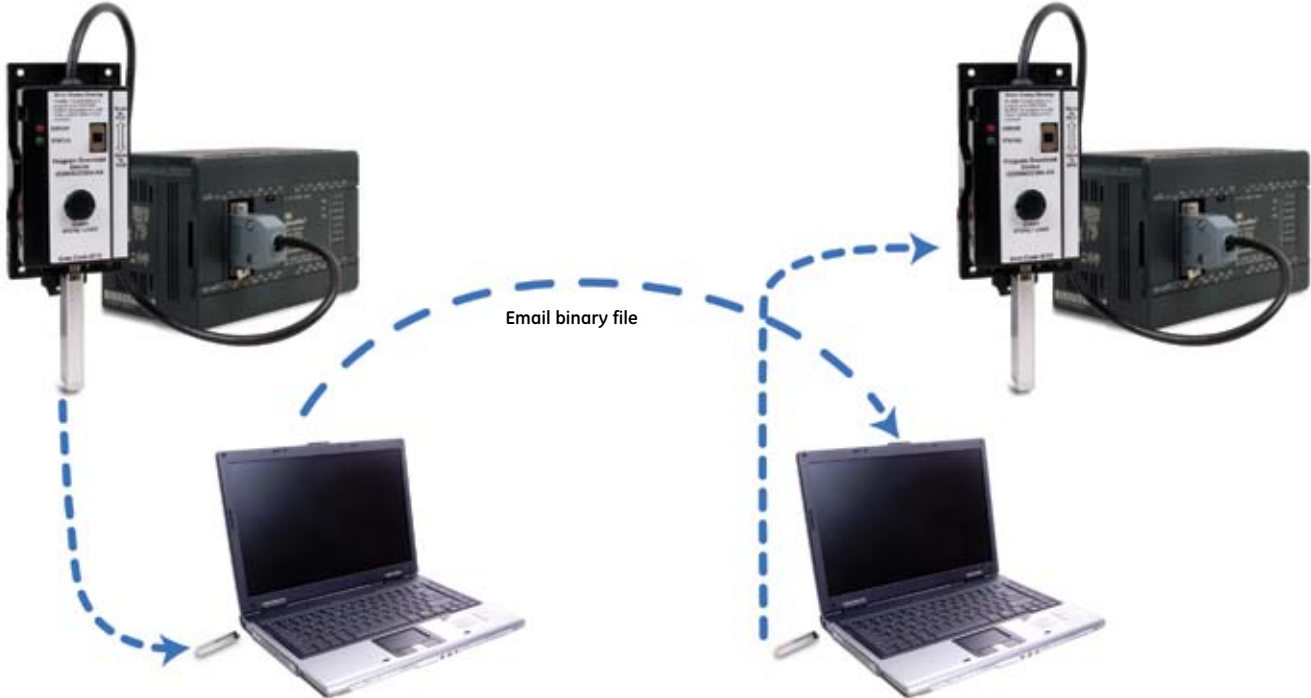

**Step 2.**  
Remove the memory stick from the PPDD and connect it to your PC. Copy the binary file from the memory stick to your PC and email to remote location.

**Step 3.**  
Remote location takes the binary file that is in the email and stores it on a USB memory stick.

## Portable Program Download Device

IC690ACC990

Portable Program Download Device. Supports standard USB memory devices to store and load VersaMax Micro 23/28 PLC applications without the need of a PC.

### Accessories

IC200ACC402	Spare Removable Terminal Strips, 10 per pack. (Micro 14, Micro 23 and Micro 28 and all expansion units)	Active
IC200ACC403	Battery for Micro 23 and Micro 28 for data retention (5.2 months minimum @ 70°C and 32.4 months minimum @ 20°C)	Active
IC200ACC404	Spare parts kit. Two terminal strips and four plastic doors and four covers for Micro 14, Micro 23 and Micro 28.	Active
IC200ACC414	Long Term Battery for Micro 23, Micro 28 and Micro 64 (19 months minimum @ 70°C and 121 months minimum @ 20°C)	Active
IC200ACC415	RS-232 to RS-485 Converter requires IC200CBL500 or equivalent.	Active
IC200ACC451	Simulator for VersaMax Micro 14, Micro 23 and Micro 28. (8 Inputs)	Active
IC200UMB001	Flash Memory Board for program download and compatible with Micro 64 (128Kbytes)	Active

### External Power Supplies

IC690PWR024	24 VDC, 5 Amp Output Power and 120/230 VAC Input Power Power Supply	Active
IC690PWR124	24 VDC, 10 Amp Output Power and 120/230 VAC Input Power Power Supply	Active

### Programming and Trouble Shooting Tools

IC646MPM101	Proficy Logic Developer - PLC Nano/Micro, Programming Cable (No Upgrades included)	Active
IC752DDZ000	VersaMax DP Operator Interface DataDesigner editor	Active

### Cables

(0.1 meter cable, IC200CBL501, is included in every expansion base package)

IC200CBL500	Programming cable (RJ-45 to DB-9 pin) RS-232. 3 Meters.	Active
IC200CBL501	I/O Expansion cable, 0.1 meter long (Qty 5)	Active
IC200CBL505	I/O Expansion cable, 0.5 meter long	Active
IC200CBL510	I/O Expansion cable, 1 meter long	Active

## Starter Kits

<b>IC200TBX010</b>	Tool box, Nano 10 and software. Includes (IC200NDR001) 24 VDC In/Relay Out, 24 VDC powered (requires an external 24 VDC Supply) with software, manuals and cables (IC646MPH101)	Active
<b>IC200TBX110</b>	Tool box, Nano 10, operator interface and software. Includes (IC200NDR001) 24 VDC In/Relay Out, 24 VDC powered (requires an external 24 VDC Supply), VersaMax DataPanel DP45 with programming software and cables, (IC640VPS00, IC752DDZ000, IC200CBL555)	Active
<b>IC200TBX210</b>	Tool box, Nano 10, Ethernet interface and software. Includes (IC200NDR001) 24 VDC In/Relay Out, 24 VDC powered (requires an external 24 VDC Supply), VersaMax SE (IC200SET001) with all software, cables (IC646MPH101) and manuals.	Active
<b>IC200TBX014</b>	Tool box, Micro 14 and software. Includes (IC200UDR001) 24 VDC In/Relay Out, AC Power Supply with software, manuals and cables (IC646MPH101)	Active
<b>IC200TBX114</b>	Tool box, Micro 14, operator interface and software. Includes (IC200UDR001) 24 VDC In/Relay Out, AC Power Supply, VersaMax DataPanel DP45 with programming software and cables, (IC640VPS00, IC752DDZ000, IC200CBL555)	Active
<b>IC200TBX214</b>	Tool box, Micro 14, Ethernet interface and software. Includes (IC200UDR001) 24 VDC In/Relay Out, requires 120 VAC power, VersaMax SE (IC200SET001) with all software, cables (IC646MPH101) and manuals.	Active
<b>IC200TBX023</b>	Tool box, Micro 23 and software. Includes (IC200UAL006) DC In/Relay Out, 2 analog In, 1 analog out, AC Power Supply with software, manuals and cables (IC646MPH101)	Active
<b>IC200TBX123</b>	Tool box, Micro 23, operator interface and software. Includes (IC200UAL006) 24 VDC In/Relay Out, 2 Analog In/1 Analog out, AC P/S, VersaMax DataPanel DP45 with programming software and cables, (IC640VPS00, IC752DDZ000, IC200CBL555)	Active
<b>IC200TBX223</b>	Tool box, Micro 23, Ethernet interface and software. Includes (IC200UAL006) 24 VDC In/Relay Out, requires 120 VAC Power, VersaMax SE (IC200SET001) with all software, cables (IC646MPH101) and manuals.	Active
<b>IC200TBX028</b>	Tool box, Micro 28 and software. Includes (IC200UDR005) 24 VDC In/Relay Out, AC Power Supply with software, manuals and cables (IC646MPH101)	Active
<b>IC200TBX128</b>	Tool box, Micro 28, operator interface and software. Includes (IC200UDR005) 24 VDC In/Relay Out, AC P/S, VersaMax DataPanel DP45 with programming software and cables, (IC640VPS00, IC752DDZ000, IC200CBL555)	Active
<b>IC200TBX228</b>	Tool box, Micro 28, Ethernet interface and software. Includes (IC200UDR005) 24 VDC In/Relay Out, requires 120 VAC Power, VersaMax SE (IC200SET001) with all software, cables (IC646MPH101) and manuals.	Active
<b>IC200TBX020</b>	Tool box, Micro 20 and software. Includes (IC200UDD020) 24VDC In/24VDC Out, DC Power Supply, (IC200USB001) RS-232 option board with (2) 0 -10VDC analog in with Proficy software, manuals and cables (IC646MPM101)	Active
<b>IC200TBX120</b>	Tool box, Micro 20 and software. Includes (IC200UDR120) 24VDC In/Relay Out, AC Power Supply, (IC200USB001) RS-232 option board with (2) 0 -10VDC analog in with Proficy software, manuals and cables (IC646MPM101)	Active
<b>IC200TBX220</b>	Tool box, Micro 20, operator interface and software. Includes (IC200UDD020) 24VDC In/24VDC Out, DC Power Supply, (IC200USB001) RS-232 option board with (2) 0 -10VDC analog in with VersaMax DataPanel DP45 with Proficy programming software and cables, (IC646MPM101, IC752DDZ000, IC200CBL555)	Active
<b>IC200TBX320</b>	Tool box, Micro 20, operator interface and software. Includes (IC200UDR120) 24VDC In/Relay Out, AC Power Supply, (IC200USB001) RS-232 option board with (2) 0 -10VDC analog in with VersaMax DataPanel DP45 with Proficy Logic Developer programming software and cables, (IC646MPM101, IC752DDZ000, IC200CBL555)	Active
<b>IC200TBX520</b>	Tool box, Micro 20, QuickPanel color touch screen and software. Includes (IC200UDR164) 24VDC In/Relay Out, AC Power Supply, (IC200UEM001) Ethernet option board, QuickPanel Display (IC754VSI06STD) with Proficy software, manuals and cables (BC646MBL001)	Active
<b>IC200TBX040</b>	Tool box, Micro 40 and software. Includes (IC200UDD040) 24VDC In/24VDC Out, DC Power Supply, (IC200USB001) RS-232 option board with (2) 0 -10VDC analog in with Proficy software, manuals and cables (IC646MPM101)	Active
<b>IC200TBX140</b>	Tool box, Micro 40 and software. Includes (IC200UDR140) 24VDC In/Relay Out, AC Power Supply, (IC200USB001) RS-232 option board with (2) 0 -10VDC analog in with Proficy software, manuals and cables (IC646MPM101)	Active
<b>IC200TBX240</b>	Tool box, Micro 40, operator interface and software. Includes (IC200UDD040) 24VDC In/24VDC Out, DC Power Supply, (IC200USB001) RS-232 option board with (2) 0 -10VDC analog in with VersaMax DataPanel DP45 with Proficy programming software and cables, (IC646MPM101, IC752DDZ000, IC200CBL555)	Active
<b>IC200TBX340</b>	Tool box, Micro 40, operator interface and software. Includes (IC200UDR140) 24VDC In/Relay Out, AC Power Supply, (IC200USB001) RS-232 option board with (2) 0 -10VDC analog in with VersaMax DataPanel DP45 with Proficy Logic Developer programming software and cables, (IC646MPM101, IC752DDZ000, IC200CBL555)	Active
<b>IC200TBX540</b>	Tool box, Micro 40, QuickPanel color touch screen and software. Includes (IC200UDR140) 24VDC In/Relay Out, AC Power Supply, (IC200UEM001) Ethernet option board, QuickPanel Display (IC754VSI06STD) with Proficy software, manuals and cables (BC646MBL001)	Active
<b>IC200TBX064</b>	Tool box, Micro 64 and software. Includes (IC200UDD064) 24 VDC In/24 VDC Out, DC Power Supply, (IC200USB001) RS-232 option board with (2) 0 -10 VDC analog in with Proficy software, manuals and cables (IC646MPM101)	Active
<b>IC200TBX164</b>	Tool box, Micro 64 and software. Includes (IC200UDR164) 24 VDC In/Relay Out, AC Power Supply, (IC200USB001) RS-232 option board with (2) 0 -10 VDC analog in with Proficy software, manuals and cables (IC646MPM101)	Active
<b>IC200TBX264</b>	Tool box, Micro 64, operator interface and software. Includes (IC200UDD064) 24 VDC In/24 VDC Out, DC Power Supply, (IC200USB001) RS-232 option board with (2) 0 -10 VDC analog in with VersaMax DataPanel DP45 with Proficy programming software and cables, (IC646MPM101, IC752DDZ000, IC200CBL555)	Active
<b>IC200TBX364</b>	Tool box, Micro 64, operator interface and software. Includes (IC200UDR164) 24 VDC In/Relay Out, AC Power Supply, (IC200USB001) RS-232 option board with (2) 0 -10 VDC analog in with VersaMax DataPanel DP45 with Proficy Logic Developer programming software and cables, (IC646MPM101, IC752DDZ000, IC200CBL555)	Active
<b>IC200TBX564</b>	Tool box, Micro 64, QuickPanel color touch screen and software. Includes (IC200UDR164) 24 VDC In/Relay Out, AC Power Supply, (IC200UEM001) Ethernet option board, QuickPanel Display (IC754VSI06STD) with Proficy software, manuals and cables (BC646MBL001)	Active