

12VDC Recess Mount LED Slim Puck Mini

Perfect for compact areas where superior lighting is key and mounting depth is limited, Slim Puck Mini is a spring loaded, easy to mount recess puck that delivers up to 95 lumens in either 3000K or 4000K.

- Desk / book shelf lighting
- Kid-friendly areas (low voltage)
- Retail display
- Elevator
- Interior accent
- Mobile home and restricted space lighting



SLIM PUCK FEATURES

- 12VDC operation
- 3000k or 4000K
- Dimmable (ELV or MLV)*
- Recess Mount Only
- Spring loaded installation
- 48" leads
- Max. pucks 20 per lead
- ETL
- 5 Year Warranty

* ELV low voltage (electric)
MLV low voltage (magnetic)



Brushed Nickel



White



Black



Bronze

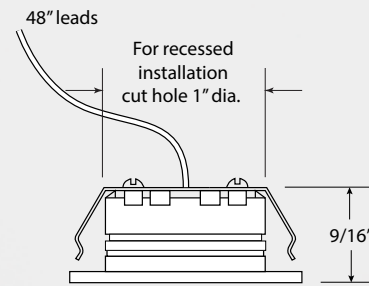
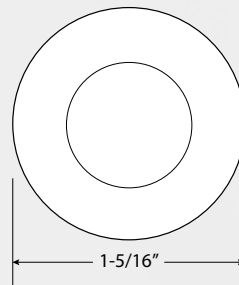

Catalog No.	Dimensions	Wattage	Lumens	Color Temp.*	CRI	Finish
SPM-1-30-W	1-5/16" dia. x 9/16" depth	1.2W	90	3000K	80+	White
SPM-1-30-BNK	1-5/16" dia. x 9/16" depth	1.2W	90	3000K	80+	Brushed Nickel
SPM-1-30-B	1-5/16" dia. x 9/16" depth	1.2W	90	3000K	80+	Black
SPM-1-30-BZ	1-5/16" dia. x 9/16" depth	1.2W	90	3000K	80+	Bronze
SPM-1-40-W	1-5/16" dia. x 9/16" depth	1.2W	95	4000K	80+	White
SPM-1-40-BNK	1-5/16" dia. x 9/16" depth	1.2W	95	4000K	80+	Brushed Nickel
SPM-1-40-B	1-5/16" dia. x 9/16" depth	1.2W	95	4000K	80+	Black
SPM-1-40-BZ	1-5/16" dia. x 9/16" depth	1.2W	95	4000K	80+	Bronze

* Kelvin temperature (color) ± 200K



LEDTASK™ 24VDC Tunable White Flexible LED Tape

The ability to alter color temps without changing fixtures is a feature that has eluded the industry, until now. Tunable white enables light to be 'fine tuned' over a spectrum of white color temps (K), thereby allowing subtle to stark ambiance changes to match the mood, or the event, or the task illuminated. Our Tunable White LED Tape can be adjusted anywhere from 2700K to 6500K through the use of a convenient hand-held remote (ordered separately). Available in 16'-4" (5M) reels.

FEATURES

- 24VDC operation (remote power supply required)
- 2700K - 6500K adjustability
- Mounts with 3M VHB™ double stick tape
- Up to 426 lumens per foot
- Maximum run on a given lead is 16'-4"

Custom lengths available - consult factory.

NOTE: CHANNELS REQUIRED FOR PROPER THERMAL MANAGEMENT



ORDERING INFORMATION

Catalog No.	Dimensions	Wattage	Lumens	Color Temp.*	CRI	Mounting Channels
CTK-24024-H0-27-65	16'-4" / 5M	6W / FT.	340 - 426	2700K - 6500K	90+	LED-CHL-45-1200 LED-CHL-W - LED-CHL-XD LED-CHL-XD-F LED-CHL-BND-4(8) CHANNEL REQUIRED FOR PROPER THERMAL MANAGEMENT

* Kelvin temperature (color) ± 200K. Each 16'-4" (5M) reel includes 24" of lead affixed at start of reel.

CONTROLLER AND CONNECTOR ORDERING INFORMATION

Catalog No.	Description
CTK-RWC	Tunable White Controller with Hand Held Remote
CTK-1	Tape to Tape Connector (5/16"W x 5/8"L x 1/5"D)
CTK-3	3" Flexible Tape to Tape 3-Wire Connector
CTK-12	12" Flexible Tape to Tape 3-Wire Connector
CTK-24	24" Flexible Tape to Tape 3-Wire Connector
CTK-36	36" Flexible Tape to Tape 3-Wire Connector
CTK-60	60" Flexible Tape to Tape 3-Wire Connector
CTK-60-C	60" Flexible Tape to Controller 3-Wire Connector

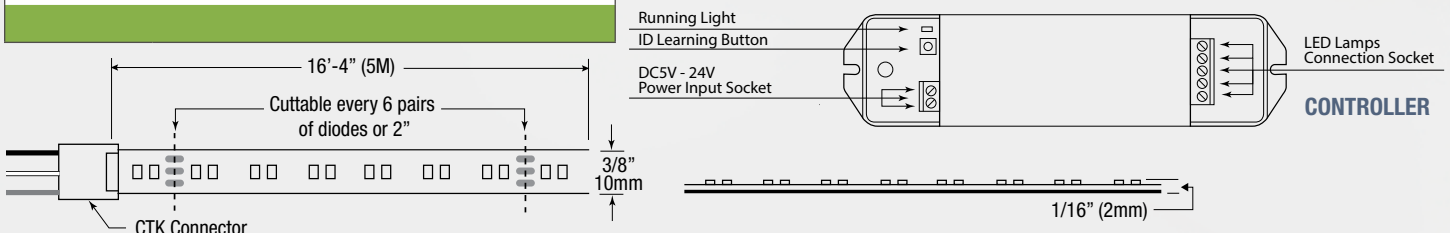
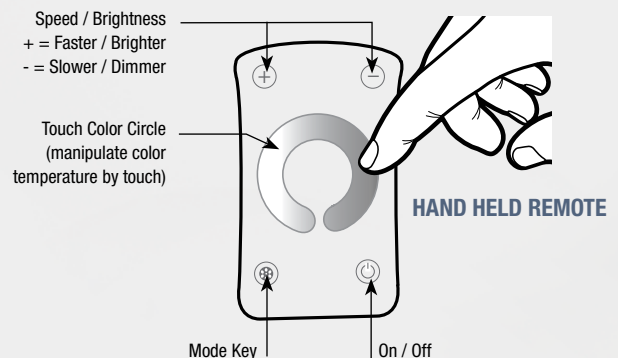



LEDTASK™ 24VDC High Density Flexible LED Tape

Our High Density High Output Flexible LED tape features a tightly arranged diode placement that produces an even, high output light. Perfect for areas that demand a strong and energy efficient light source, especially in shallow channels where a continuous, uninterrupted light source (diode imaging free) is desired. Available in 2700K, 3000K, 3500K or 4000K in 16'-4" (5M) reels.

FEATURES

- 24VDC operation (remote power supply required)
- Low profile, high density diode placement
- Mounts with 3M VHB™ double stick tape
- Up to 580 lumens per foot
- Maximum run on a given lead is 16'-4"

Custom lengths available - consult factory.

NOTE: CHANNELS REQUIRED FOR PROPER THERMAL MANAGEMENT



ORDERING INFORMATION

Catalog No.	Dimensions	Wattage	Lumens	Color Temp.*	CRI	Mounting Channels
HDT-28024-HO-27	16'-4" / 5M	5.8W / FT.	500	2700K	90+	LED-CHL-45-1200 LED-CHL-W LED-CHL-XD LED-CHL-XD-F LED-CHL-BND-4(8) CHANNEL IS REQUIRED FOR PROPER THERMAL MANAGEMENT
HDT-28024-HO-30	16'-4" / 5M	5.8W / FT.	510	3000K	90+	
HDT-28024-HO-35	16'-4" / 5M	5.8W / FT.	520	3500K	90+	
HDT-28024-HO-40	16'-4" / 5M	5.8W / FT.	580	4000K	90+	

* Kelvin temperature (color) ±200K. Each 16'-4" (5M) reel includes: 24" of lead affixed at start of reel and (3) ESTW-60 tape to tape connectors.

CONNECTOR ORDERING INFORMATION

Catalog No.	Description
ESTC-1	Sure-Tite tape to tape connector
ESTLK-60	Sure-Tite 60" flexible tape to tape connector
ESTW-60	Sure-Tite 60" flexible tape to power connector

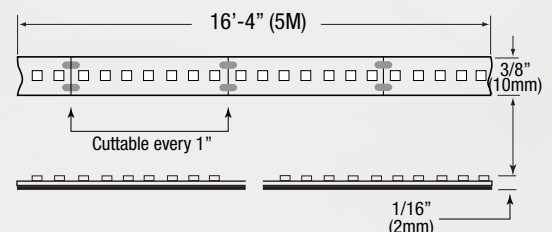

CONNECTOR DIAGRAMS

