



**HPG-2-500F**



**HXG-2-500F**



**HBG-2-500F**

**Class I, Div. 1 & 2, Groups C,D**  
**Class I, Zones 1 & 2, Groups IIB,IIA**  
**Class II, Div. 1 & 2, Groups E,F,G**

Listed\* - File E12976

Certified\* - File LR11713

\*Complete assemblies only

See Hazardous location application data

**FEATURES-SPECIFICATIONS**

**Applications**

H Series fixtures can be used for: Hazardous locations indoors and outdoors.

General lighting or process finish, storage and handling areas where flammable gases, vapor or dust may be present in the air to produce explosive or ignitable mixtures.

**Features**

- Cast of corrosion resistant aluminum alloy with electrostatically applied epoxy/polyester finish
- Heat and impact resistant pre-stressed fluted globe
- Relamp without tools—no need to remove accessories for relamping
- Fixture for lamp base-up mounting only
- Reflectors-aluminum with white finish

**Fixture Ordering Information**

- See catalog numbers shown at right
- For mogul base 300 watt PS-35 or 500 watt PS-40 lamps
- Fixture hub size is 3/4"
- Omit "G" in fixture catalog number to omit guard

H COMPLETE FIXTURES		
CATALOG NUMBER	HUB SIZE	DESCRIPTION
HPG-2-500F	3/4"	Pendant
HXG-2-500F	3/4"	Ceiling
HBG-2-500F	3/4"	Wall



**HP-2**

**HX-2**

**HB-2**

H MOUNTING SPLICE BOXES		
CATALOG NUMBER	HUB SIZE	DESCRIPTION
HP-2	3/4"	Pendant
HX-2	3/4"	Ceiling
HB-2	3/4"	Wall



**HRSD-500**

**HRD-400**

**HRA-500**

**HGSA-500F**

**EZG1G**

**HRMO**

H ACCESSORIES	
CATALOG NUMBER	DESCRIPTION
HRSD-500	Standard dome reflector 18-1/4" dia.
HRD-400	Deep reflector 21-1/8" dia.
HRA-500	Angle reflector 15-1/8" dia.
HGSA-500F	Globe with support assembly (for replacement)
EZG1G	Guard
HG-500	Guard (old style without "F" only)
HRMO	Replacement mogul socket

H APPLICATION DATA							
LAMP WATTS	RATED AMBIENT °C	CLASS I, DIV. 1 & 2		CLASS II, DIV. 1 & 2		CLASS III SUITABILITY	SUPPLY WIRE °C
		T-CODE	GROUPS	T-CODE	GROUPS		
300	40	T3C	C, D	T3C	E F G	YES	150
500	40	T3	C, D	T3	E	NO	150

**Dimensions**

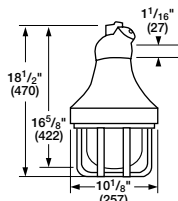

**Pendant**

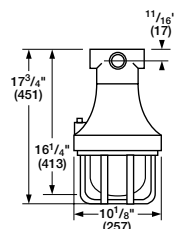

**Ceiling**

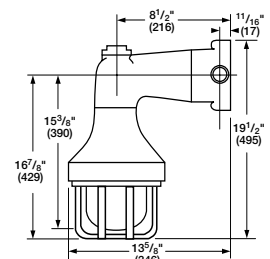

**Wall**

