



The AV Ceiling Enclosure is designed to work with active AV devices to integrate AV distribution, data connections and power in one location, providing a direct connection to a projector or a display device. An additional AV/data kit can be added or customized to address all connector, mounting and patching needs, reducing multiple pieces on site.

- Manage multiple applications inside one enclosure
- Flush mounted, white enclosure for consistent look when mounted in the ceiling
- Loaded with two Hubbell 20A duplex receptacles and a 2-gang back box
- All steel rugged construction provides the ultimate strength for installation



AVCE1H

AV Ceiling Enclosure

Description	Height Inches (mm)	Width Inches (mm)	Depth Inches (mm)	Color	Catalog Number
AV Ceiling Enclosure	12" (305)	24" (610)	8" (203)	White	AVCE1H

Note: Enclosure includes two 20 amp duplex receptacles and 2-gang back box.

netSELECT® HDMI Decorator Frames deliver uncompromising digital audio and video wherever you need it. Unleash the full potential of your high definition display and audio installations.

- Third party tested for 1080p resolutions
- UL Listed - Communications Circuit Accessory and CSA Certified

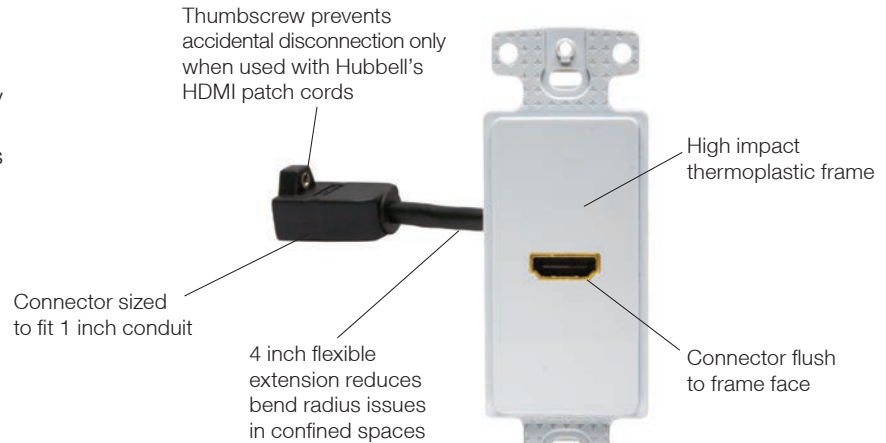

NS801W

HDMI Products

Description	Color	1-Gang, 1-Port	1-Gang, 2-Port
HDMI, Decorator Frame, Female to Female	Black	NS801BK	NS802BK
	Gray	NS801GY	NS802GY
	Ivory	NS801I	NS802I
	Light Almond	NS801LA	NS802LA
	Office White	NS801OW	NS802OW
	White	NS801W	NS802W



HDMI Patch Cords, 24 AWG



Length	HDMI Device Patch Cords	Length	Horizontal Cords (Connector to Connector)	Length	Link Cords (Connector to Device)	Length	Coupler Cords (Coupler to Device)
3 ft.	HDPC03BK	10 to 30 ft.	HDHyyBK	10 to 30 ft.	HDLyyBK	10 to 30 ft.	HDCyyBK
6 ft.	HDPC06BK						

Note: yy = Length in feet. 10 (10'), 15 (15'), 20 (20'), 25 (25'), 30 (30'). Black and non-plenum only. Black and Non-Plenum only.



Connect Your Home to Internet, Voice and Video Services

netSELECT® is an innovative network solution that's perfect for any home or small office. Specifically positioned as the voice/data segment for the Residential brand, the netSELECT® System satisfies the need for a dependable, flexible system that can accommodate all of today's fast-changing voice, data and video requirements.

This cost-effective solution incorporates all the quality you'd expect from Hubbell. Built-in flexibility makes it easy to upgrade and keep pace with evolving technologies.

- Share single analog, cable or DSL internet connection
- Local file access
- Shared peripherals
- Multiple telephone distribution
- Call handling (PBX)
- Video distribution
- Play games that allow multi-users
- Control home automation systems

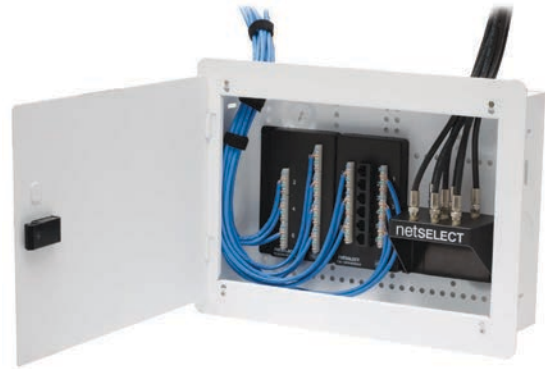

Today's Communications Entail A Lot More Than Just Talking. netSELECT® Keeps You Connected—Internet, Voice, Data and Entertainment

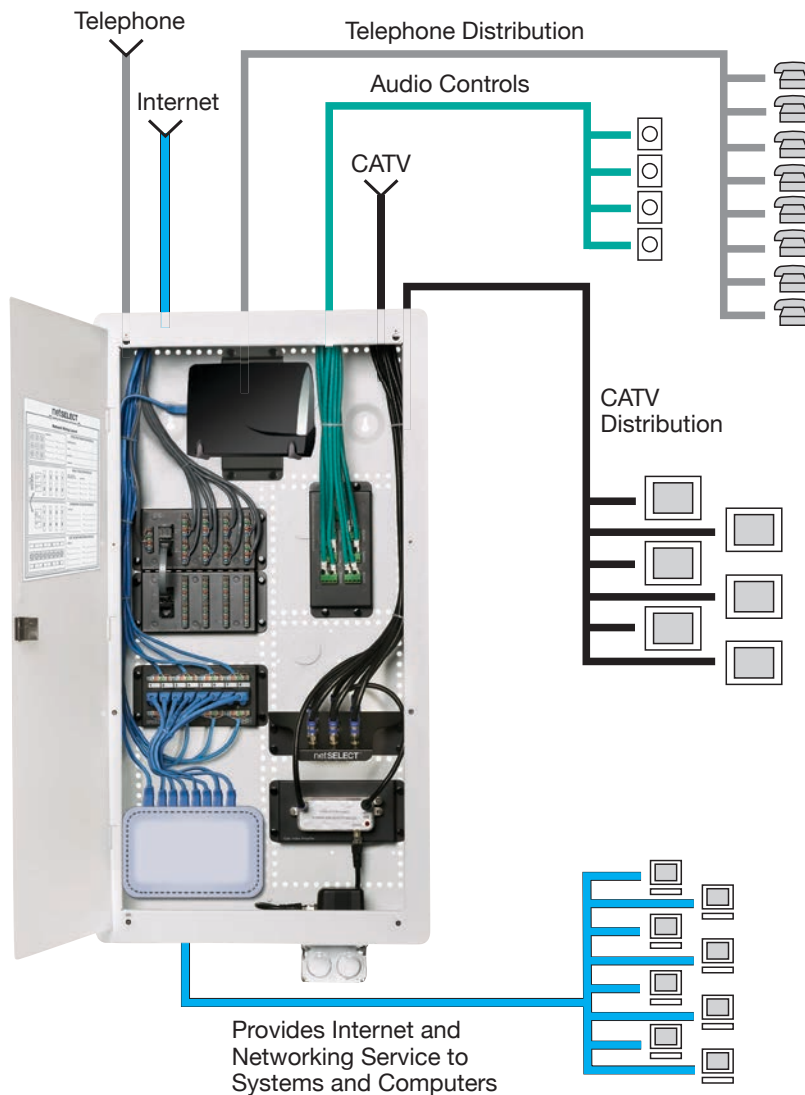

- Flush or surface mount enclosure (hardware provided)
- Hinged cover can be mounted to swing from either side
- Integral trim ring hides rough-in hole in sheet rock providing a finished appearance (except NSOBOX48)
- Horizontal and vertical module mounting holes for maximum flexibility
- Unique 89D bracket mounting holes allow easy mounting of 66 blocks and peripherals
- Provisions to mount optional duplex power and lock kit available
- Integral cable management slots and tie-wraps provided to help dress cable runs
- Additional nylon push pins provided to assist module mounting
- Material: 20-18 gauge steel
- Finish: white, powder coat
- UL and cULus Listed 1863

Network Enclosures

Pre-Configured Network System

Description	No. of Module Placement	Catalog Number
Pre-Configured Network System	–	NSOBNK14
Basic home network kit includes:		
One box with hinged cover NSOBOX14,		
One primary 8-port telephone module NSOPTM8,		
One four way coaxial splitter module NSOVM4		



NSOBOX10

10 Inch Network Enclosure for MDU and Modular Applications

Description	Height Inches (mm)	Width Inches (mm)	Depth Inches (mm)	No. of Module Placement	Catalog Number
With Hinged Cover	11.55" (293)	15.65" (398)	4.08" (104)	3	NSOBOX10
With Panel Cover	11.07" (281)	–	4.08" (104)	3	NSOBOX10BC
10"H Box only	10.07" (256)	14.38" (365)	3.96" (101)	3	NSOBOX10B
Hinged Door	11.55" (293)	15.65" (398)	0.58" (15)	–	NSOBOX10D
Panel Cover	11.07" (281)	15.50" (594)	0.20" (5)	–	NSOBOX10C



NSOBOX14

14 Inch Network Enclosure

With Hinged Cover	15.55" (395)	15.65" (398)	4.08" (104)	5	NSOBOX14
With Panel Cover	15.10" (384)	15.54" (395)	4.08" (104)	5	NSOBOX14BC
14"H Box only	14.00" (356)	14.38" (365)	3.96" (101)	5	NSOBOX14B
Hinged Door	15.55" (395)	15.65" (398)	0.33" (8)	–	NSOBOX14D
Vented Door (Louver)	15.55" (395)	15.65" (398)	0.52" (15)	–	NSOBOX14DL
Panel Cover	15.11" (384)	15.54" (395)	0.20" (5)	–	NSOBOX14C
2"D Extension Bracket with ventilation and WiFi KOs	15.30" (389)	15.57" (395)	2.00" (51)	–	NSOBOX14X2

28 Inch Network Enclosure

With Hinged Cover	29.55" (751)	–	–	11	NSOBOX28
With Panel Cover	29.13" (740)	15.54" (395)	4.08" (104)	11	NSOBOX28BC
28"H Box only	28.00" (711)	14.38" (365)	3.96" (101)	11	NSOBOX28B
Hinged Door	29.55" (751)	15.65" (398)	0.33" (8)	–	NSOBOX28D
Vented Door* (Louver)	29.55" (751)	15.65" (398)	0.52" (15)	–	NSOBOX28DL
Panel Cover	29.29" (744)	15.54" (395)	0.20" (5)	–	NSOBOX28C
2"D Extension Bracket with ventilation and WiFi KOs	29.3" (744)	15.57" (395)	2.00" (51)	–	NSOBOX28X2



NSOBOX28

48 Inch Network Enclosure

With Hinged Cover	48.94" (1243)	14.94" (379)	4.07" (103)	21	NSOBOX48*
-------------------	---------------	--------------	-------------	----	------------------

Note: *Door covers rough-in, no trim ring provided.



netSELECT® Modular Components enable the designer to select performance requirements specifically for the application. Modules snap horizontally or vertically into the enclosures for maximum flexibility and optimum space usage.

- Dimensions: 6.47 in. W x 2.95 in. H, except NSOMTM24 6.47 in. W x 6.00 in. H
- Meets FCC Part 68 standard
- Material: High impact plastic
- UL and cULus Listed 1863
- All data and phone modules 568A wired

Network Modules

Description	Units	Catalog Number
<p>Combo Module</p> <p>Complete Home Network Combo Module 6-Port Telephone Panel and 6-Port Coaxial Splitter with Optional 6-Port Cat. 5e Panel Provides voice, video, and data distribution in a space efficient package. Perfect for use with NSOBOX10 and NS790xx plates to quickly establish a comprehensive home network.</p>		
<p>6-Port Telephone and Video</p> <p>6-Port Telephone, Video and Category 5e</p> <p>6-Port Category 5e Data Upgrade Kit</p>	3	NSOTVM6
	3	NSOTVDM6
	3	NSODK6
<p>Primary Telephone Module, 8-Port</p> <p>Supports 8 phone outlets with up to 4 incoming lines for voice, fax or modem applications in a protected PCB module. Pre-mounted push pins snap the module quickly into place. RJ31X interface jack included for security system connection. RJ45 jack interfaces with optional NSOETM8 Telephone Expansion module for additional extensions.</p>	1	NSOPTM8
<p>Expansion Telephone Module, 8-Port</p> <p>Adds an additional 8 phone outlets with up to 4 incoming lines when used with the primary telephone module. Pre-mounted push pins snap the module quickly into place. Includes RJ45 jumper cord to connect with NSOPTM8 Primary Telephone module.</p>	1	NSOETM8
<p>Category 5e Data Module, 8-Port</p> <p>Supports Gigabit Ethernet for up to 8 Category 5e data lines with front 110 Punch-Down terminations in a protected PCB module. Pre-mounted push pins snap the module quickly into place.</p>	1	NSODM8
<p>Category 6 Data Module, 8-Port</p> <p>Supports enhanced transmission speeds beyond gigabit ethernet. Future proof for tomorrows applications.</p>	1	NSODM8C6
<p>Multiport Patchable Telecom Module</p> <p>Terminates lines via modular plug to accommodate flexibility, by changing plug locations. Reconfigure where phone lines go at the panel level. Allows data lines to be converted to voice, with the move of a patch cord. Includes nine RJ45 jumper cords.</p>	2	NSOMTM24
<p>Combination Module</p> <p>6-Port Telephone and 1-Port Data</p> <p>Provides basic telephone and data delivery in a small package. Allows data lines to be converted to voice, with the move of a patch cord.</p>	1	NSO6P1DM



NSOTVDM6



NSOPTM8



NSOETM8



NSODM8



NSOMTM24



NSO6P1DM

netSELECT® Video Modules support bidirectional signal by splitting to 4, 6, or 8 separate work areas. Pre-mounted push pins snap the module quickly into place.

- Dimensions for VAMP, AM8 and BM: 6.47 in. W x 2.95 in. H
- Dimensions for video splitters: 6.47 in. W x 2.09 in. H x 3.20 in. D
- Material: High impact plastic
- UL and cULus Listed 1863

Audio/Video Modules

Description	Units	Catalog Number
4-Way Coaxial Splitter Modules, One Incoming Line, Four Outgoing 1 Ghz, Basic Unit 2.3 Ghz, Enhanced Capability	1 1	NSOVM4 NSOVM42G
6-Way Coaxial Splitter Modules, One Incoming Line, Six Outgoing 1 Ghz, Basic Unit 2.3 Ghz, Enhanced Capability	1 1	NSOVM6 NSOVM62G
8-Way Coaxial Splitter Modules, One Incoming Line, Eight Outgoing 1 Ghz, Basic Unit 2.3 Ghz, Enhanced Capability	1 1	NSOVM8 NSOVM82G
Fixed Video Amplifier Module, 10dB 120 volt rated	1	NSOVAMP
Provides video signal amplification for incoming cable feeds recommended for use when more than four outputs are installed or when signal level is low. Provides 10dB forward path gain and supports current digital cable systems and modems with a passive return. Pre-mounted push pins snap the module quickly into place. Includes RG-59 cable jumper to connect amplifier to passive video splitter.		
8 Room Audio Module, Distributes audio from an amplifier to matching volume controllers. Supports up to eight rooms of audio. Power handling - 200W RMS@20° C. Requires impedance matching volume controls, see page W-21.	1	NSOAM8
Blank Module Plate Allows mounting of active components (i.e. switches, routers) or other devices (66 blocks, audio components) onto a modular platform. Can be custom drilled or used with two self-adhesive VELCRO® strips included to mount components onto module. Pre-mounted push pins snap the module quickly into place.	1	NSOBM



NSOVM4



NSOVM6



NSOVM8



NSOVAMP



NSOAM8



NSOBM

VELCRO® is a registered trademark of Velcro Industries B.V.



netSELECT® Patch Panels are excellent for designing rack systems for telephone, data and AV systems. Consolidation Blocks are ideal for small user count configurations that mount in or on the wall.

- Meets ANSI/TIA - Category 6 and Category 5e standards
- cULus Listed

Universal Consolidation Blocks and Patch Panels

Description	Catalog Number
Category 5e 12-Port Universal Consolidation Block, 89D Bracket Mount	NS5E12U
Category 6 12-Port Universal Consolidation Block, 89D Bracket Mount	NS612U
Category 5e Universal Patch Panel 24-port, 1.75 inch H, 1 Rack Unit 48-port, 3.50 inch H, 2 Rack Units	NS5E24U NS5E48U
Category 6 Universal Patch Panel 24-port, 1.75 inch H, 1 Rack Unit 48-port, 3.50 inch H, 2 Rack Units	NS624U NS648U



NS5E12U



NS612U



NS5E24U



NS5E48U



NS624U





NS648U

netSELECT® Patch Cords allow for quick change of voice/data lines with insertion of modular plugs.

- Meets and exceeds ANSI/TIA - Category 6 and Category 5e standards
- UL and cUL Listed

Universal Patch Cords, Category 6 and Category 5e

Description	Color	1-Foot	3-Foot	5-Foot	7-Foot	10-Foot	15-Foot	20-Foot	25-Foot
Cat. 5e Patch Cord 	Blue	HC5EB01	HC5EB03	HC5EB05	HC5EB07	HC5EB10	HC5EB15	HC5EB20	HC5EB25
	Gray	HC5EGY01	HC5EGY03	HC5EGY05	HC5EGY07	HC5EGY10	HC5EGY15	HC5EGY20	HC5EGY25
	Yellow	HC5EY01	HC5EY03	HC5EY05	HC5EY07	HC5EY10	HC5EY15	HC5EY20	HC5EY25
	Red	HC5ER01	HC5ER03	HC5ER05	HC5ER07	HC5ER10	HC5ER15	HC5ER20	HC5ER25
Cat. 6 Patch Cord 	Blue	HC6B01	HC6B03	HC6B05	HC6B07	HC6B10	HC6B15	HC6B20	HC6B25
	Gray	HC6GY01	HC6GY03	HC6GY05	HC6GY07	HC6GY10	HC6GY15	HC6GY20	HC6GY25
	Yellow	HC6Y01	HC6Y03	HC6Y05	HC6Y07	HC6Y10	HC6Y15	HC6Y20	HC6Y25
	Red	HC6R01	HC6R03	HC6R05	HC6R07	HC6R10	HC6R15	HC6R20	HC6R25