

12VDC MINI LED ADJUSTABLE SHALLOW RECESSED DOWNLIGHT FEATURING 30° ADJUSTABILITY

PROJECT

TYPE

CATALOG NUMBER

PRODUCT DESCRIPTION

A mini-recessed, extremely shallow mount (1-1/4") downlight in a compact, 12VDC luminaire. This tiny fixture works well in book shelves, entertainment centers, personal water and aircraft, or anywhere that discreet, shallow mount lighting is required. 30° adjustability.

PRODUCT SPECIFICATIONS

Construction: All metal construction with glass lens. Improved heat sink.

Electrical: LED is 3W. 50,000 hour LED life. Requires external power supply. 48" leads.

LED Specs: 120 lumens. 3000K warm white (WW).

Dimming: Product can be dimmed utilizing GM Lighting 12VDC Dimmable Power Supplies.

Mounting: Recess mount in 1-5/8" drilled hole. Spring clips capture fixture securely.

Rating: ETL listed for interior use only.

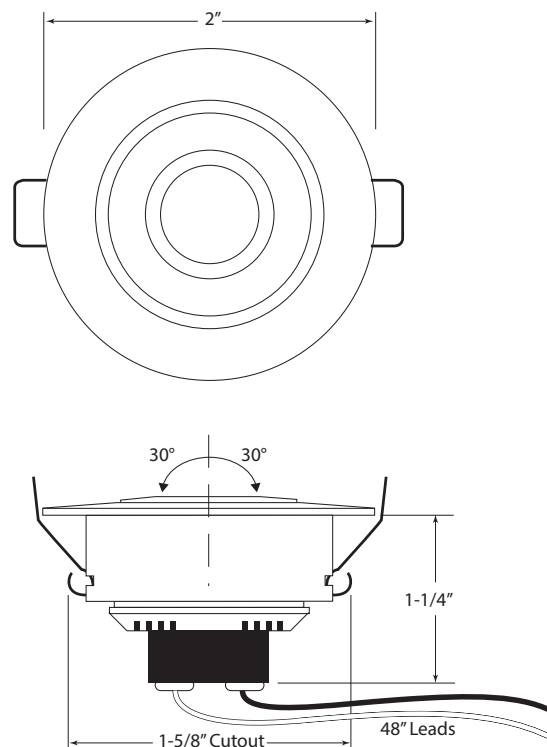
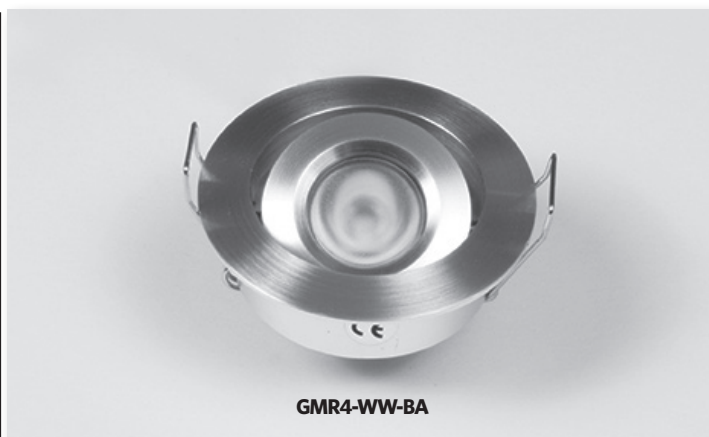

Catalog No.	Description	Wattage	Lumens	Dimensions	Finish	LED Life
GMR4-WW-W	12VDC Mini Recessed Downlight	3W	120	2" Dia x 1-1/4" D	White	50,000 hrs.
GMR4-WW-B	12VDC Mini Recessed Downlight	3W	120	2" Dia x 1-1/4" D	Black	50,000 hrs.
GMR4-WW-BA	12VDC Mini Recessed Downlight	3W	120	2" Dia x 1-1/4" D	Brushed Aluminum	50,000 hrs.

For a full line of spec sheets and mounting instructions, please see our website at www.gmlighting.net