

QuickPort® Snap-In Bulkhead Connectors

APPLICATION

QuickPort Snap-In Bulkhead Connectors provide stereo and video connectivity for workstation cabling for termination on UTP cable, speaker wire, or shielded AV cable. The connectors snap into any QuickPort housing: flush- and surface-mount outlets, Multimedia Outlet System (with adapter), Decora® Inserts, patch panels, and patch blocks.

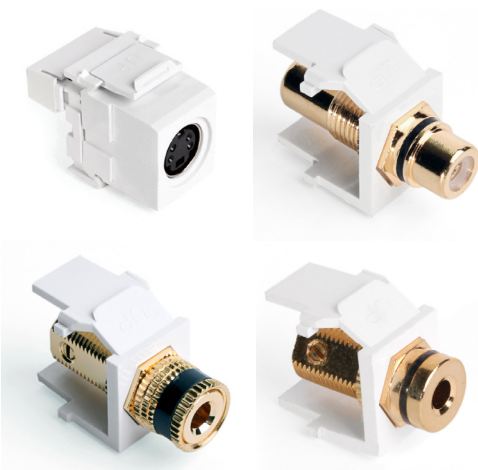

SPECIFICATION

The connectors for stereo and video connectivity shall be individual snap-in style female-to-female bulkhead adapters, and shall fit all other installed telecommunications wallplates, outlets, and field-configurable patch panels and patch blocks. S-video shall be 110-to-female. Bulkhead connectors shall be available in ivory, white, and almond to match the housings or wallplates. Connectors shall be UL listed. All plastics used in construction of the module bodies shall be fire retardant with a UL flammability rating of 94V-0.

FEATURES

- Compatible with all QuickPort wallplates, housings, and panels
- Available in a variety of colors to match housings or wallplates

DESIGN CONSIDERATIONS

- Check clearance behind proposed location of bulkhead module to ensure space for proper bend-radius of cabling media

STANDARDS COMPLIANCE

- S-Video modules are cULus Listed
- Binding Post, Banana Jack, and RCA Jack Connectors are CSA certified

PHYSICAL SPECIFICATIONS

Dimensions:	S-Video:	.636"H x .575"W x 1.092"D
	RCA:	.636"H x .575"W x 1.21"D
	Binding Post:	.636"H x .575"W x 1.19"D
	Banana Jack:	.636"H x .575"W x 1.03"D

Materials: Connector bodies are high-impact, fire-retardant plastic rated UL 94V-0.

RCA, Binding Post, and Banana Jack are gold flash-plated 5-15 µm.

COUNTRY OF ORIGIN

40734: Mexico
 40830: China
 40833: China
 40837: China

WARRANTY INFORMATION

For a copy of Leviton product warranties, visit www.leviton.com/warranty.

40734-SVx, 40830-Bxx, 40833-Bxx, 40837-Bxx

ELECTRONIC FILES

For CAD files, typical specs, or technical drawings (.DXF, .DWG), visit www.leviton.com.

40734-SVx — S-Video Connector

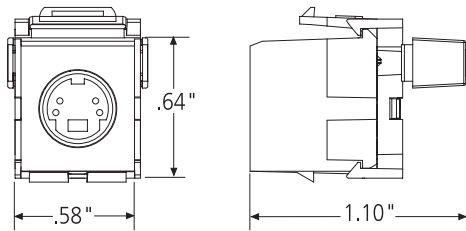

40830-Bxx — RCA Connector, feedthrough

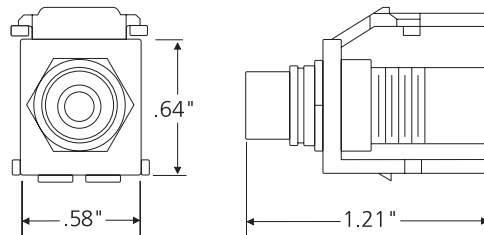

40833-Bxx — Binding Post Connector

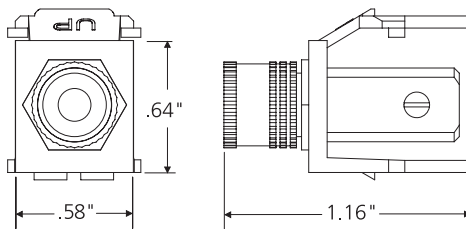

40837-Bxx — Banana Jack Connector

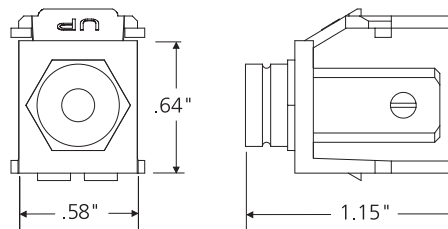

40734-SVx, 40830-Bxx, 40833-Bxx, 40837-Bxx

QUICKPORT® SNAP-IN BULKHEAD CONNECTORS

Description	WHITE	LT.ALMOND	IVORY	GREY	BLACK	BROWN
S-Video Connector, 110 Termination	40734-SVW	40734-SVT	40734-SVI	40734-SVG	40734-SVE	
RCA Connector, gold plated, feedthrough, black stripe	40830-BWE	40830-BTE	40830-BIE	40830-BGE	40830-BEE	40830-BBE
RCA Connector, gold plated, feedthrough, red stripe	40830-BWR	40830-BTR	40830-BIR	40830-BGR	40830-BER	40830-BBR
RCA Connector, gold plated, feedthrough, yellow stripe	40830-BWY	40830-BTY	40830-BIY	-	-	-
RCA Connector, gold plated, feedthrough, green stripe	40830-BWV	-	40830-BIV	-	-	-
RCA Connector, gold plated, feedthrough, blue stripe	40830-BWL	-	40830-BIL	-	-	-
Binding Post Connector, feedthrough, black stripe	40833-BWE	40833-BTE	40833-BIE	-	40833-BEE	40833-BBE
Binding Post Connector, feedthrough, red stripe	40833-BWR	40833-BTR	40833-BIR	-	40833-BER	40833-BBR
Banana Jack Connector, feedthrough, black stripe	40837-BWE	40837-BTE	40837-BIE	-	-	-
Banana Jack Connector, feedthrough, red stripe	40837-BWR	40837-BTR	40837-BIR	-	-	-



Leviton Network Solutions
 2222 - 222nd St. SE
 Bothell, WA 98021-4416

Asia / Pacific
 T +1.631.812.6228
 E infoasean@leviton.com

Canada
 T +1.514.954.1840
 E pcservice@leviton.com

Caribbean
 T +1.954.593.1896
 E info@caribbean@leviton.com

China
 T +852.2774.9876
 E infochina@leviton.com

Colombia
 T +57.1.743.6045
 E infocolombia@leviton.com

tel 1-800-824-3005
 tel +1-425-486-2222
appeng@leviton.com
www.leviton.com

Europe
 T +33.6.8869.1380
 E infoeurope@leviton.com

India / SAARC
 T +91.80.4322.5678
 E infoindia@leviton.com

Mexico
 T +52.55.5082.1040
 E lsamarketing@leviton.com

Middle East & Africa
 T +971.4.886.4722
 E lmeinfo@leviton.com

South Korea
 T +82.2.3273.9963
 E infokorea@leviton.com