

**PowerMark Gold™ generator panels** are the ideal ON/OFF switching solution for residential generators. They help ensure continuing operation of critical electrical loads — furnace, water heater, air conditioning, lighting, refrigerator, sump pump, etc. — that need to remain on during a power loss.

Contractors like the fact that PowerMark Gold generator panels are easy to install. Homeowners appreciate their ease of use and dependable performance.

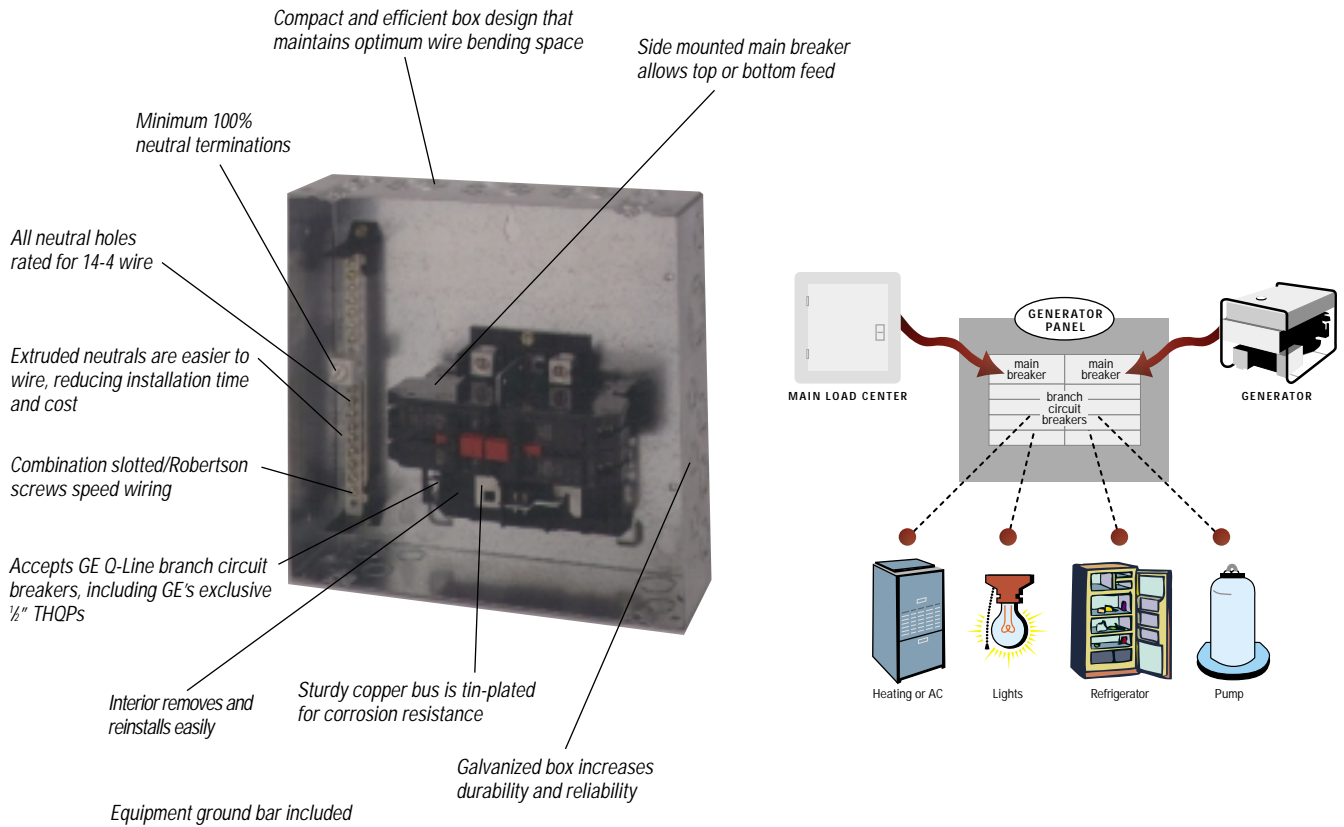

### PowerMark Gold™ Generator Panel Specifications

(With Dual Main Breaker)

30A: 7,200 peak wattage, 5,760 continuous load, 24 amps at 240 volts  
 60A: 14,400 peak wattage, 11,520 continuous load, 48 amps at 240 volts

Generator Rating	Main Amp Rating	Maximum Spaces				Total 1-pole Spaces	Generator Panel Catalog Number			Main Wire Size
		1" THQL		1/2" THQP			Indoor Flush Mount	Indoor Surface Mount	Outdoor	
		1-pole	2-pole	1-pole	2-pole					
Up to 7.5 kW	30	4	2	8	4	8	TM830FCUGEN	TM830SCUGEN	TM830RCUGEN	6-1
7.5 kW - 15 kW	60						TM860FCUGEN	TM860SCUGEN	TM860RCUGEN	

Visit us on the web [www.GEindustrial.com](http://www.GEindustrial.com)



**GE Industrial Systems**

General Electric Company  
 41 Woodford Avenue, Plainville, CT 06062  
[www.GEindustrial.com](http://www.GEindustrial.com)

©1999 General Electric Company