

# STEEL HAWG® CUTTERS



## THREADED STEEL HAWG® CUTTERS

### FAST CUTTING

- Alternating tooth geometry for up to 3X faster cutting

### LONG LIFE

- Hardened carbide steel teeth provide longer life

### 2" CUTTING DEPTH



| Size     | Part Number |
|----------|-------------|
| 3/4"     | 49-57-0750  |
| 13/16"   | 49-57-0812  |
| 7/8"     | 49-57-0875  |
| 15/16"   | 49-57-0937  |
| 1"       | 49-57-1000  |
| 1-1/16"  | 49-57-1062  |
| 1-1/8"   | 49-57-1125  |
| 1-3/16"  | 49-57-1187  |
| 1-1/4"   | 49-57-1250  |
| 1-5/16"  | 49-57-1312  |
| 1-3/8"   | 49-57-1375  |
| 1-7/16"  | 49-57-1437  |
| 1-1/2"   | 49-57-1500  |
| 1-9/16"  | 49-57-1562  |
| 1-5/8"   | 49-57-1625  |
| 1-11/16" | 49-57-1687  |
| 1-3/4"   | 49-57-1750  |
| 1-13/16" | 49-57-1812  |
| 1-7/8"   | 49-57-1875  |
| 1-15/16" | 49-57-1937  |
| 2"       | 49-57-2000  |
| 2-1/16"  | 49-57-2060  |
| 2-1/8"   | 49-57-2120  |
| 2-1/4"   | 49-57-2250  |
| 2-5/16"  | 49-57-2310  |

| Size    | Part Number |
|---------|-------------|
| 2-3/8"  | 49-57-2370  |
| 2-1/2"  | 49-57-2500  |
| 2-9/16" | 49-57-2560  |
| 2-5/8"  | 49-57-2620  |
| 2-3/4"  | 49-57-2750  |
| 2-7/8"  | 49-57-2870  |
| 3"      | 49-57-3000  |
| 3-1/8"  | 49-57-3120  |
| 3-1/4"  | 49-57-3250  |
| 3-3/8"  | 49-57-3370  |
| 3-1/2"  | 49-57-3500  |
| 3-5/8"  | 49-57-3620  |
| 3-3/4"  | 49-57-3750  |
| 3-7/8"  | 49-57-3870  |
| 4"      | 49-57-4000  |
| 4-1/8"  | 49-57-4120  |
| 4-1/4"  | 49-57-4250  |
| 4-3/8"  | 49-57-4370  |
| 4-1/2"  | 49-57-4500  |
| 4-5/8"  | 49-57-4620  |
| 4-3/4"  | 49-57-4750  |
| 5"      | 49-57-5000  |
| 5-1/2"  | 49-57-5500  |
| 6"      | 49-57-6000  |

## FOR USE WITH MILWAUKEE ELECTROMAGNETIC DRILL PRESSES AND DRILL STANDS

- **Two Styles: Threaded Or Quik-Lok With Appropriate Arbor Assemblies**
- **Carbide-Tipped Multiple Cutting Edges** – MILWAUKEE steel hawk cutters are high efficient carbide-tipped cutting tools. Alternating inside and outside cutting edges are carefully honed to cut holes rapidly with great precision.
- **Hardened Carbide** – Last longer than regular twist drills. The steel hawk cutters' multiple cutting edges uniformly distribute cutting over a wider area than a two flute twist drill tip.
- **Large Hole Cutters, Maximum 2" Depth, Up To 6" Diameter For Steel Plate, Stainless Steel, Cast Iron Or Aluminum**
- **3 Times Faster Than Twist Drills In Steel, Stainless Or Non-Ferrous Metals**

## ARBORS



| #3 Morse Taper Arbor<br>49-57-0010   | 3/4" Shank Arbor<br>49-57-0030   |
|--|--|
| <ul style="list-style-type: none"> <li>■ Works with threaded STEEL HAWG® cutters</li> <li>■ Use with motors 4292-1 and 4297-1</li> </ul> | <ul style="list-style-type: none"> <li>■ Works with threaded STEEL HAWG® cutters</li> <li>■ Use with 4262-1 motor</li> </ul> |
| <b>Includes:</b> <ul style="list-style-type: none"> <li>■ Oil hose and hand pump</li> </ul>  | <b>Includes:</b> <ul style="list-style-type: none"> <li>■ Oil hose and hand pump</li> </ul>                                  |

## QUICK CHANGE TANG STEEL HAWG® CUTTERS

### FAST CUTTING

- Alternating tooth geometry for up to 3X faster cutting with less pressure and better results than twist drill bits
- No pre-punching or pilot holes

### LONG LIFE

- Hardened carbide steel teeth provide longer life

### QUICK CHANGE

- Tool-free operation for fast changes

### 1" CUTTING DEPTH



## ARBORS



| Size    | Part Number |
|---------|-------------|
| 1/2"    | 49-57-0251  |
| 9/16"   | 49-57-0564  |
| 5/8"    | 49-57-0626  |
| 11/16"  | 49-57-0689  |
| 3/4"    | 49-57-0752  |
| 13/16"  | 49-57-0814  |
| 7/8"    | 49-57-0877  |
| 15/16"  | 49-57-0939  |
| 1"      | 49-57-1002  |
| 1-1/16" | 49-57-1064  |
| 1-1/8"  | 49-57-1127  |
| 1-3/16" | 49-57-1189  |
| 1-1/4"  | 49-57-1252  |

| Size     | Part Number |
|----------|-------------|
| 1-5/16"  | 49-57-1314  |
| 1-3/8"   | 49-57-1377  |
| 1-7/16"  | 49-57-1439  |
| 1-1/2"   | 49-57-1502  |
| 1-9/16"  | 49-57-1564  |
| 1-5/8"   | 49-57-1627  |
| 1-11/16" | 49-57-1689  |
| 1-3/4"   | 49-57-1752  |
| 1-13/16" | 49-57-1814  |
| 1-7/8"   | 49-57-1877  |
| 1-15/16" | 49-57-1939  |
| 2"       | 49-57-2002  |

| #3 Morse Taper Quick Change Arbor<br>49-57-0012   | #3 Morse Taper Quick Change Arbor w/Chip Breaker<br>49-57-0013  | 3/4" Straight Shank Quick Change Arbor<br>49-57-0032  |
|---|---|---|
| <ul style="list-style-type: none"> <li>■ Works with quick-change tang STEEL HAWG® cutters</li> <li>■ Use with motors 4292-1 and 4297-1</li> </ul> | <ul style="list-style-type: none"> <li>■ Works with quick-change tang STEEL HAWG® cutters</li> <li>■ Use with motors 4292-1 and 4297-1</li> </ul> | <ul style="list-style-type: none"> <li>■ Works with quick-change tang STEEL HAWG® cutters</li> <li>■ Use with 4262-1 motor</li> </ul> |
| <b>Includes:</b> <ul style="list-style-type: none"> <li>■ Oil hose and hand pump</li> </ul>   | <b>Includes:</b> <ul style="list-style-type: none"> <li>■ Oil hose and hand pump</li> </ul>   | <b>Includes:</b> <ul style="list-style-type: none"> <li>■ Oil hose and hand pump</li> </ul>   |

## ONE PIECE STEEL HAWG® CUTTERS

### 1/2" CUTTING DEPTH

- Recommended for use with Milwaukee® electromagnetic drill presses or hand drill

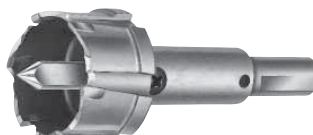

| Size      | Part Number |
|-----------|-------------|
| 11/16"    | 49-57-8068  |
| 13/16"    | 49-57-8081  |
| Pilot Bit | 49-57-0038  |