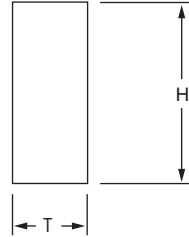
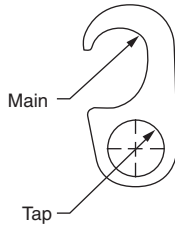

Figure 6 Compression Ground Tap Connector



MEETS

IEEE

 837 REQUIREMENTS

Blackburn® Grounding

CAT. NO.	APPLICATION		CABLE TO REBAR APPLICATION		DIMENSIONS (IN.)		DIES FOR TBM 14M, 13100A OR TBM15I
	MAIN	TAP	A GROUND ROD	B CABLE RANGE	T	H	
54855	1/0 Str.–250 kcmil or ½"–¾" ROD	#4 Sol.–#2 Str.	#3 Rebar ¾ thru ½ #4 Rebar	#4 Sol.–#2 Str.	¾"	1 ½"	15G86R
54860	1/0 Str.–250 kcmil or ½"–¾" ROD	1/0 Str.–2/0 Str.	#3 Rebar ¾ thru ½ #4 Rebar	1/0 Str.–2/0 Str.	¾"	2 ½"	15G86R
54865-CK	1/0 Str.–250 kcmil or ½"–¾" ROD	3/0 Str.–250 kcmil	#3 Rebar ¾ thru ½ #4 Rebar	3/0 Str.–250 kcmil	¾"	2 ½"	15G86R
54875	#6 Sol.–#2 Str.	#6 Sol.–#2 Str.	—	—	¾"	2 ½"	15501A
54885	250 kcmil–500 kcmil or ¾"–¾" ROD	#4 Sol.–#2 Str.	#5 Rebar ¾ thru ¾ #6 Rebar	#4 Sol.–#2 Str.	¾"	1 ½"	15G126R
54890	250 kcmil–500 kcmil or ¾"–¾" ROD	1/0 Str.–2/0 Str.	#5 Rebar ¾ thru ¾ #6 Rebar	1/0 Str.–2/0 Str.	¾"	2 ½"	15G126R
54895	250 kcmil–500 kcmil or ¾"–¾" ROD	3/0 Str.–250 kcmil	#5 Rebar 5/8 thru ¾ #6 Rebar	3/0 Str.–250 kcmil	¾"	2 ½"	15G126R
54900	250 kcmil–500 kcmil or ¾"–¾" ROD	350 kcmil–500 kcmil	#5 REBAR ¾ thru ¾ #6 Rebar	350 kcmil–500 kcmil	1 ½"	2 ½"	15G121R

* Tin-plated version available of galvanized ground rods. Add suffix -TP

Figure 8 Compression Ground Rod Tap Connector

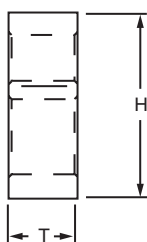
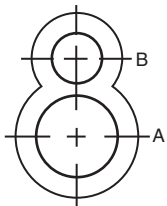

MEETS

IEEE

 837 REQUIREMENTS

CAT. NO.	A GROUND ROD	B CABLE RANGE	DIMENSIONS (IN.)		DIES FOR TBM14M 13100A OR TBM15I
			T	H	
GR12-202	½"	2 AWG–2/0 AWG	¾"	1 ½"	15G121R
GR58-202	⅝"	2 AWG–2/0 AWG	¾"	1 ½"	15G121R
GR34-202	¾"	2 AWG–2/0 AWG	¾"	2 ½"	15G121R
GR1-202	1"	2 AWG–2/0 AWG	¾"	2 ½"	15G121R
GR12-40250	½"	3/0 AWG–250 kcmil	¾"	1 ½"	15G121R
GR58-40250	⅝"	3/0 AWG–250 kcmil	¾"	2 ½"	15G121R
GR34-40250	¾"	3/0 AWG–250 kcmil	¾"	2 ½"	15G121R
GR1-40250	1"	3/0 AWG–250 kcmil	¾"	2 ½"	15G121R
GR58-300500	⅝"	300–500 kcmil	¾"	2 ½"	15G121R
GR34-300500	¾"	300–500 kcmil	¾"	2 ½"	15G121R
GR1-300500	1"	300–500 kcmil	¾"	2 ½"	15G121R

Tooling: p. B74–B90

Die Selector Chart: p. B92–B93