

# PARALLEL GROOVE CONNECTORS

## Blackburn® PAE Parallel Groove Clamps, Extruded Type

Galvanized steel hardware provides high-strength for heavy-duty applications.

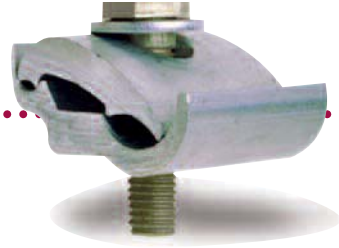

Features	Benefits/Descriptions
Install with Live Line Tools	Use the tools you already have.
Dual-Rated	Standard for aluminum-to-copper connections.
Prefilled with Oxide Inhibitor ("9" Suffix in Chart)	Prevents oxidation on copper-to-aluminum connections.

NOTE: For aluminum-hardware option, add "-7" suffix to the catalogue number.  
 For tin-plating option, add "-P" suffix to the catalogue number.  
 For wax-dip option that provides oxide protection for aluminum-to-aluminum connections, add "-6" suffix to the catalogue number.

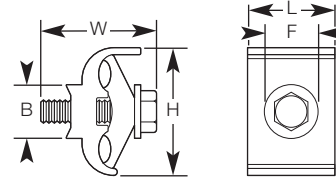

Fig. 1

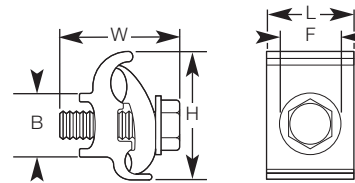

Fig. 2

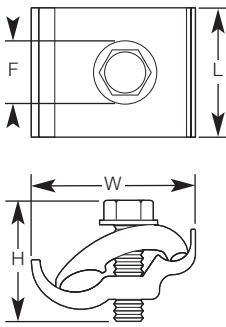

Fig. 3

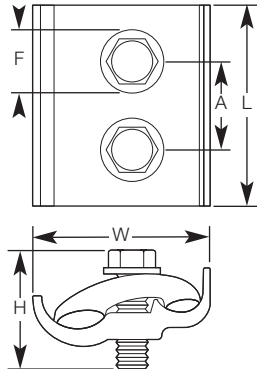

Fig. 4

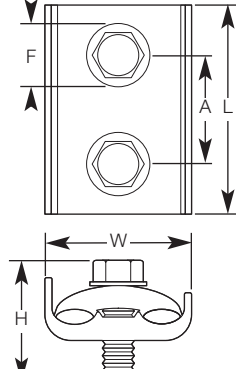

Fig. 5

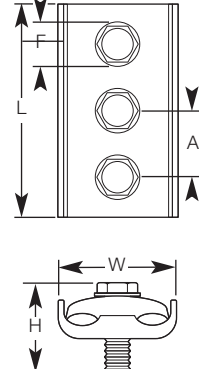

Fig. 6

### Blackburn® PAE Parallel Groove Clamps, Extruded Type

CAT. NO.	Conductor Range		Conductor Diameter (in.)				Dimensions (in.)						Galvanized Aluminum		
	Main	Tap	Main		Tap		Fig.	H	W	L	F	B	A	Steel Bolt Thd. Size	Bolt Thd. Size
			Max.	Min.	Max.	Min.									
PAE-335-79	1/0 str.-#6 sol.	1/0 str.-#6 sol.	0.398	0.162	0.398	0.162	1	1-9/16	1-1/2	1-1/4	9/16	-	-	3/8-16 UNC	3/8-16 UNC
PAE-2121-9*	2/0 ACSR-#6 sol., #6 AR	2/0 ACSR-#6 sol., #6 AR	0.447	0.162	0.447	0.162	1	2	1-5/8	1-3/8	9/16	7/8	-	3/8-16 UNC	3/8-16 UNC
PAE-2121X-79	2/0 ACSR-#6 sol., #6 AR	2/0 ACSR-#6 sol., #6 AR	0.447	0.162	0.447	0.162	1	2	1-5/8	1-3/8	9/16	7/8	-	-	3/8-16 UNC
PAE-4141-9*	4/0 ACSR-#2 sol., #4-#6 AR	4/0 ACSR-#2 sol., #4-#6 AR	0.563	0.258	0.563	0.258	1	2	2	1-3/8	9/16	7/8	-	3/8-16 UNC	3/8-16 UNC
PAE-3921-9-2	397.5 ACSR-3/0 str., 2/0-#6 AR	2/0 str.-#6 sol., #6 AR	0.743	0.464	0.414	0.162	2	2-9/16	2-1/4	1-5/8	3/4	1-1/8	-	1/2-13 UNC	1/2-13 UNC
PAE-9941-9	1000-397.5 ACSR, 336.4-2/0 AR	4/0 ACSR-#2 sol., #4-#6 AR	1.152	0.743	0.563	0.258	3	2-13/16	2-59/64	2-1/4	3/4	-	-	1/2-13 UNC	1/2-13 UNC
PAE-3931-9-2	397.5 ACSR-3/0 str., 2/0-#6 AR	3/0 ACSR-2 str., #6 AR	0.743	0.464	0.502	0.292	4	2-9/16	2-5/16	3-3/8	3/4	-	1-3/4	1/2-13 UNC	1/2-13 UNC
PAE-3939-9-2	397.5 ACSR-3/0 str., 2/0-#6 AR	397.5 ACSR-3/0 str., 2/0-#6 AR	0.743	0.464	0.743	0.464	5	2-9/16	2-9/16	3-3/8	3/4	-	1-7/8	1/2-13 UNC	5/8-11 UNC
PAE-9921-9	1000-397.5 ACSR, 336.4-2/0 AR	2/0 str.-#6 sol., #6 AR	1.152	0.743	0.414	0.162	3	2-13/16	2-3/16	2-1/4	3/4	-	-	1/2-13 UNC	5/8-11 UNC
PAE-9939-9	1000-397.5 ACSR, 336.4-2/0 AR	397.5 ACSR-3/0 str., 2/0-#6 AR	1.152	0.743	0.743	0.464	4	2-13/16	3-7/64	3-1/2	3/4	-	1-1/2	1/2-13 UNC	5/8-11 UNC
PAE-9999-9	1000-397.5 ACSR, 336.4-2/0 AR	1000-397.5 ACSR, 336.4-2/0 AR	1.152	0.743	1.152	0.743	6	2-13/16	3-1/2	6	3/4	-	2	1/2-13 UNC	5/8-11 UNC

\* RUS Listed.  
 AR = Over armor rod.