

of Contacts + Ground Connection

6	10	16
---	----	----

Single Lever		Double Lever		Housing	NPT Entry	Lever Locking Type					
Bases – Standard Mount						Single	Single	Double	Single	Double	
				Panel Base w/Cover		PB306 PB406*	PB310* PB410*	PB110E	PB316* PB416*	PB116E	BASE TO HOOD
				Box Base (no Cover)	1 X 1/2" 1 X 3/4" 1 X 1" 2 X 1/2" 2 X 3/4" 2 X 1"	BB406 BB406H075 BB406H100 BB506 BB506H075 BB506H100	BB410 BB410H075 BB410H100 BB510 BB510H075 BB510H100	BB010E BB010EH075 BB010EH100 BB110E BB110EH075 BB110EH100	BB416* BB416H100	BB016E* BB016EH100 BB116E* BB116EH100	
				Box Base w/Cover	1 X 1/2" 1 X 3/4" 1 X 1" 2 X 1/2" 2 X 3/4" 2 X 1"	BB606* BB606H075* BB606H100* BB706* BB706H075* BB706H100*	BB610* BB610H075* BB610H100* BB710* BB710H075* BB710H100*		BB616* BB616H100* BB716* BB716H100*		
Hoods – Standard Mount											HOODS TO COUPLER
				Side Entry	1 X 1/2" 1 X 3/4" 1 X 1"	SH606 SH606H075 SH606H100	SH610 SH610H075 SH610H100	SH010 SH010H075 SH010H100	SH616* SH716H	SH016* SH116H	
				Top Entry	1 X 1/2" 1 X 3/4" 1 X 1"	TH806 TH806H075 TH806H100	TH810 TH810H075 TH810H100	TH210 TH210H075 TH210H100	TH816* TH816H100	TH216* TH316H	
Coupler Hoods – Inline											
				Top Entry	1 X 1/2" 1 X 3/4" 1 X 1"	CH806 CH806H075 CH806H100	CH810 CH810H075 CH810H100	CH610E CH610EH075 CH610EH100	CH816H CH916H	CH616EH CH716EH	

For Inline, Portable or Special Service Connections

Coupler Hoods mate to Standard Hoods ONLY.

Reverse Locking

Lever Hoods mate to Post Bases ONLY.

Lever Hoods – Reversed Lock		Housing	NPT Entry	Lever Hoods		
				Side Entry w/Lever(s)	Top Entry w/Lever(s)	
		Side Entry w/Lever(s)	1 X 1/2" 1 X 3/4" 1 X 1"			
		Top Entry w/Lever(s)	1 X 1/2" 1 X 3/4" 1 X 1"			
Bases – with Access Cover		Housing	NPT Entry	Post Bases		
				Panel + Posts w/Cover	Box + Posts w/Cover	
		Panel + Posts w/Cover				
		Box + Posts w/Cover	1 X 1/2" 1 X 3/4" 1 X 1" 2 X 1/2" 2 X 3/4" 2 X 1"			

*Notes: Available in Standard or HIGH Profile "H" configurations. (-add suffix)
 * Add "M" final suffix for metal cover option.
 • Both HIGH (H) and LOW (L) profile also available. (-add suffix)

Customer Benefits



T Series



Pos-E-Kon™

Heavy Duty Multi-Circuit Rectangular Industrial Connectors

Quality Systems, Quality Parts

DIN EN ISO 9001 Systems.

Approvals:

DIN, IEC, VDE, UL, and CSA
for world use.

Space Saving

Maximum circuits in minimum
space – shaped to fit panels
and machines.

Quick & Easy Housing Connections

Unique roller locking double
lever handles.

Sealed Connections

Neoprene or HT-Viton housing
assembly seals to IP65 for
washdown duty.

Wiring In Any System

Standard NPT fittings provided,
with many other cable or
conduit entry options available.

Any Access Needed

Top, side and custom options,
including ribbon cable.

Rough Service, Tough Duty

Die cast housings with hard-
shell powder-coat finish.

Easy Circuit Location

Hot-stamped contact positions
and catalog numbers.

Performance Plus

Standard (125°C) and 200°C
interiors available.

Wiring Your Way

Standard Screw Terminal and
Crimp Terminal Inserts, with
Fiber Optic and other contacts
also available.

Pos-E-Kon Improvements for 2001

Introducing: New Ergonomic thermoplastic levers for “B” series double lever housings **B10-B24**

Benefits: Non-slip comfortable grip
Easier locking and unlocking

And: New Laser etched labeling for all metal housings and hot-stamped labeling on contact carrier inserts.

Benefits: Permanent marking with all data combined
External marking vs. internal label



New “E” type levers will be standard for double lever B10 through B24 size housings. All single lever housings are constructed with metallic levers.

Metallic levers will continue to be available for all double lever housings. (Minimum order requirements)

Reference: Catalog Number Conversion

- Add “E” suffix for Ergonomic style levers for all B10, 16 and 24 double-lever housings.

Example: **PB116** (Metal levers) becomes **PB116E** (Thermoplastic levers)

LH224 (Metal levers) becomes **LH224E** (Thermoplastic levers)

Catalog Numbers affected (New catalog number construction shown in catalog)











B10 Series	B16 Series		B24 Series	
PB110	PB116	LH016	PB124	CH624
BB010	BB016	LH016H	BB024	CH724
BB110	BB116	LH116H	BB124	LH124
BB610	BB616	LH216		LH224
BB710	BB716	LH216H		LH024
CH810	CH616			LH324

Note: Product improvements phased in during 2001 shipments

of Contacts + Ground Connection

6

12





Single Lever		Double Lever		Housing	NPT Entry	Lever Locking Type		
Bases – Standard Mount						Single	Double	Double
		Panel Base			PB316	PB116E	PB132	
		w/Cover			PB416			
		Box Base (no Cover)		1 X 3/4" 1 X 1" 2 X 3/4" 2 X 1"	BB416* BB416H100 BB516* BB516H100	BB016E* BB016EH100 BB116E* BB116EH100	BB032 BB132	
		Box Base w/Cover		1 X 3/4" 1 X 1" 2 X 3/4" 2 X 1"	BB616** BB616H100** BB716** BB716H100**			
Hoods – Standard Mount								
		Side Entry		1 X 3/4" 1 X 1" 1 X 1.25"	SH616◆ SH716	SH016◆ SH116H	SH032 SH132 SH132-125	
		Top Entry		1 X 3/4" 1 X 1" 1 X 1.25"	TH816◆ TH816H100	TH216◆ TH316H	TH232 TH332 TH332-125	
Coupler Hoods – Inline								
		Top Entry		1 X 3/4" 1 X 1"	CH816H CH916H	CH616EH CH716EH	CH632 CH732	

For Inline, Portable or Special Service Connections

Coupler Hoods mate to Standard Hoods ONLY.

Reverse Locking

Lever Hoods mate to Post Bases ONLY.

Lever Hoods – Rev. Lock				Post Bases accept Lever Hoods ONLY.		
	Side Entry w/Lever(s)		1 X 3/4" 1 X 1"	LH016E* LH116EH		
	Top Entry w/Lever(s)		1 X 3/4" 1 X 1"	LH216E* LH316EH		
Bases – with Access Cover						
	Panel + Posts w/Cover			PB216**		
	Box + Posts w/Cover		1 X 3/4" 1 X 1" 2 X 3/4" 2 X 1"	BB216** BB216H100** BB316** BB316H100**		

*Notes: Available in Standard or HIGH Profile "H" configurations. (-add suffix)

**Notes: Available in Standard or LOW Profile "L" configurations. (-add suffix)

▪ Add "M" final suffix for metal cover option.

• Both HIGH (H) and LOW (L) profile also available. (-add suffix)

of Contacts + Ground Connection

7 or 8	15	25	40
--------	----	----	----

Single Lever	Double Lever	Housing	NPT Entry	Lever Locking Type					BASE TO HOOD
				Single	Single	Single	Single	Double	
Bases – Standard Mount									
		Panel Base w/Cover		PB303A(P)▲ PB403A	PB310A PB410A	PB316A PB416A	PB316 PB416	PB116E	BASE TO HOOD
		Angled, (no Cover)		PB503A(P)▲		PB416A			
		Box Base (no Cover)	1 X 3/8" 1 X 1/2" 2 X 1/2" 1 X 3/4" 1 X 1" 2 X 3/4" 2 X 1"	BB403A(P)▲	BB410A BB510A	BB416A BB516A	BB416* BB416H100 BB516* BB516H100	BB016E* BB016EH100 BB116E* BB116EH100	
		Box Base w/Cover	1 X 1/2" 2 X 1/2" 1 X 3/4" 1 X 1" 2 X 3/4" 2 X 1"		BB610A BB710A	BB616A BB716A	BB616* BB616H100* BB716* BB716H100*		

Hoods – Standard Mount		Body – "A" 3-16 Series standard Hoods include Gaskets: Bases and Special Hoods do not.								HOOD TO COUPLER
		Side Entry	1 X 3/8" 1 X 1/2" 1 X 3/4" 1 X 1"	SH603A(P)▲	SH610A SH710A	SH616A SH716A	TH816RC, TH216RC (Ribbon Cable) SH616◆ SH716H		SH016◆ SH116H	
		Top Entry	1 X 3/8" 1 X 1/2" 1 X 3/4" 1 X 1"	TH803A(P)▲	TH810A TH910A	TH816A TH916A	TH816◆ TH816H100	TH216◆ TH316H		

For Inline, Portable or Special Service Connections
Coupler Hoods mate to Standard Hoods ONLY.

Coupler Hoods – Inline										COUPLER
		Top Entry	1 X 3/8" 1 X 1/2" 1 X 3/4" 1 X 1"	CH803A(P)▲	CH810A	CH816A	CH816RC, CH716ERC (Ribbon Cable) CH816H CH916H		CH616EH CH716EH	

Lever Hoods – Reversed Lock			
	Side Entry w/Lever(s)	1 X 1/2" 1 X 3/4"	
	Top Entry w/Lever(s)	1 X 1/2" 1 X 3/4"	

Reverse Locking
Lever Hoods mate to Post Bases ONLY.

LH016E* LH116EH	HOOD TO HOOD
LH216E* LH316EH	

Bases – with Access Cover			
	Panel + Posts w/Cover		
	Box + Posts w/Cover	1 X 3/4" 1 X 1" 2 X 3/4" 2 X 1"	

Post Bases accept Lever Hoods ONLY.

PB216*	BASE TO HOOD
BB216* BB216H100* BB316* BB316H100*	

*Notes: Available in Standard or HIGH Profile "H" configurations. (-add suffix)
 **Notes: Available in Standard or LOW Profile "L" configurations. (-add suffix)
 ▲ (P) indicates glass-filled thermoplastic construction.
 ■ Add "M" final suffix for metal cover option.
 • Both HIGH (H) and LOW (L) profile also available. (-add suffix)

of Contacts + Ground Connection

				24		42		72					
				Lever Locking Type									
Single Lever	Double Lever	Housing		NPT Entry		Single	Single	Double	Single	Double			
Bases – Standard Mount						PB306 [■]	PB310 [■]	PB110E	PB316	PB116E			
		Panel Base				PB406 [■]	PB410 [■]		PB416				
		w/Cover											
		Box Base (no Cover)		1 X 1/2" 1 X 3/4" 1 X 1" 2 X 1/2" 2 X 3/4" 2 X 1"		BB406 BB406H075 BB406H100 BB506 BB506H075 BB506H100	BB410 BB410H075 BB410H100 BB510 BB510H075 BB510H100	BB010E BB010EH075 BB010EH100 BB110E BB110EH075 BB110EH100	BB416* BB416H100	BB016E* BB016EH100			
		Box Base w/Cover		1 X 1/2" 1 X 3/4" 1 X 1" 2 X 1/2" 2 X 3/4" 2 X 1"		BB606 [■] BB606H075 [■] BB606H100 [■] BB706 [■] BB706H075 [■] BB706H100 [■]	BB610 [■] BB610H075 [■] BB610H100 [■] BB710 [■] BB710H075 [■] BB710H100 [■]		BB616* [■] BB616H100 [■]				
									BB616* [■] BB616H100 [■]				
									BB716* [■] BB716H100 [■]				
Hoods – Standard Mount						SH606 SH606H075 SH606H100	SH610 SH610H075 SH610H100	SH010 SH010H075 SH010H100	SH616 [◆] SH716H	SH016 [◆] SH116H			
		Side Entry		1 X 1/2" 1 X 3/4" 1 X 1"									
		Top Entry		1 X 1/2" 1 X 3/4" 1 X 1" Ribbon CBL		TH806 TH806H075 TH806H100	TH810 TH810H075 TH810H100	TH210 TH210H075 TH210H100	TH816 [◆] TH816H100 TH816RC‡	TH216 [◆] TH316H TH216RC‡			
Coupler Hoods – Inline						CH806 CH806H075 CH806H100	CH810 CH810H075 CH810H100	CH610E CH610EH075 CH610EH100	CH816H CH916H CH816RC‡	CH616EH CH716EH CH716ERC‡			
		Top Entry w/Lever(s)		1 X 1/2" 1 X 3/4" 1 X 1" Ribbon CBL									

For Inline, Portable or Special Service Connections
Coupler Hoods mate to Standard Hoods ONLY.

Lever Hoods – Reversed Lock					
		Side Entry w/Lever(s)		1 X 1/2" 1 X 3/4" 1 X 1"	
		Top Entry w/Lever(s)		1 X 1/2" 1 X 3/4" 1 X 1"	

Reverse Locking
Lever Hoods mate to Post Bases ONLY.

LH010E LH010EH075 LH010EH100	LH016E* LH116EH
LH210E LH210EH075 LH210EH100	LH216E* LH316EH

Bases – with Access Cover			
		Panel + Posts w/Cover	
		Box + Posts w/Cover	
		1 X 1/2" 1 X 3/4" 1 X 1" 2 X 1/2" 2 X 3/4" 2 X 1"	

Post Bases accept Lever Hoods ONLY.

PB210 [■]	PB216 [■]
BB210 [■] BB210H075 [■] BB210H100 [■] BB310 [■] BB310H075 [■] BB310H100 [■]	BB216* [■] BB216H100 [■] BB316* [■] BB316H100 [■]

* Notes: Available in Standard or HIGH Profile "H" configurations. (-add suffix)
 ■ Add "M" final suffix for metal cover option.
 ◆ Both HIGH (H) and LOW (L) profile also available. (-add suffix)
 ‡ See page 173 for ribbon cable kits.

Insert Holders + Housings

of Inserts

5

Select 5 Insert Male & Female Carrier Frames for B16 Housings; for any M-Insert.

Male + Female Carrier Frame for Inserts



5 Insert Holder Female Frame **F5F016M**

Note: AF10F216M Optional Frame available (+5 insert) Positions V-Z for B32 Housings.

Single Lever		Double Lever		Housing	NPT Entry	Lever Locking Type	
Bases – Standard Mount						Single	Double
				Panel Base		PB316	PB116E
				w/Cover		PB416	
				Box Base w/Lever (no Cover)	1 X 3/4" 1 X 1" 2 X 3/4" 2 X 1"	BB416* BB416H100 BB516* BB516H100	BB016E* BB016EH100 BB116E* BB116EH100
				Box Base w/Cover & Lever	1 X 3/4" 1 X 1" 2 X 3/4" 2 X 1"	BB616*■ BB616H100■ BB716*■ BB716H100■	

BASE TO HOOD

Single Lever		Double Lever		Housing	NPT Entry	Coupler
Hoods – Standard Mount						
				Side Entry w/Posts	1 X 3/4" 1 X 1"	SH616* SH716
				Top Entry w/Posts	1 X 3/4" 1 X 1"	TH816* TH816H100

HOODS TO COUPLER

For Inline, Portable or Special Service Connections

Coupler Hoods mate to Standard Hoods ABOVE.

Single Lever		Double Lever		Housing	NPT Entry	Coupler
Coupler Hoods – Inline						
				Top Entry w/Lever(s)	1 X 3/4" 1 X 1"	CH816H CH916H
				Top Entry w/Lever(s)	1 X 3/4" 1 X 1"	CH616EH CH716EH

COUPLER

Reverse Locking

Lever Hoods mate to Post Bases ONLY.

Single Lever		Double Lever		Housing	NPT Entry	Coupler
Lever Hoods – Reversed Lock						
				Side Entry w/Lever(s)	1 X 3/4" 1 X 1"	LH016E LH116EH
				Top Entry w/Lever(s)	1 X 3/4" 1 X 1"	LH216E LH316EH

HOODS TO HOOD

Bases – with Access Cover

Post Bases accept Lever Hoods ONLY.

Single Lever		Double Lever		Housing	NPT Entry	Coupler
Bases – with Access Cover						
				Panel Base w/Cover		PB216■
				Box + Posts w/Cover	1 X 3/4" 1 X 1" 2 X 1/2" 2 X 3/4" 2 X 1"	BB216*■ BB216H100■ BB316*■ BB316H100■

BASE TO BASE

*Notes: Available in Standard or HIGH Profile "H" configurations. (-add suffix)

■ Add "M" suffix for metal cover option.

Mounting Dimensions for Double Lever Box Bases

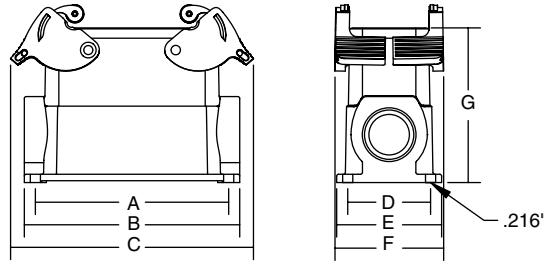

HOUSING SERIES					CAT. NO.	DIMENSIONS ARE IN INCHES / (MILLIMETERS)						
A, B, T, K	C, V	D	DD	M		A	B	C	D	E	F	G
A32	D50				BB_32A	3.70 / (94)	4.17 / (106)	5.04 / (128)	1.81 / (46)	2.20 / (56)	2.76 / (70)	3.40 / (86.5)
B10, T10	V3		DD42	M3	BB_10E	3.23 / (82)	3.66 / (93)	4.33 / (110)	1.57 / (40)	2.05 / (52)	2.28 / (58)	2.05 / (52)
					BB_10EH	3.23 / (82)	3.66 / (93)	4.33 / (110)	1.77 / (45)	2.24 / (57)	2.28 / (58)	2.92 / (74)
B16, T16	C6, V6	D40	DD72	M5	BB_16E	4.13 / (105)	4.61 / (117)	5.16 / (131)	1.77 / (45)	2.24 / (57)	2.28 / (58)	2.68 / (68)
					BB_16EH	4.13 / (105)	4.61 / (117)	5.16 / (131)	1.77 / (45)	2.24 / (57)	2.28 / (58)	3.31 / (84)
B24, T24, K12	V10, V16	D64	DD108	M7	BB_24E	5.20 / (132)	5.67 / (144)	6.18 / (157)	1.77 / (45)	2.24 / (57)	2.28 / (58)	2.68 / (68)
					BB_24EH	5.20 / (132)	5.67 / (144)	6.18 / (157)	1.77 / (45)	2.24 / (57)	2.28 / (58)	3.31 / (84)
B32	C12	D80	DD144		BB_32E	4.41 / (112)	4.88 / (124)	5.28 / (134)	2.64 / (67)	3.20 / (81.5)	3.62 / (92)	2.83 / (72)

H - HIGH PROFILE

Mounting Dimensions for Single Lever Box Bases

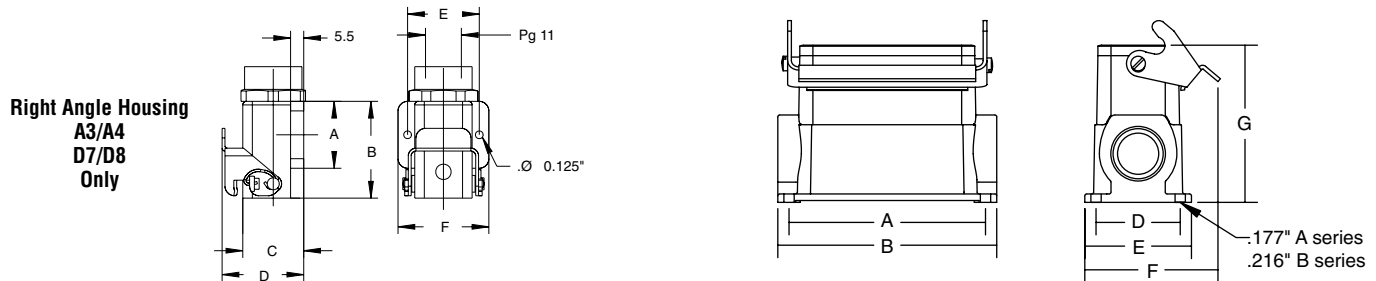

Right Angle Housing
A3/A4
D7/D8
Only

HOUSING SERIES					CAT. NO.	DIMENSIONS ARE IN INCHES / (MILLIMETERS)						
A, B, T, K	C, V	D	DD	M		A	B	C	D	E	F	G
A3, A4		D7, D8			BB403A(P) ▶	1.10 / (28)	1.59 / (40.5)	1.00 / (25.5)	1.42 / (36)	1.18 / (30)	1.50 / (38)	
A10		D15			BB_10A	1.89 / (48)	–	3.66 / (93)	1.57 / (40)	1.97 / (50)	2.32 / (59)	2.05 / (52)
A16		D25			BB_16A	2.52 / (64)	–	4.29 / (109)	1.57 / (40)	1.97 / (50)	2.32 / (59)	2.24 / (57)
B6, T6			DD24	M2	BB_06	2.76 / (70)	3.31 / (84)	–	1.57 / (40)	2.05 / (52)	2.72 / (69)	2.05 / (52)
					BB_06H075	2.76 / (70)	3.31 / (84)	–	1.77 / (45)	2.24 / (57)	2.72 / (69)	2.92 / (74)
					BB_06H100	2.76 / (70)	3.31 / (84)	–	1.77 / (45)	2.24 / (57)	2.72 / (69)	2.92 / (74)
B10, T10	V3		DD42	M3	BB_10	3.23 / (82)	3.66 / (93)	–	1.57 / (40)	2.05 / (52)	2.80 / (71)	2.05 / (52)
					BB_10H075	3.23 / (82)	3.66 / (93)	–	1.77 / (45)	2.24 / (57)	2.80 / (71)	2.92 / (74)
					BB_10H100	3.23 / (82)	3.66 / (93)	–	1.77 / (45)	2.24 / (57)	2.80 / (71)	2.92 / (74)
B16, T16	C6, V6	D40	DD72	M5	BB_16	4.13 / (105)	4.61 / (117)	–	1.77 / (45)	2.24 / (57)	2.91 / (74)	2.68 / (68)
					BB_16H	4.13 / (105)	4.61 / (117)	–	1.77 / (45)	2.24 / (57)	2.91 / (74)	3.31 / (84)
B24, T24, K12	V10, V16	D64	DD108	M7	BB_24	5.20 / (132)	5.67 / (144)	–	1.77 / (45)	2.24 / (57)	2.91 / (74)	2.68 / (68)
					BB_24H	5.20 / (132)	5.67 / (144)	–	1.77 / (45)	2.24 / (57)	2.91 / (74)	3.31 / (84)
B48, K24 V32	V20, V26	D128	DD216		BB_48	4.37 / (111)	5.71 / (145)	–	4.17 / (106)	4.72 / (120)	6.18 / (157)	3.94 / (100)

▶ SUFFIX: A - ALUMINUM, AP - PLASTIC, H - HIGH PROFILE