

Parallel Groove Connectors

PAA One- and Two-Bolt Aluminum Parallel Groove Clamps

High-strength, heat-treated cast aluminum alloy provides secure connections

- All hardware items come standard
- Use on aluminum, ACSR and copper conductors
- Prevents oxidation on copper-to-aluminum connections

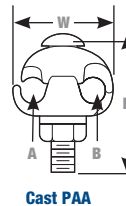

Cast PAA

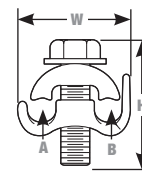
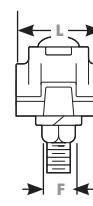

PAA339

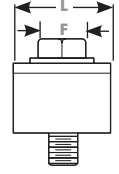

Standard Cat. No.	Prefilled Cat. No.	Conductor Range				Conductor Diameter				Dimensions (in.)				Bolt Size
		A Main		B Tap		Main		Tap		F	L	H	W	
		ACSR	Al/Cu	ACSR	Al/Cu	Max.	Min.	Max.	Min.					
-	PAA29	#2-#6	#2 str.-#6 sol.	#2-#6	#2 str.-#6 sol.	0.316	0.162	0.316	0.162	9/16	1-13/16	11-3/32	1-3/8	5/16
	PAA339	1/0-#6	1/0 str.-#6 sol.	1/0-#6	1/0 str.-#6 sol.	0.398		0.398			0.414	1-9/16	1-1/4	
PAA4	PAA49	1/0-#8	1/0 str.-#8 sol.	1/0-#8	1/0 str.-#8 sol.		0.414		0.414			0.414	2-7/32	
PAA5	PAA59		2/0 str.-#8 sol.		2/0 str.-#8 sol.	0.741		0.368			0.398		0.258	2-15/32
PAA6	PAA69	336.4-1/0, 1/0-#6 AR	400-1/0 str., 1/0-#6 AR	4/0-#2	4/0 str.-#2 sol.		0.563		0.258			0.563		0.258
PAA10*	PAA109	4/0-#2	4/0 str.-#2 sol.	4/0-#2	4/0 str.-#2 sol.	0.741		0.368			0.741		0.368	
PAA12	PAA129	336.4-1/0, 1/0-#6 AR	400-1/0 str., 1/0-#6 AR	336.4-1/0	400-1/0 str.									
PAA400†	PAA4009†													

* RUS Listed.
 † PAA400 and PAA4009 are two-bolt clamps.
 AR = Over armor rod.
 NOTE: For hex-head bolt option, add "-3" suffix to the catalogue number.

PAC Aluminum Parallel Groove Clamps with Copper Liner

Our most corrosion-resistant groove clamp ever!

- Effectively seals out moisture and resists corrosion
- Reduces the possibility of galvanic corrosion

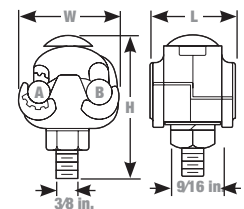

Standard Cat. No.	Prefilled Cat. No.	Conductor Range		B Tap Copper	Conductor Diameter		Dimensions (in.)		
		A Main	Al		Main	Tap	H	W	L
		ACSR	Al						
PAC345	PAC3459	1/0-#8	1/0 str.-#8 sol.	1/0 str.-#8 sol.	0.398-0.128	0.373-0.128	2-7/32	1-17/32	1-1/4
PAC7*	PAC79	336.4-1/0, 1/0-#6 AR	400-2/0 str., 1/0-#6 AR		0.741-0.398		2-15/32	1-5/8	1-7/8

* RUS Listed.
 NOTE: For hex-head bolt option, add "-3" suffix to the catalogue number.

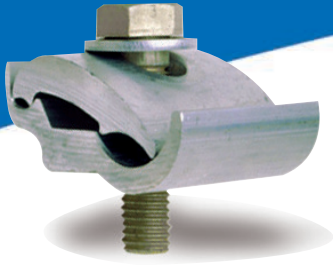

Parallel Groove Connectors

PAE Parallel Groove Clamps, Extruded Type

Galvanized steel hardware provides high-strength for heavy-duty applications

- Use the tools you already have
- Standard for aluminum-to-copper connections
- Prevents oxidation on copper-to-aluminum connections

NOTE: For aluminum-hardware option, add "-7" suffix to the catalogue number.
 For tin-plating option, add "-P" suffix to the catalogue number.
 For wax-dip option that provides oxide protection for aluminum-to-aluminum connections, add "-6" suffix to the catalogue number.

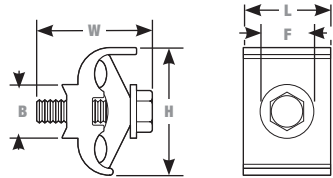

Fig. 1

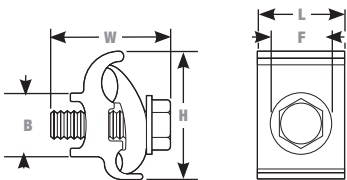

Fig. 2

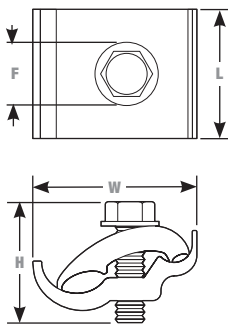

Fig. 3

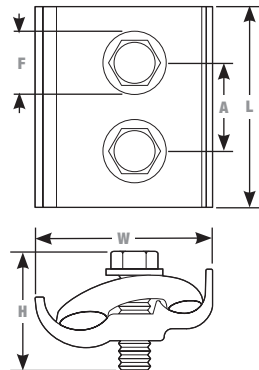

Fig. 4

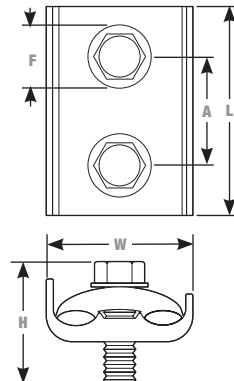

Fig. 5

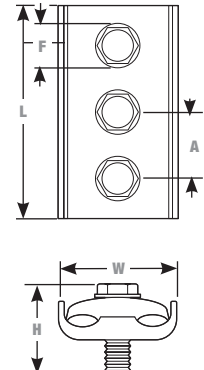

Fig. 6

Cat. No.	Conductor Range		Conductor Diameter (in.)				Dimensions (in.)							Galvanized Aluminum	
	Main	Tap	Main		Tap		Fig.	H	W	L	F	B	A	Steel Bolt Thd. Size	Bolt Thd. Size
			Max.	Min.	Max.	Min.									
PAE-335-79	1/0 str.-#6 sol.	1/0 str.-#6 sol.	0.398		0.398	0.162	1	1-9/16	1-1/2	1-1/4		-		3/8-16 UNC	
PAE-2121-9*	2/0 ACSR-#6 sol., #6 AR	2/0 ACSR-#6 sol., #6 AR	0.447	0.162	0.447	0.162	1	2	1-5/8	1-3/8	9/16	7/8	-	-	3/8-16 UNC
PAE-2121X-79															
PAE-4141-9*	4/0 ACSR-#2 sol., #4-#6 AR	4/0 ACSR-#2 sol., #4-#6 AR	0.563	0.258	0.563	0.258			2						3/8-16 UNC
PAE-3921-9-2	397.5 ACSR-3/0 str., 2/0-#6 AR	2/0 str.-#6 sol., #6 AR	0.743	0.464	0.414	0.162	2	2-9/16	2-1/4	1-5/8		1-1/8			
PAE-9941-9	1000-397.5 ACSR, 336.4-2/0 AR	4/0 ACSR-#2 sol., #4-#6 AR	1.152	0.743	0.563	0.258	3	2-13/16	2-59/64	2-1/4					1/2-13 UNC
PAE-3931-9-2	397.5 ACSR-3/0 str., 2/0-#6 AR	3/0 ACSR-2 str., #6 AR	0.743	0.464	0.502	0.292	4	2-9/16	2-5/16	3-3/8	3/4	-	-	1-3/4	1/2-13 UNC
PAE-3939-9-2		397.5 ACSR-3/0 str., 2/0-#6 AR			0.743	0.464	5		2-9/16					1-7/8	
PAE-9921-9		2/0 str.-#6 sol., #6 AR			0.414	0.162	3		2-3/16					2-1/4	
PAE-9939-9	1000-397.5 ACSR, 336.4-2/0 AR	397.5 ACSR-3/0 str., 2/0-#6 AR	1.152	0.743	0.743	0.464	4	2-13/16	3-7/64	3-1/2			1-1/2	5/8-11 UNC	
PAE-9999-9		1000-397.5 ACSR, 336.4-2/0 AR			1.152	0.743	6	3-1/2	6				2		

* RUS Listed.
 AR = Over armor rod.

Parallel Groove Connectors

K Series Jumper Clamps

These jumper clamps are sized right for #8 solid copper to 1/0 ACSR or 2/0 copper

- Provides high strength and durability
- Ensures a super-secure fitting
- No need to remove the bolt for installation
- Choose the model that works best with your wiring



Cat. No.	Plated Groove		Copper Groove	
	Max.	Min.	Max.	Min.
K1	1/0 ACSR, #2 SCG amerductor, 7/16 galv. Steel strand	#6 ACSR, #12 SCG amerductor, #8 solid iron	2/0 str. copper, 7/16 Copperweld*, 2A Copperweld*	#8 solid copper, #9-12D Copperweld*

*Trademark of Copperweld.

NOTE: Plated with plating removed from one groove. For use with aluminum, amerductor or galvanized steel strand to copper or copper-bonded steel wires.

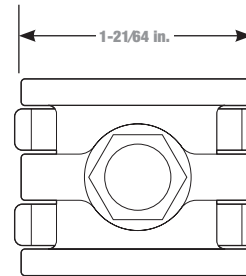

Cat. No.	Both Grooves Plated	
	Max.	Min.
K2	1/0 ACSR, #2 SCG amerductor, 7/16 galvanized steel strand	#6 ACSR, #12 SCG amerductor, #8 solid iron

NOTE: Clamp is plated. For use with amerductor, aluminum or galvanized steel stranding.

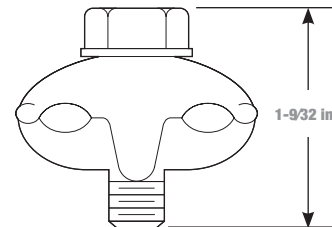

Cat. No.	Both Grooves Unplated	
	Max.	Min.
K3	— 2/0 str. copper, 7/16 Copperweld*, 2A Copperweld*	#8 solid copper, 9-1/2D Copperweld*

*Trademark of Copperweld.

NOTE: Clamp is not plated. For copper-to-copper connections.