

# DLED6R12Y RCL

LED retrofit downlights are perfect for updating existing recessed lighting without changing the fixture. Equivalent to 90W Par.

Color: White

Weight: 1.4 lbs

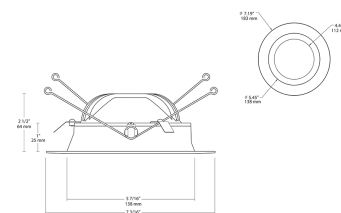

## LED Info

Watts: 12W  
 Color Temp: 3000K (Warm)  
 Color Accuracy: 86  
 L70 Lifespan: 100000  
 LM79 Lumens: 764  
 Efficacy: 58 LPW

## Driver Info

Type: Constant Current  
 120V: 0.11A  
 208V: N/A  
 240V: N/A  
 277V: N/A  
 Input Watts: 13W  
 Efficiency: 91%

## Technical Specifications

### cUL Listed:

Suitable for damp locations.

**Low-profile design for maximum compatibility with 6" incandescent recessed downlight housings.**

### Lifespan:

100,000-hour LED lifespan based on IES LM-80 results and TM-21 calculations.

### LEDs:

High-output, long-life LEDs with 3 step binning and integrated driver technology.

### Driver:

Innovative integrated driver technology with 120V TRIAC and ELV dimming.

### Spacing Criteria:

0-180° (along): 1.13.

### Lens:

Polycarbonate diffusion lens for smooth light output.

### Surge Protection:

2.5KV

### Ambient Temperature:

Suitable for use in 40°C ambient temperatures.

### Cold Weather Starting:

The minimum starting temperature is -22°F/-30°C.

### Color Consistency:

3-step MacAdam Ellipse binning to achieve consistent fixture-to-fixture color.

### Housing:

Professional-grade, die-cast aluminum construction.

### Adapters:

Edison E26 medium base adapter included. GU24 socket adapter sold separately.

### Installation:

Pre-installed Torsion springs and optional friction clips are both included to aid in attaching and securing the 6 DLED to the incandescent housing.

### Correlated Color Temp. (Nominal CCT):

3000K Warm.

### Equivalency:

12W replaces 90W Par.

### Finish:

Our environmentally friendly polyester powder coatings are formulated for high-durability and long-lasting color, and contains no VOC or toxic heavy metals.

### IESNA LM-79 & LM-80 Testing

### California Title 24:

DLED6R12 complies with 2013 California Title 24 building and electrical codes as a commercial indoor fixture for general spaces when used with a vacancy sensor and TRIAC dimming control. Select a vacancy sensor using catalog number LVS800. TRIAC dimmer provided by others.

### Green Technology:

Mercury and UV free, and RoHS compliant.



**Warranty:**

RC warrants that our LED products will be free from defects in materials and workmanship for a period of five (5) years from the date of delivery to the end user, including coverage of light output, color stability, driver performance and fixture finish.

