

### Intermediate Vertical-Lok Spacers

Dimension n (in)	Part Number	Product Code	A inches	B inches	C inches
2 x 1-1/2	IS3530	029550	1.500	3.937	0.62
2 x 2	IS3535	029551	2.000	4.483	0.62
2 x 3	IS3545	029552	3.000	5.438	0.62
3 x 1-1/2	IS4530	029553	1.500	5.130	no rebar slots
3 x 2	IS4535	029554	2.000	5.625	0.87
3 x 3	IS4545	029555	-	6.614	0.87
4 x 1	IS5520	029556	1.000	5.630	no rebar slots
4 x 1-1/2	IS5530	029557	-	6.614	0.87
4 x 2	IS5535	029558	2.000	6.625	0.87
4 x 3	IS5545	029559	3.000	7.625	0.87
5 x 1-1/2	IS6030	029560	1.500	7.325	no rebar slots
5 x 2	IS6035	029561	2.188	7.813	0.87
5 x 3	IS6045	029562	3.188	8.875	0.87
6 x 1-1/2	IS6530	029563	-	7.441	0.87
6 x 2	IS6535	029564	-	7.677	0.87
6 x 3	IS6545	029565	3.000	9.750	0.87
8 x 2	IS8035	029294	-	-	no rebar slots

### Intermediate Vertical-Lok Spacers (Duct Pipe Only)

Dimension (in)	Part Number	Product Code
* 4 x 1-1/2	IS5530D	029340
* 4 x 2	IS5535D	029341

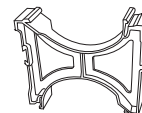

\* Not supplied with rebar holder slots.

### Base Vertical-Lok Spacers

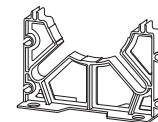

Dimension n (in)	Part Number	Product Code	A inches	B inches	C inches
2 x 1-1/2	BS3530	029566	2.992	3.937	0.62
2 x 2	BS3535	029567	2.992	4.488	0.62
2 x 3	BS3545	029568	2.992	5.433	0.62
3 x 1-1/2	BS4530	029569	3.000	4.615	no rebar slots
3 x 2	BS4535	029570	2.992	5.630	0.87
3 x 3	BS4545	029571	2.992	6.614	0.87
4 x 1	BS5520	029572	1.750	4.060	no rebar slots
4 x 1-1/2	BS5530	029573	2.992	6.614	0.87
4 x 2	BS5535	029574	2.992	6.614	0.87
4 x 3	BS5545	029575	2.992	7.638	0.87
5 x 1-1/2	BS6030	029576	3.000	6.900	no rebar slots
5 x 2	BS6035	029577	2.992	7.874	0.87
5 x 3	BS6045	029578	2.992	8.701	0.87
6 x 1-1/2	BS6530	029579	3.031	7.441	0.87
6 x 2	BS6535	029580	3.031	7.677	0.87
6 x 3	BS6545	029581	2.992	9.764	0.87
8 x 2	BS8035	029293	-	-	no rebar slots

### Base Vertical-Lok Spacers (Duct Pipe Only)

Dimension (in)	Part Number	Product Code
* 4 x 1-1/2	BS5530D	029440
* 4 x 2	BS5535D	029441

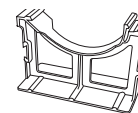

\* Not supplied with rebar holder slots.

