

PRODUCT INFORMATION

Intended Use

Recessed incandescent housings for 2x6 new construction (L7X) or remodel construction (L7XR). Approved for direct burial in insulation and all ceiling and wiring types.

Construction

L7XP: Air-tight, galvanized steel pan with aluminum can and junction box with four built-in ROMEX® clamps and ground wire. Rated for 90°C. Factory-installed captive

bar hangers that span up to 24 o.c. and feature stepped shank nail with integral T-bar locks. Two locking screws hold fixture position. Socket clips to trim to ensure proper and consistent lamp position.

L7XPR: Air-tight aluminum housing with heavy-gauge galvanized steel raceway arm. Remodel clips for installation in existing plaster, sheet rock or mechanical ceilings. Galvanized steel junction box

with three built-in ROMEX® clamps and ground wire. Not suitable for pulling wires. Rated for 90°C. Socket clips to trim to ensure proper and consistent lamp position.

Trim retention (clips): Retaining clips riveted to top of reflector hold trim inside housing.

Trim retention (TOR): Two side-mounted torsion springs on the trim and two receiving brackets in the can, ensure

a consistently tight fit with the ceiling.

Suitable for ceilings up to 1-1/2" thick.

Listings

UL Listed to U.S. and Canadian safety standards.

L7XP L7XPR



ORDERING INFORMATION

For shortest lead times, configure products using **bolded options**.

Example: L7XP 701 TOR

Series	Reflector	Options
L7XP L7XPR Housings sold in resale packs of six (R6).	Choose reflector below. Torsion springs will be designated with a TOR in the nomenclature. Riveted clips will have no designation. Housing and reflector may be ordered separately. ³	PHC Poke-home wire connectors

IC Rated Full Reflectors: All reflectors are damp location listed. Lensed reflectors are wet location listed. These IC reflectors also can be used in Non-IC applications when using the lamps and wattages listed below. White flange standard.

Open wide flange	Baffle narrow flange	Baffle wide flange	Eyelid wallwash	Eyeball
701 TOR White IC 65 BR30 75 PAR30	7B0W White IC 65 BR30 75 PAR30	7B1 Black 7B1W TOR White IC 65 BR30 75 PAR30	7W1 White IC 40 A19	7E1 TOR White 7E1BN TOR Brushed nickel ² 7E1ORB TOR Oil-rubbed bronze ² 7E1BZA TOR Antique bronze ² IC 65 BR30 75 PAAR30
Regressed eyeball	Polycarbonate lens	Polycarbonate lens		
7RE1 White IC 65 BR30 75 PAR30	7LD1 Drop opal ¹ IC 40 A19	7LD2 Drop prismatic ¹ IC 40 A19		

ADDITIONAL INFORMATION

For additional product information, visit www.lithonia.com.

ACCESSORIES

ORDER SEPARATELY

- CTR6 6" goof ring, white
- ATK6 R6 6" air-tight trim kit

Drawings are for dimensional detail only and may not represent actual mechanical configuration. Dimensions are shown in inches (centimeters) unless otherwise noted.

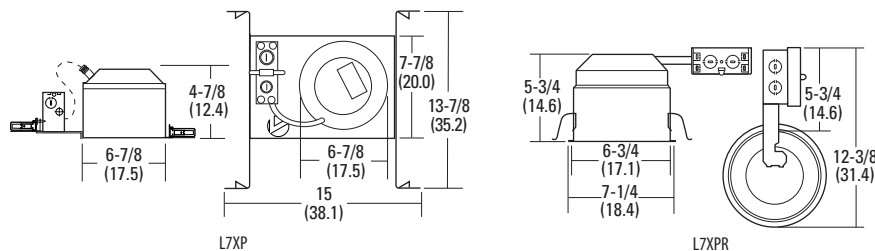

Notes

- For plastic flange, add suffix PF to catalog number (Example: 7LD1 PF).
- Flange matches trim finish.
- C series trims also compatible trim options.

Please consult www.lithonia.com for a full listing of Contractor Select products.