

# Switches TradeMaster® Decorator Combination Switches

15A, 120VAC

Pass & Seymour



## Features

- Impact-resistant face and body.
- Fully rounded back body protects wires from being damaged by sharp edges.
- Clear identification of circuits.
- External screw-pressure-plate back and side wired. Accepts #12 and #14 AWG.
- Ground screw position under the end of the strap minimizes the risk of contact.
- Full wraparound metal strap with lock-in tabs.
- Patented split circuit tab – easily accessible, and can be reinstalled without a tool.
- Unique “Up/Down” switches match the look and feel of standard Decorator switches.
- Largest breadth of 15 amp offering.
- All screws are tri-drive.
- Tamper-resistant version features dual mechanical shutter system to help prevent insertion of foreign objects (see Page A-22).

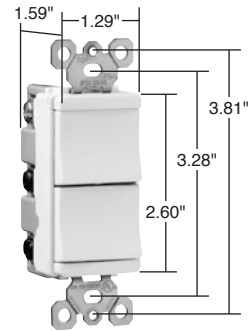

TM811WCC

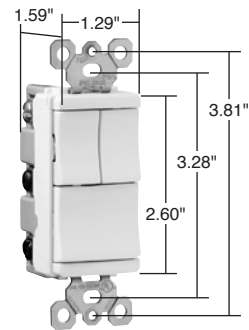

TM8111WCC

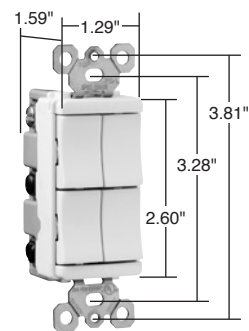

TM81111WCC

All devices listed on this page conform to NEMA WD-1 and WD-6.

Catalog Number	Rating A. VAC	Color	3rd Party Compliance	
			UL <sup>®</sup> UL20	UL <sup>®</sup> cULus
<b>Two Single Pole Switches</b>				
TM811ICC	15 120	Ivory	•	•
TM811WCC	15 120	White	•	•
TM811CC	15 120	Brown	•	•
TM811BKCC	15 120	Black	•	•
TM811LACC	15 120	Light Almond	•	•
<b>Two Single Pole Switches with Pilot Light</b>				
TM811PLICC	15 120	Ivory	•	•
TM811PLWCC	15 120	White	•	•
TM811PLBKCC	15 120	Black	•	•
TM811PLLACC	15 120	Light Almond	•	•
<b>Single Pole Switch &amp; Three-Way Switch</b>				
TM813ICC	15 120	Ivory	•	•
TM813WCC	15 120	White	•	•
TM813CC	15 120	Brown	•	•
TM813BKCC	15 120	Black	•	•
TM813LACC	15 120	Light Almond	•	•
<b>Single Pole Switch with Pilot Light &amp; Three-Way Switch</b>				
TM813PLICC	15 120	Ivory	•	•
TM813PLWCC	15 120	White	•	•
TM813PLBKCC	15 120	Black	•	•
TM813PLLACC	15 120	Light Almond	•	•
<b>Two Three-Way Switches</b>				
TM833ICC	15 120	Ivory	•	•
TM833WCC	15 120	White	•	•
TM833CC	15 120	Brown	•	•
TM833BKCC	15 120	Black	•	•
TM833LACC	15 120	Light Almond	•	•
<b>Three Single Pole Switches</b>				
TM8111ICC	15 120	Ivory	•	•
TM8111WCC	15 120	White	•	•
TM8111CC	15 120	Brown	•	•
TM8111BKCC	15 120	Black	•	•
TM8111LACC	15 120	Light Almond	•	•
<b>Two Single Pole Switches &amp; Three-Way Switch</b>				
TM8113ICC	15 120	Ivory	•	•
TM8113WCC	15 120	White	•	•
TM8113CC	15 120	Brown	•	•
TM8113BKCC	15 120	Black	•	•
TM8113LACC	15 120	Light Almond	•	•
<b>Four Single Pole Switches</b>				
TM81111ICC	15 120	Ivory	•	•
TM81111WCC	15 120	White	•	•
TM81111CC	15 120	Brown	•	•
TM81111BKCC	15 120	Black	•	•
TM81111LACC	15 120	Light Almond	•	•

Pass &amp; Seymour



## Switches

# TradeMaster® Decorator Combination Switches

**Unique “Up/Down” switches** match the look and feel of standard Decorator switches.

**Easy-to-use oversized main switch** for primary load.

**Patented Snap-In Light Module** (sold separately) transforms a combination switch into an illuminated switch in seconds.

**Identification modules** (sold separately) identifies each switch — light, fan, heat lamp.

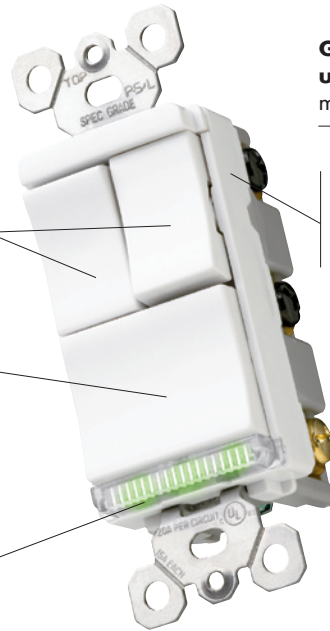

**TM8113WCC**  
Shown with Snap-In Light Module TM8LMCC.

**Fully rounded back body** protects wires from being damaged by sharp edges.

**Ground screw position under the end of the strap** minimizes the risk of contact.

**Impact-resistant face and body.**

**Full wraparound metal strap**, commercial grade with lock-in tabs.



**All screws are tri-drive.**

**Patented split circuit tab** – easily accessible, and can be reinstalled without a tool.

**External screw-pressure-plate back and side wired.** Accepts #12 and #14 AWG.

### Adding a Snap-In Light Module

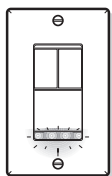
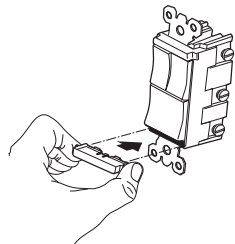
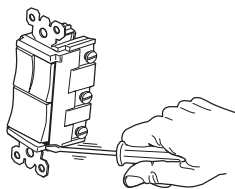

### Features

- Module simply snaps-in for easy installation.
- Can be installed with the following devices: TM811, TM813, TM833, TM818, TM838, TM8111, TM8113, TM81111, TM8118 and the LS Series of Dimmers & Fan Speed Controls (see Pages N-15 through N-17).

### Snap-In Light Module:

- Lights when OFF.
- Uses energy-efficient 1/4 watt LED light.
- LED light will not generate heat and will last on average 47 years.



TM8LMCC



TM81DWCC

Catalog Number	Rating A. VAC	Color	3rd Party Compliance
			cULus cULus
<b>Snap-In Light Module</b>			
TM8LMCC	15 120/125	Clear	•
<b>Identification Modules</b>			
TM8IDICC	— —	Ivory	
TM8IDWCC	— —	White	
TM8IDCC	— —	Brown	
TM8IDBKCC	— —	Black	
TM8IDLACC	— —	Light Almond	

For Decorator Hallway Lights and Combination Devices, see Pages E-17, E-18, E-21, E-30, E-36, and E-72.

All devices listed on this page conform to NEMA WD-1 and WD-6.