



TRAC 12

Miniature Low Voltage Trac System

MR11 SPOTLIGHTS

TL110 and TL112

Project: _____

Fixture Type: _____

Location: _____

Contact/Phone: _____

PRODUCT DESCRIPTION

A selection of distinctive miniature MR11 halogen lampholders provides high intensity display and accent lighting using small scale, high-styled trac lights.

Transformer Refer to specification sheets [D3.1.2](#) and [D3.1.3](#).

Trac Refer to specification sheets [D3.1.0](#) and [D3.1.1](#).

Socket Ceramic bi-pin.

Lens Glass lens included with each lampholder.

Labels UL listed, CSA certified.

Product specifications subject to change without notice.



Low Voltage MR11/Gimbal Ring

Aiming 90° vertical aiming capability and 358° rotation

- One locking knob provided.

Catalog Number	Description	Finish	Lamp
TL110WH	Gimbal Ring	White	35W MR11, 12V or 24V
TL110BL	Gimbal Ring	Black	35W MR11, 12V or 24V

ACCESSORIES

Cat. No.	Description
T5558BL	Hexcell Louver

See specification sheet [D1.2.2](#) for details.

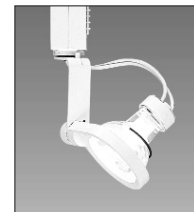
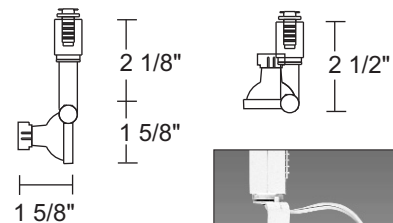

Low Voltage MR11/Mini-Cylinder

Aiming 90° vertical aiming capability and 358° rotation

- Two locking knobs provided.

Catalog Number	Description	Finish	Lamp
TL112WH	Mini-Cylinder	White	20W MR11, 12V or 24V
TL112BL	Mini-Cylinder	Black	20W MR11, 12V or 24V
TL112SC	Mini-Cylinder	Satin Chrome	20W MR11, 12V or 24V
TL112PB	Mini-Cylinder	Polished Brass	20W MR11, 12V or 24V

ACCESSORIES

Cat. No.	Description
T5558BL	Hexcell Louver

See specification sheet [D1.2.2](#) for details.

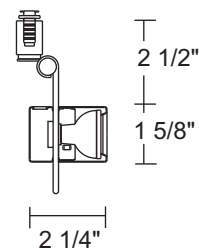

TRAC 12

Miniature Low Voltage Trac System

MR11 SPOTLIGHTS

TL110 and TL112

CBCP • Centerbeam candlepower
FC • Footcandles at beam center (aim point)

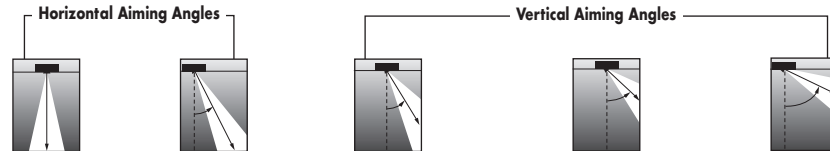

Lamp	Beam Type	Beam Spread°	Rated Life	CBCP	0°		30°			30°				45°				60°							
					MH	FC	L	W	FC	L	W	D	FC	X	L	W	FC	X	L	W	D	FC	X	L	W
20W MR11	SP	15°	3500	1760	2	440	0.5	0.5	286	0.7	0.6	1	220	1.7	1.1	0.5	622	1.0	0.5	0.4	2	286	1.2	0.7	0.6
					4	110	1.1	1.1	71	1.4	1.2	2	55	3.5	2.2	1.1	156	3.0	1.1	0.7	3	127	1.7	1.1	0.9
					6	49	1.6	1.6	32	2.1	1.8	3	24	5.2	3.3	1.6	69	3.0	1.6	1.1	4	71	2.3	1.4	1.2
					8	28	2.1	2.1	18	2.8	2.4	4	14	6.9	4.4	2.1	39	4.0	2.1	1.5	5	46	2.9	1.8	1.5
					10	18	2.6	2.6	11	3.5	3.0	5	9	8.7	5.6	2.6	25	5.0	2.7	1.9	6	32	3.5	2.1	1.8
	NFL	30°	3500	600	2	170	1.5	1.5	110	2.0	1.7	1	85	1.7	4.8	1.5	241	1.0	1.7	1.0	2	110	1.2	2.0	1.7
					4	43	2.9	2.9	28	4.1	3.4	2	21	3.5	9.6	2.9	60	2.0	3.4	2.1	3	49	1.7	3.0	2.5
					6	19	4.4	4.4	12	6.1	5.0	3	9	5.2	14.5	4.4	27	3.0	5.0	3.1	4	28	2.3	4.1	3.4
					8	11	5.8	5.8	7	8.1	6.7	4	5	6.9	19.3	5.8	15	4.0	6.7	4.1	5	18	2.9	5.1	4.2
					10	7	7.3	7.3	4	10.2	8.4	5	3	8.7	124.1	7.3	10	5.0	8.4	5.1	6	12	3.5	6.1	5.0

The beam spread in degrees and the beam "L" and "W" in the following tables are computed at 50% of centerbeam candlepower and represent areas of "effective illumination."

For additional Lamp Data, reference Juno Lighting Product Guide.

24V MR11 HALOGEN LAMPS (not integral lens)

Cat. No.	ANSI Code	Watts	Description	Avg. Life (Hrs.)*
TL938-24V	-	20	Q20MR11/SP/24	2000
TL939-24V	-	20	Q20MR11/NFL/24	2000

