

Juno®

Project: _____

Fixture Type: _____

Location: _____

Contact/Phone: _____

5" IC 600 LUMEN WARMDIM™ * LED DOWNLIGHT NEW CONSTRUCTION

IC20LWDG3 RECESSED HOUSING

OPEN TRIMS



PRODUCT DESCRIPTION

Dedicated LED, Air-Loc® sealed new construction housing with WarmDim™ technology (patent pending) • LED color temperature warms while dimming to emulate the dimming performance of traditional incandescent light sources • Shallow housing allows for fit in 2 x 6 construction • Can be completely covered with insulation • Fully sealed housing stops infiltration and exfiltration of air, reducing heating and air cooling costs without the use of additional gaskets • LED housing is designed to provide 50,000 hours of life and is compatible with many standard Juno trims • 5 year limited warranty on LED components.

ENVIRONMENTALLY FRIENDLY, ENERGY EFFICIENT

- No harmful ultraviolet or infrared wavelengths
- No lead or mercury
- Comparable light output to 65W BR30 incandescent while consuming less than 15W



PRODUCT SPECIFICATIONS

LED Light Engine Proprietary micro processor controlled light engine emulates dimming performance of incandescent light source • Replaceable light engine integrated to one piece high purity aluminum, thermally conductive housing provides uninterrupted heat transfer to ensure long life of the LEDs • 3000K color temperature at full lumen output • 83 CRI typical.

Optical System Computer-optimized reflector design with high reflectance white finish coupled with a high transmission diffusing lens conceals the LEDs and produces uniform aperture luminance • Deep regression of lens produces a low glare, efficient system that can produce over 600 lumens with select trims (see page 2 for details) using less than 15W • Wide flood distribution shipped as standard with optional optic accessory available and sold separately.

Aesthetic Trim Selections Compatible with wide selection of existing Juno trims • Shadow free, knife edge design blends seamlessly into ceiling.

LED Driver Dedicated 120 volt driver • Power factor > 0.9 • Dimmable with the use of most incandescent, magnetic low voltage and electronic low voltage wall box dimmers • For a list of compatible dimmers, see [JUNOEDG3-6-WARMDIM](#) • Mounted between the j-box and housing for easy access and cool operation.

Life Rated for 50,000 hours at 70% lumen maintenance.

Labels ENERGY STAR® Qualified to Luminaires V1.1 requirements when used with select trims • Certified to the high efficiency requirements of California T24-2008 with select trims • UL listed for U.S. and Canada through-branch wiring, damp locations • Union made • UL and cUL.

Testing All reports are based on published industry procedures; field performance may differ from laboratory performance.

Product specifications subject to change without notice.

HOUSING FEATURES

Housing Designed for use in IC (insulated ceiling) or non-IC construction • Aluminum housing sealed for Air-Loc® compliance • Housing is vertically adjustable to accommodate up to a 2" ceiling thickness.

Junction Box Pre-wired junction box provided with (5) 1/2" and (1) 3/4" knockouts, (4) knockouts for 12/2 or 14/2 NM cable and ground wire • UL listed and cUL listed for through-branch wiring, maximum 8 #12 branch circuit conductors • Junction box provided with removable access plates • Knockouts equipped with pryout slots • Quick connect electrical connectors supplied as standard for fast, secure installation.

Mounting Frame 22-gauge die-formed galvanized steel mounting frame • Rough-in section (junction box, mounting frame, housing and bar hangers) fully assembled for ease of installation.

Real Nail 3 Bar Hangers Telescoping Real Nail 3® system permits quick placement of housing anywhere within 24" O.C. joists or suspended ceilings • Includes removable nail for repositioning of fixture in wood joist construction • Integral T-bar notch and clip for suspended ceilings • Design covered under Patents US5,505,419 and D552,969.

*Patent pending

DIMENSIONS

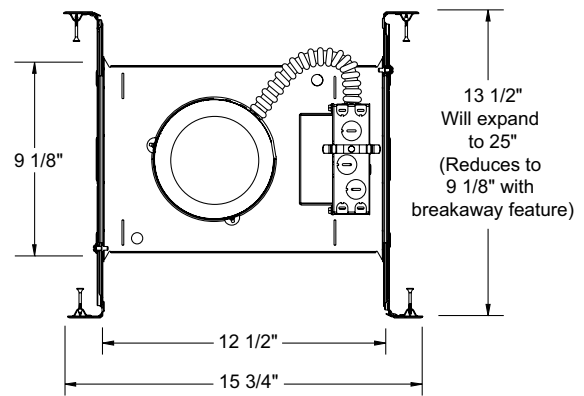
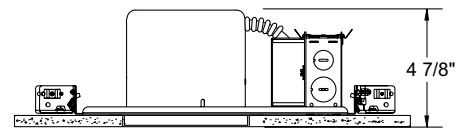

5 5/8" CEILING CUTOUT

ELECTRICAL DATA

Dedicated 120V Only Driver

	120V
Input Power	14W (+/-5%)
Input Current - Max	0.125A
Frequency	50/60 Hz
EMI/RFI	FCC Title 47 CFR, Part 15 Class B (residential)
Minimum starting temp	-20°C

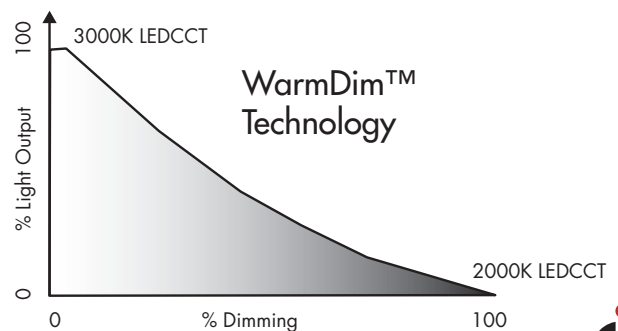

5" IC 600 LUMEN WARMDIM™ * LED DOWNLIGHT NEW CONSTRUCTION



IC20LWDG3 RECESSED HOUSING OPEN TRIMS

ORDERING INFORMATION: Housing, trim and accessories each ordered separately.

Example: **IC20LWDG3-3K-1**

Housing	Color Temperature	Input Voltage
IC20LWDG3	3K 3000K	1 Dedicated 120V Only (Forward Phase + ELV dimmable)

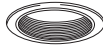
Example: **205W-WH**

Trim/Description
 205W-WH White Baffle 205B-WH¹ Black Baffle 205B-SC¹ Black Baffle 205B-ABZ¹ Black Baffle  204C-WH Cone in Clear Alzak® 204G-WH Cone in Gold Alzak® 204B-WH¹ Cone in Black Alzak® 204PT-SC Cone in Pewter Alzak® 204W-WH Cone in Gloss White 204HZ-WH Cone in Haze 204WHZ-WH Cone in Wheat Haze 204WHZ-ABZ Cone in Wheat Haze

ACCESSORIES

Catalog No.	Description
LEDOPTICG3-M	Medium Flood Optic (50°)

To order, specify catalog number.

*Patent pending

¹ Not ENERGY STAR® rated.
Trim Size: 6 1/4" O.D.
Trim Finish: ABZ - Classic Aged Bronze, SC - Satin Chrome, WH - White.
Alzak is a registered trademark of Alcoa Corp.
Note: In Canada when insulation is present, Type IC fixtures must be used.

PHOTOMETRIC REPORT

Test Report #: LTL27633
Catalog No: IC20LWDG3-3K-1
with 205W-WH Trim
and standard wide flood optic
Luminaire Spacing Criterion: 1.10
Luminaire LPW: 43.3

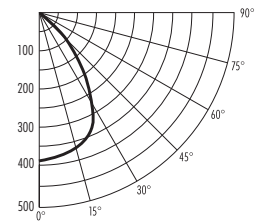

CANDLEPOWER DISTRIBUTION (Candelas)

Degrees Vertical	Candelas
0	389
5	388
15	373
25	323
35	218
45	104
55	55
65	31
75	19
85	5
90	0

AVERAGE INITIAL FOOTCANDLES

Multiple Units (Square Array, 60'x60' room)
Ceiling 80% Wall 50% Floor 20%

Spacing	RCR1	RCR3	RCR5
4.0'	41	34	28
5.0'	26	22	18
6.0'	18	15	12
7.0'	15	12	10
8.0'	12	10	8
9.0'	9	7	6
10.0'	7	5	4

INITIAL FOOTCANDLES (One Unit, 14.1W , 73.5° Beam)

Distance to Illuminated Plane (Feet)	Footcandles Beam Center	Beam Diameter
4	24.3	6.0'
6	10.8	9.0'
8	6.1	11.9'
10	3.9	14.9'

ZONAL LUMEN SUMMARY

Zone	Lumens	%Lamp	%Fixture
0-30°	289	N/A	47.3
0-40°	424	N/A	69.3
0-60°	556	N/A	90.9
0-90°	612	N/A	100.0

LUMINANCE (Average cd/m²)

Degrees	Average Luminance
45	14360
55	9327
65	7155
75	7058
85	5072

PHOTOMETRIC REPORT

Test Report #: PTO1121703R
Catalog No: IC20LWDG3-3K-1
with 204C-WH Trim
and standard wide flood optic
Luminaire Spacing Criterion: 1.22
Luminaire LPW: 50

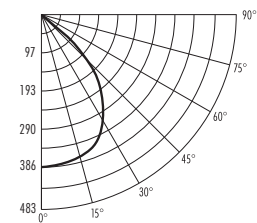

CANDLEPOWER DISTRIBUTION (Candelas)

Degrees Vertical	Candelas
0	386
5	383
15	370
25	346
35	268
45	147
55	76
65	36
75	3
85	0
90	0

AVERAGE INITIAL FOOTCANDLES

Multiple Units (Square Array, 60'x60' room)
Ceiling 80% Wall 50% Floor 20%

Spacing	RCR1	RCR3	RCR5
4.0'	47	38	32
5.0'	30	24	20
6.0'	21	17	14
7.0'	17	14	11
8.0'	13	11	9
9.0'	10	8	7
10.0'	7	6	5

INITIAL FOOTCANDLES (One Unit, 13.9W , 82.1° Beam)

Distance to Illuminated Plane (Feet)	Footcandles Beam Center	Beam Diameter
4	24.1	7.0'
6	10.7	10.4'
8	6.0	13.9'
10	3.9	17.4'

ZONAL LUMEN SUMMARY

Zone	Lumens	%Lamp	%Fixture
0-30°	299	N/A	43.2
0-40°	464	N/A	67.1
0-60°	649	N/A	93.7
0-90°	693	N/A	100.0

LUMINANCE (Average cd/m²)

Degrees	Average Luminance
45	16364
55	10407
65	6736
75	1065
85	0

Fixtures tested to IES recommended standard for solid state lighting per LM-79-08. Photometric performance on a single unit represents a baseline of performance for the fixture. Results may vary in the field.

