



Ø6"

Project:	Type:	QTY:
Product Code:		



Product Code

IP53 - RFL6SD - TRIM COLOR - INTENSITY - VOLTAGE

W*=White **WW30***=3000K 120=120V, AC
A =Aluminum **NW40** =4000K
CC =Custom Color

Note: * Components usually in-stock for quick assembly and shipping.

Features + Specifications

Intended Use:

- Building interior
- Building exterior (ceiling recessed only)
- Damp location listed
- IC rated, approved and tested for direct contact with insulation materials

Construction:

- Die-cast aluminum one piece trim frame with built-in heat sink
- Opal PMMA lens with light glide technology for even light distribution
- Full metal top plate protects LED PCB
- Heavy duty installation springs ensure tight fitting to ceiling

Finish:

- W = Powder coat painted
- A = Anodized aluminum
- CC = Powder coat painted

Optical System:

- High brightness 2835 SMDs with LM80 certificate **12W**
- ***WW30** = 3000K CCT, **1200 lumens** with 80+ CRI
- Optional CCT color **NW40** also available (This CCT might require minimum quantities with longer lead time)
- L70 @ 50000hrs for ambient temperature <25°C, 35000hrs >25°C
- PCB made from laminated heavy gauge copper materials

Electrical System:

- Constant current driver technology
- 120V line voltage dimmable with most dimmers
- Overheat protected, RoHS compliant

Installation hole
cut out size: Ø6-1/4"

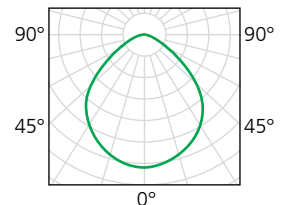
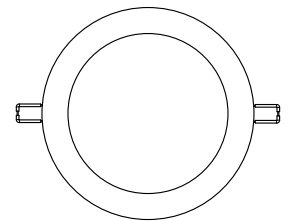
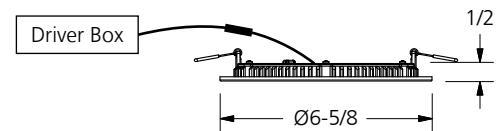

Right reserved for material and spec modification without prior notice.

Datecode 20150120

Warranty - Up To 3 Years

Certified to CSA C22.2 No.250.0 Conformed to UL 1598

Certification Marks (where applicable) will be found on our luminaires and its components



www.iplighting.com

