



Project:	Type:	QTY:
Product Code:		

Product Code

IP55 - 616600	COLOR	LAMP	VOLT	FACE PLATE	OPTION
	B =Black W=White A =Aluminum G =Grey	6W3K=700 lm 6W5K=700 lm	120=120V	LVF=Louvered Frame FLF=Frosted Lens Frame	CPMK=Concrete Pour Mounting Kit

Features + Specifications

Intended Use:

- Building interior
- Building exterior

Construction:

- Die-cast aluminum face plate
- Galvanized steel concrete tight back box with feed through wiring channel for concrete pour or insulated wall and ceiling application
- optional concrete pour mounting kit
- Tempered glass lens
- Extruded silicone gasket

Finish:

- Powder coat paint

Optical System:

- Multiple high brightness SMD LED module

Electrical System:

- Electronic driver, cold temperature rated

Accessories:

- Use with recessed housing number **IP00-616600HSG**

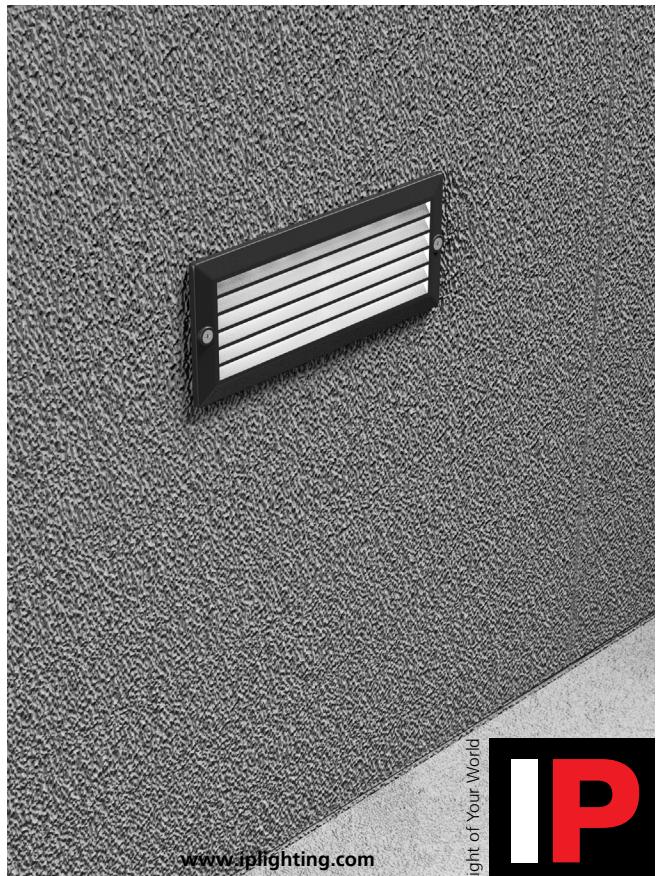
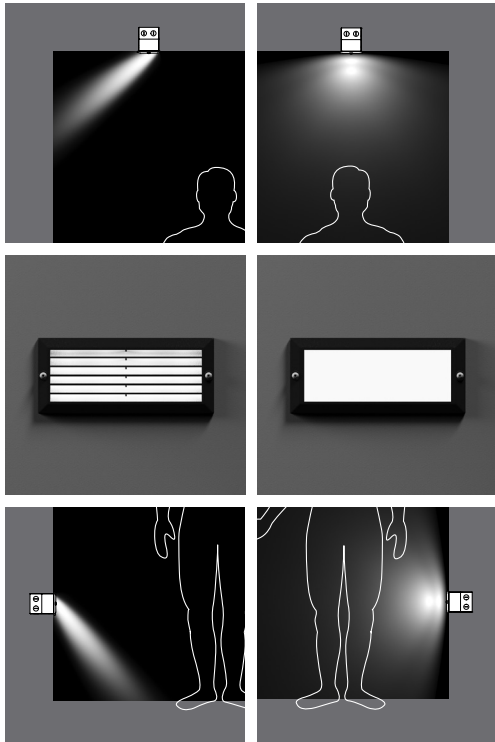
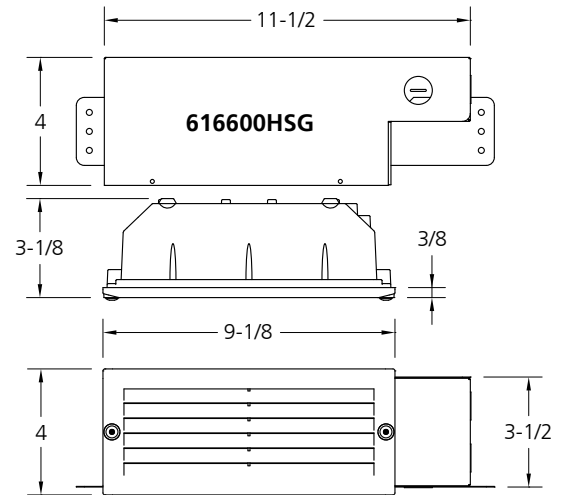

Light of Your World



www.iplighting.com

Certified to CSA C22.2 No.250.0 Conformed to UL 1598

Certification Marks (where applicable) will be found on our luminaires and its components



Right reserved for material and spec. modification without prior notice.

Datecode 20140919

Warranty - Up To 3 Years