

Overview

Low cost AC plug-in clocks are available in Arabic and 24-hour styles. Each of the models come in either a black or grey case with a white dial. All plug in models are CSA listed and operate on 120VAC (60 Hz) and come complete with a plug and a 6 ft. (1.8 M) supply cord.

The battery operated clocks come in either a black or grey case with a white dial and a glass lens, have a high quality quartz crystal movement and use 1.5V "C" size alkaline batteries (not supplied).

Standard Features

- Plug in and battery operated types
- 12" and 15" sizes
- Arabic and 24-hour styles
- Surface mounting
- CSA Certified

Applications

Industrial plants, offices, public buildings, schools, hospitals, terminals, anywhere that economy and a neat appearance are a consideration.

Installation and Mounting

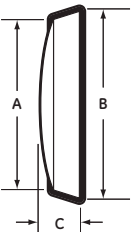

Size & Mounting	Dimensions		
	A	B	C
12" Surface	12" (305mm)	10-3/8" (264mm)	2-15/16" (75mm)
15" Surface	15" (381mm)	16-1/2" (419mm)	2-15/16" (75mm)

Catalog Number	Size	Case Colour	Dial Colour	Numerals/Marker Colour	Style
<b>Surface Mounted AC Clocks</b>					
2941-1	12" (30mm)	Black	White	Black	Arabic
2941-2	12" (30mm)	Gray	White	Black	Arabic
2941-4	12" (30mm)	Black	White	Black/Red	24 HOUR #2
2941-5	12" (30mm)	Gray	White	Black/Red	24 HOUR #2
2942-1	15" (38mm)	Black	White	Black	Arabic
2942-2	15" (38mm)	Gray	White	Black	Arabic
2942-5	15" (38mm)	Gray	White	Black/Red	24 HOUR #2
<b>Surface Mounted Battery Clocks</b>					
2941-1B	12" (30mm)	Black	White	Black	Arabic
2941-2B	12" (30mm)	Gray	White	Black	Arabic
2941-4B	12" (30mm)	Black	White	Black/Red	24 HOUR #2
2941-5B	12" (30mm)	Gray	White	Black/Red	24 HOUR #2
2942-2B	15" (38mm)	Gray	White	Black	Arabic

NOTE: 24 Hour #2 style clocks have outer black numerals for 1-12 and inner red numerals for 13-24.

120VAC and Battery Clocks  
2940 Series

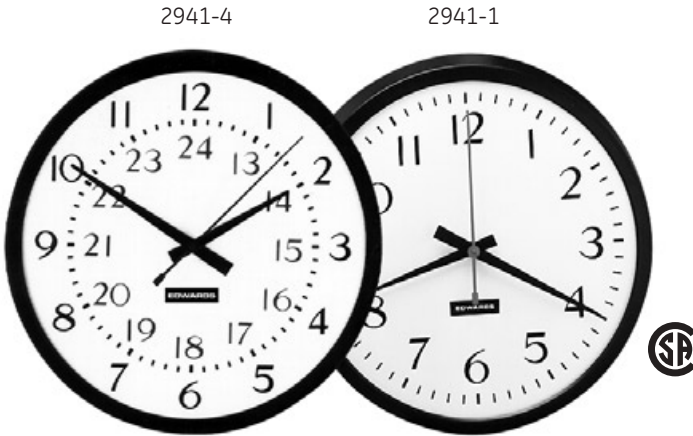

Plastic Dome Guards

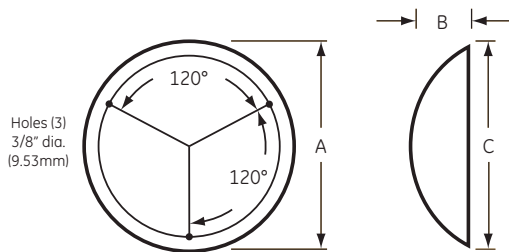

Cat. No.	Dimensions		
	A	B	C
2090B	22" (559mm)	7.5" (191mm)	20.5" (521mm)
2090C*	22" (559mm)	7.5" (191mm)	20.5" (521mm)

\* c/w cut out for reset access. Materials: .19 Acrylic Plastic

Suspension Units

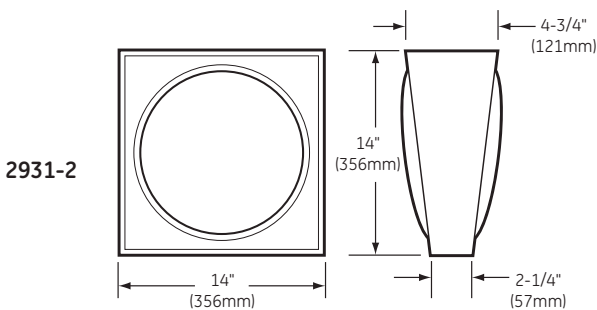

Cat. No 2931-2 will accept any two GE Security 12" round, surface clocks. Unit may be ceiling or wall mounted. Finish: Black.

1899 Series

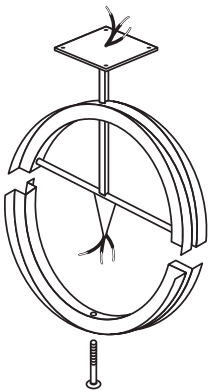

Cat. No's 1899AC (gray) or 1899BLC (black) will accept any two GE Security 12" round surface clocks. Units may be ceiling or wall mounted.

Suspension units supplied with two receptacles.

Wire Guards

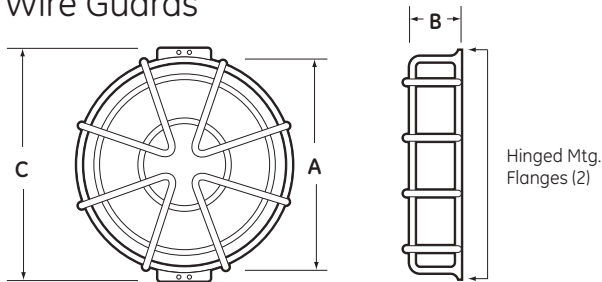

Cat. No.	Dimensions		
	A	B	C
2090A	15.25" (387mm)	5.25" (133mm)	16.25" (412mm)
2091A	21.375" (543mm)	5.25" (133mm)	22.5" (571mm)

Analog Clock Accessories

Plastic Dome Guards, Suspension Units,  
and Wire Guards

