

## Open Reflector

Ceiling Opening: 6-9/16" (167mm)

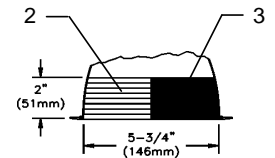
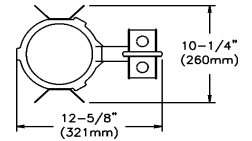
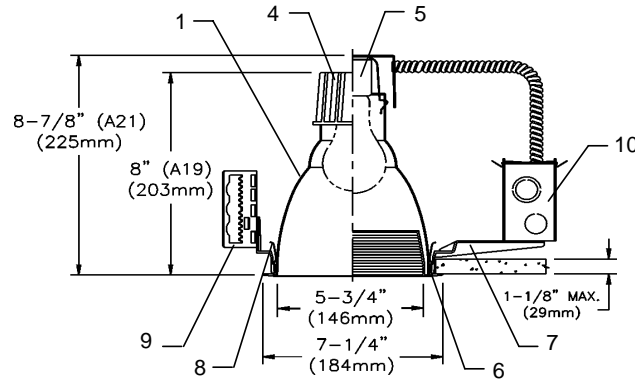

For complete fixture order: Trim Kit + Frame-in Kit. Sold Separately.

| Reflector Trim   | Frame-in Kit   | Lamp                   |
|--|----------------|------------------------|
| <b>TRM7054 BK</b> Specular Black Alzak<br><b>CLP</b> Specular Clear Alzak / Polished Integral Flange<br><b>CLW</b> Specular Clear Alzak / White Integral Flange<br><b>GDP</b> Gold Alzak / Polished Integral Flange<br><b>GDW</b> Gold Alzak / White Integral Flange<br><b>MG</b> Multigroove black baffle<br><b>MGWH</b> White Multigroove / White Molded Trim Ring | <b>FRM7001</b> | 150W A21      100W A19 |

### Features

- 1. Reflector:** Specular Alzak® Aluminum, 45° visual cut-off.
- 2. Multi-Groove Baffle:** One piece, seamless aluminum. Sharply detailed, concentric rings. Black finish. Permanently fastened to specular clear reflector
- 3. Black Cone:** Specular Black Alzak® aluminum. Permanently fastened to specular clear reflector.
- 4. Adjustable Lampholder Housing:** Die-cast aluminum. Designed for effective heat dissipation. Can be adjusted without tools from inside.
- 5. Socket:** Porcelain, medium base. Nickel plated screw shell. 18 ga. SEW leads.
- 6. Molded Trim Ring:** Provides minimum width flanged trim in dry ceilings; white.
- 7. Mounting Frame:** Die-cast aluminum. Suitable for dry or plaster ceilings.
- 8. Retaining Springs:** Rust resistant springs simplify reflector/housing removal for inspection and maintenance.
- 9. Mounting Brackets:** 16 ga. steel. Use 18" (457 mm) mounting bars (optional) or with standard 3/4" (19 mm), 1-1/2" (38 mm) lathing channels (by others) or 1/2" (13 mm) tubing (by others). Adjust vertically from inside of fixture.
- 10. Junction Box:** 14ga. steel, 4" (102mm) x 3-1/2" (89mm) x 2" (51mm) (a) Center-to-center of adjacent luminaires: 914mm circuit wiring with maximum of 8 no. 12, 90° C conductors.

### Accessories

- Mounting bars: 1950** (set of 2) 18" (457 mm) long. 1951 (set of 2) 30" (762 mm) long.
- T-Bar Anchor Clips: 1956** (set of 4) For anchoring mounting bars to T-Bar runners.
- Sloped Ceiling Adapter: 7925.** See specification sheet No. 7920

### Markings

CSA Certified, suitable for damp locations.

| Job Information  | Type: |
|------------------|-------|
| <b>Job Name:</b> |       |
| <b>Cat. No.:</b> |       |
| <b>Lamp(s):</b>  |       |
| <b>Notes:</b>    |       |

7054 A0 (CLEAR ALZAK 150W A-21)

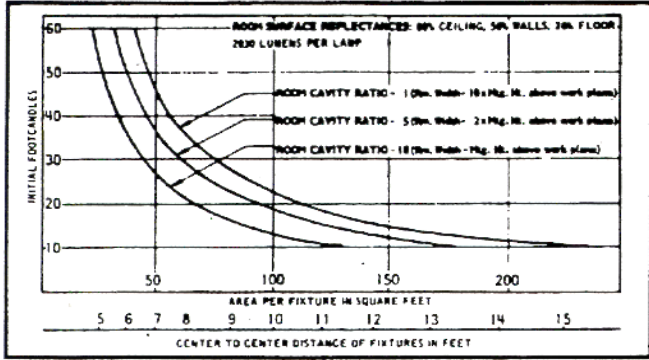

Conversion factors: 150W A-21 (Gold): F.C. x 0.9; 100W A-19 (Clear): F.C. x 0.8; 100W A-19 (Gold): F.C. x 0.55.

7054 A2 (BLACK ALZAK 150W A-21)

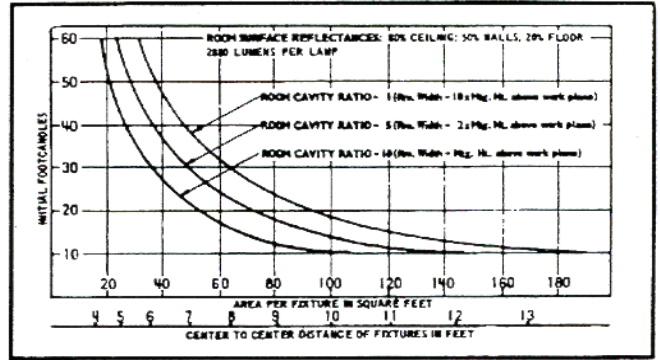

Conversion factors: 150W A-21 (Multigroove): F.C. x 0.9; 100W A-19 (Black Alzak): F.C. x 0.6; 100W A-19 (Multigroove): F.C. x 0.55.

SPACING RATIO = 1.2

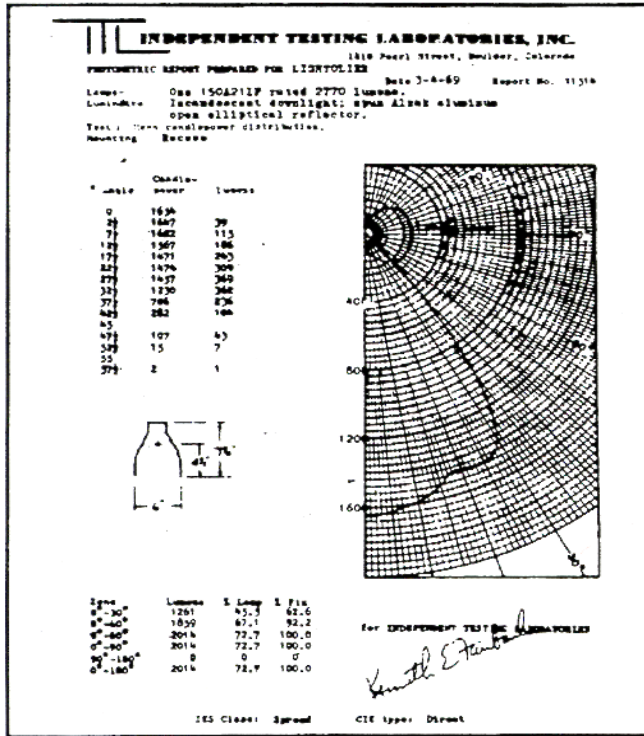

SPACING RATIO = 1.0

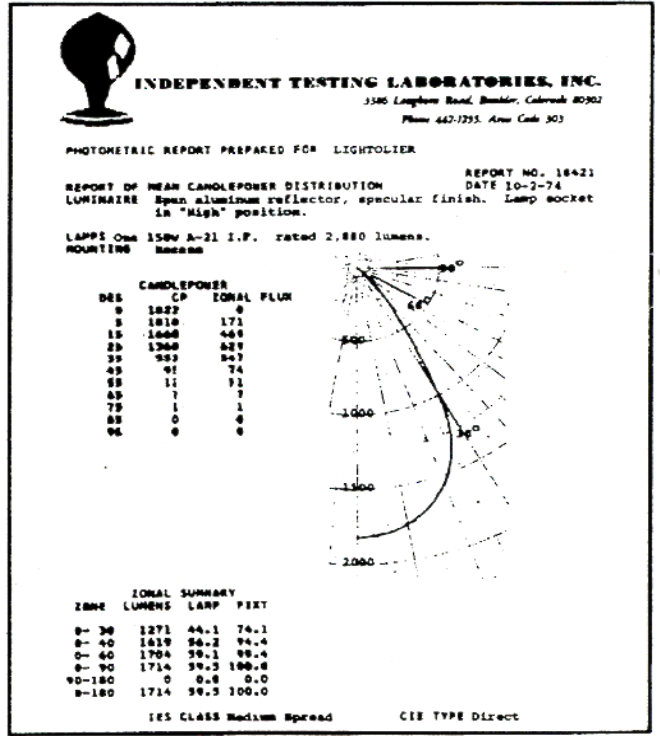

I.T.L. Report No. 11514C. These coefficients were computed by the Zonal-Cavity Method, I.E.S. Recommended Practice, and prepared from the candlepower distribution data given in Independent Testing Laboratories Report No. 11514, dated 3/4/89, and are based on a 20% Floor Cavity Reflectance.

| Room Cavity Ratio | Ceiling Cavity Reflectance |    |    |    |    |    |    |    |    |    |    |    |    |    |    |   |
|-------------------|----------------------------|----|----|----|----|----|----|----|----|----|----|----|----|----|----|---|
|                   | 80                         |    |    |    | 70 |    |    |    | 50 |    |    |    | 10 |    |    |   |
|                   | 50                         | 30 | 10 | 0  | 50 | 30 | 10 | 0  | 50 | 30 | 10 | 0  | 50 | 30 | 10 | 0 |
| 1                 | 82                         | 80 | 74 | 60 | 79 | 77 | 77 | 76 | 75 | 74 | 73 | 72 | 72 | 71 | 69 |   |
| 2                 | 77                         | 74 | 72 | 74 | 73 | 72 | 73 | 72 | 70 | 71 | 70 | 68 | 68 | 67 | 66 |   |
| 3                 | 72                         | 69 | 66 | 71 | 68 | 66 | 69 | 67 | 65 | 66 | 64 | 64 | 63 | 63 | 62 |   |
| 4                 | 68                         | 65 | 62 | 68 | 64 | 61 | 66 | 63 | 61 | 64 | 62 | 60 | 63 | 61 | 59 |   |
| 5                 | 64                         | 60 | 57 | 63 | 59 | 57 | 62 | 59 | 57 | 61 | 58 | 56 | 60 | 58 | 56 |   |
| 6                 | 60                         | 56 | 53 | 59 | 56 | 53 | 58 | 55 | 53 | 57 | 55 | 53 | 57 | 54 | 52 |   |
| 7                 | 56                         | 52 | 50 | 55 | 52 | 49 | 55 | 51 | 49 | 54 | 51 | 49 | 53 | 50 | 48 |   |
| 8                 | 53                         | 49 | 46 | 53 | 49 | 46 | 53 | 48 | 46 | 51 | 48 | 46 | 50 | 47 | 44 |   |
| 9                 | 49                         | 45 | 42 | 49 | 45 | 42 | 48 | 45 | 42 | 47 | 44 | 42 | 47 | 44 | 41 |   |
| 10                | 46                         | 42 | 39 | 46 | 42 | 39 | 45 | 42 | 39 | 44 | 41 | 39 | 44 | 41 | 38 |   |

Conversion factors: 100W A-19 (Gold): C.U. x 0.9

I.T.L. Report No. 18421C. These coefficients were computed by the Zonal-Cavity Method, I.E.S. Recommended Practice, and prepared from the candlepower distribution data given in Independent Testing Laboratories Report No. 18421, dated 10/2/74, and are based on a 20% Floor Cavity Reflectance.

| Room Cavity Ratio | Ceiling Cavity Reflectance |    |    |    |    |    |    |    |    |    |    |    |    |    |    |   |
|-------------------|----------------------------|----|----|----|----|----|----|----|----|----|----|----|----|----|----|---|
|                   | 80                         |    |    |    | 70 |    |    |    | 50 |    |    |    | 10 |    |    |   |
|                   | 50                         | 30 | 10 | 0  | 50 | 30 | 10 | 0  | 50 | 30 | 10 | 0  | 50 | 30 | 10 | 0 |
| 1                 | 84                         | 83 | 74 | 65 | 84 | 83 | 83 | 82 | 81 | 80 | 80 | 79 | 78 | 78 | 77 |   |
| 2                 | 82                         | 80 | 74 | 63 | 81 | 79 | 77 | 76 | 75 | 74 | 74 | 73 | 72 | 72 | 71 |   |
| 3                 | 78                         | 75 | 72 | 61 | 77 | 75 | 73 | 72 | 71 | 70 | 70 | 69 | 68 | 68 | 67 |   |
| 4                 | 75                         | 71 | 68 | 58 | 74 | 71 | 69 | 68 | 67 | 66 | 66 | 65 | 64 | 64 | 63 |   |
| 5                 | 71                         | 67 | 64 | 55 | 70 | 67 | 65 | 64 | 63 | 62 | 62 | 61 | 60 | 60 | 59 |   |
| 6                 | 68                         | 64 | 61 | 52 | 67 | 64 | 62 | 61 | 60 | 59 | 59 | 58 | 57 | 57 | 56 |   |
| 7                 | 64                         | 60 | 57 | 49 | 64 | 61 | 59 | 58 | 57 | 56 | 56 | 55 | 54 | 54 | 53 |   |
| 8                 | 61                         | 57 | 54 | 46 | 61 | 58 | 56 | 55 | 54 | 53 | 53 | 52 | 51 | 51 | 50 |   |
| 9                 | 58                         | 54 | 51 | 43 | 58 | 55 | 53 | 52 | 51 | 50 | 50 | 49 | 48 | 48 | 47 |   |
| 10                | 55                         | 51 | 48 | 40 | 55 | 52 | 50 | 49 | 48 | 47 | 47 | 46 | 45 | 45 | 44 |   |

Conversion factors: 100W A-19 (Black Alzak): C.U. x 1.0; 100W A-19 et 150W A-21 (Multigroove): C.U. x 0.9