



MASTER TL5 Circular

T5 Circular

TL5C 40W 835 1CT/10

Philips T5 Circular lamps are ultra-slim with improved color rendering, higher efficacy, and longer life. T5 HO circular lamps offer extraordinary light output. This circular TL5 lamp (tube diameter 16 mm) offers extended design possibilities. The slim tube allows the creation of extremely flat luminaires and enables omni-directional light distribution. It is suitable for a wide range of professional and semi-professional applications, and is ideal for use in shops, offices and public areas with unconventional layouts.

Product data

• General Information

Cap-Base	2GX13 [2GX13]
Life To 50% Failures Preheat (Nom)	12000 h
LSF Preheat 2000 h Rated	99 %
LSF Preheat 4000 h Rated	99 %
LSF Preheat 6000 h Rated	96 %
LSF Preheat 8000 h Rated	89 %
LSF Preheat 16000 h Rated	10 %
LSF Preheat 20000 h Rated	1 %

• Light Technical

Color Code	835 [CCT of 3500K]
Luminous Flux (Nom)	3300 lm
Luminous Flux (Rated) (Nom)	3300 lm
Color Designation	White (WH)
Chromaticity Coordinate X (Nom)	409
Chromaticity Coordinate Y (Nom)	394
Correlated Color Temperature (Nom)	3500 K
Luminous Efficacy (rated) (Nom)	83 lm/W
Color Rendering Index (Max)	85
Color Rendering Index (Min)	80

Color Rendering Index (Nom)	82
LLMF 2000 h Rated	91 %
LLMF 4000 h Rated	87 %
LLMF 6000 h Rated	84 %
LLMF 8000 h Rated	81 %
LLMF 12000 h Rated	77 %
LLMF 16000 h Rated	74 %
LLMF 20000 h Rated	72 %

• Operating and Electrical

Power (Rated) (Nom)	39.9 W
Lamp Current (Nom)	0.320 A

• Temperature

Design Temperature (Nom)	35 °C
--------------------------	-------

• Controls and Dimming

Dimmable	Yes
----------	-----

• Approval and Application

Energy Efficiency Label (EEL)	A
Mercury (Hg) Content (Nom)	2.5 mg

• Product Data

Full product code	871150027669800
Order product name	TL5C 40W/835
EAN/UPC - Product	8711500276698

PHILIPS

MASTER TL5 Circular

Order code 148593
Numerator - Quantity Per Pack 1
Numerator - Packs per outer box 10

Material Nr. (12NC) 927965583501
Net Weight (Piece) 0.110 kg
ILCOS Code FSC40/35/1B-L/P-2GX13-16

Warnings and Safety

- A lamp breaking is extremely unlikely to have any impact on your health. If a lamp breaks, ventilate the room for 30 minutes and

remove the parts, preferably with gloves. Put them in a sealed plastic bag and take it to your local waste facilities for recycling. Do not use a vacuum cleaner.

Dimensional drawing

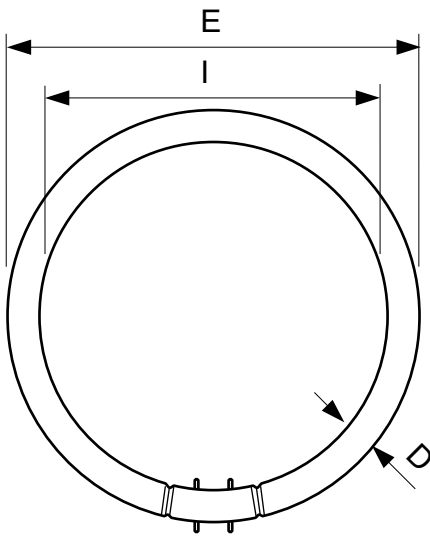

C-T5, 2GX13

TL5-C 40W/835

Product	D	D	E	E	I	I
TL5C 40W/835	18 mm	14 mm	293 mm	305 mm	260 mm	272 mm

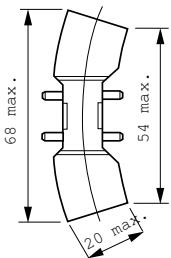



© 2015 Philips Lighting Holding B.V.
All rights reserved.

Specifications are subject to change without notice. Trademarks are the property of Koninklijke Philips N.V. (Royal Philips) or their respective owners.

www.philips.com/lighting

2015, November 29
data subject to change