

CSA Approved for Wet Locations

Available in 1000W Metal Halide & 1000W High Pressure Sodium

### SPECIFICATIONS:

- Housing is a heavy-duty, one-piece die-cast aluminum with cast-in ribbing for maximum heat dissipation. Standard finish is a Duraplex II™ Bronze Electrostatic powder coat.
- Reflector is a three piece system with the main parabola in textured specular finish and with two auxiliary mirror-specular gathering elements.
- Lampholder is a porcelain, 4 kV pulse rated, grip-type Mogul base socket. 5kV for 1000W HPS.
- Lens is made of clear, tempered, shock and heat resistant glass, permanently sealed to the lens frame.
- Lens frame is constructed of die-cast aluminum, and is fully gasketed, hinged and secured with four captive bolts for weatherproof integrity and easy two-hand service.
- Surface Mount (PHW) is constructed of die-cast aluminum with a full 180° of adjustment. Comes complete with spice box & fully enclosed wiring.
- Yoke Mount (PHY) is constructed of zinc plated steel. Fixture is adjustable to a full 180°.
- Arm Mount (PHA) is constructed of cast aluminum and is adjustable to a full 180°. Includes removable wire access cover plate with gasket.
- PHW and PHY series comes with 3' cable.
- 3 year limited warranty.

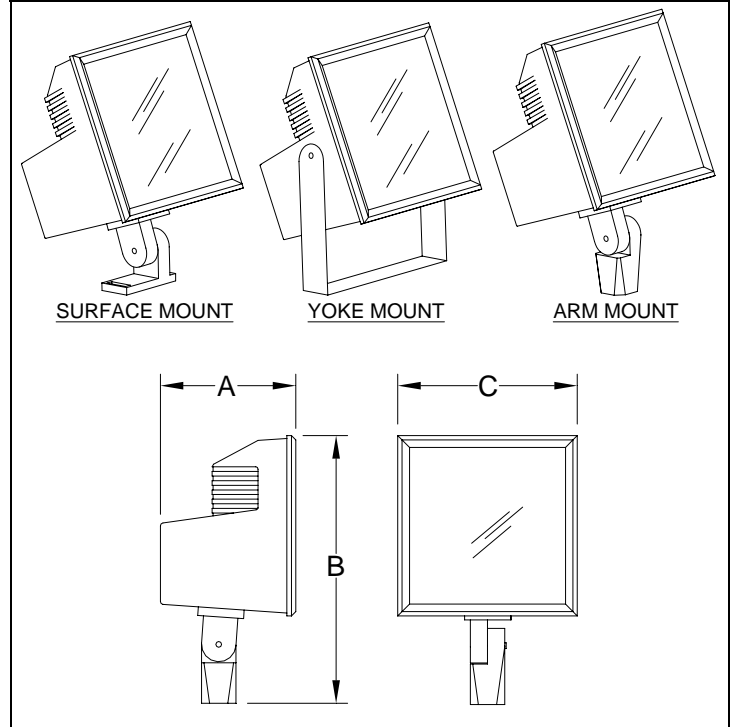

Wattage	"A"	"B"	"C"
1000W	14" [356mm]	33" [838mm]	21" [533mm]
*Note: Arm Mount Shown, "B" Dimension common for all models.			

### ORDERING GUIDE:

Example: **PHW1001MALFS-1W**

						-		
--	--	--	--	--	--	---	--	--

Series	Mounting Type	Lamp Wattage	Light Source	Lamp Included	Options	Voltage	Finish <sup>1</sup>
PH : Powerhouse	A : Adjustable Arm Mount W : Surface Mount Y : Yoke Mount	1001 : 1000W	MA : Metal Halide LX : High Pressure Sodium	L : Yes Blank : No	FS : Fusing (120, 277, 347V only) SP : Mirror-Specular, Long-Throw reflector TLR : Twist Lock Photocontrol receptacle	1 : 120V 2 : 208V 3 : 240V 4 : 277V 5 : 480V 6 : 347V 7 : 600V T : Tri-Tap (120/277/347V)	Blank : Bronze W : White

<sup>1</sup> For other housing finishes, consult factory for available colours & colour codes.

PROJECT: \_\_\_\_\_

TYPE: \_\_\_\_\_

CATALOGUE NUMBER: \_\_\_\_\_