

# PHILIPS LIGHTOLIER

## Downlighting

### LyteCaster

6" Round adjustable  
1500 Lumens



Project: \_\_\_\_\_  
 Location: \_\_\_\_\_  
 Cat.No: \_\_\_\_\_  
 Type: \_\_\_\_\_  
 Lamps: \_\_\_\_\_ Qty: \_\_\_\_\_  
 Notes: \_\_\_\_\_

Philips Lightolier LyteCaster LED Adjustable Downlights are a low cost solution for slope ceiling and wall washing applications that features a 30° tilt. The shallow 3.5" luminaire height conserves the plenum space and is damp location listed. The modular and interchangeable light engine/trim allows for an easy future upgrade.

**Complete product = Frame-in kit + Adjustable light engine / Trim Order each separately**

#### Ordering guide: Frame-In kit

Example: L6RAE1

Series	Frame type	Dimming	Input voltage
<b>L6R</b>	<input type="checkbox"/>	<input type="checkbox"/>	<input type="checkbox"/>
<b>L6R</b> LyteCaster 6" Round	<b>A</b> AirSeal IC, New Construction, Screw <b>AN</b> AirSeal IC, New Construction, Nail	<b>E</b> ELV dimming	<b>1</b> 120V
		<b>Z10</b> 0-10V	<b>U</b> Universal

#### Ordering guide: Adjustable light engine / Trim

Example: L6RA15827W

Series	Lumens	CRI	CCT	Finish
<b>L6RA</b>	<b>15</b>	<input type="checkbox"/>	<input type="checkbox"/>	<b>W</b>
<b>L6RA</b> LyteCaster 6" Round adjustable	<b>15</b> 1500	<b>8</b> 80	<b>27</b> 2700K	<b>W</b> White (with white flange)
			<b>30</b> 3000K <b>35</b> 3500K	
		<b>9</b> 90	<b>27</b> 2700K	<b>W</b> White (with white flange)

Note: Lumen output is calculated based on 80 CRI and 3500K CCT. Please consult adjustment factors table on page 4 for other lumen outputs.



# L6RA LyteCaster 6" Round adjustable

General purpose downlight, 1500 lumens

## Frame-in kit

### Bottom view

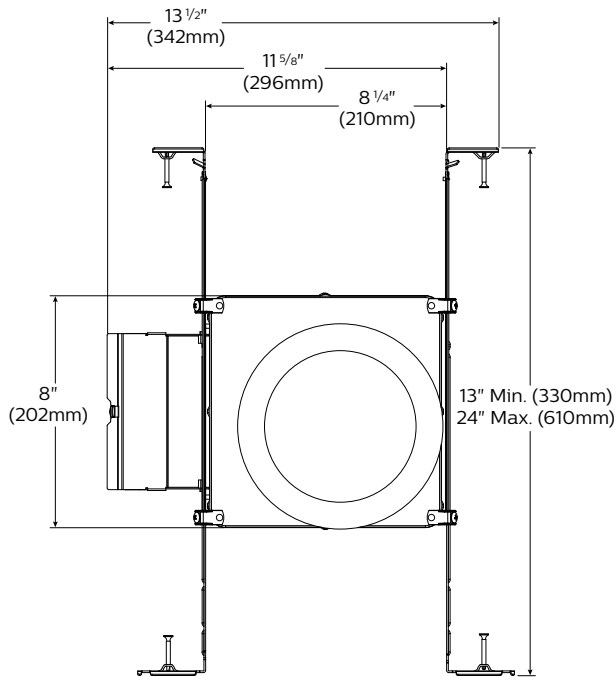

### Side view

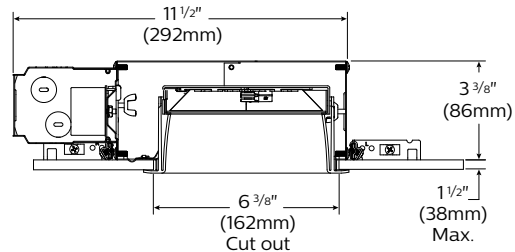

### Adjustable light engine/trim

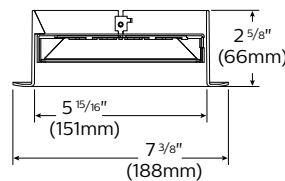

### Maximum tilt: 30°

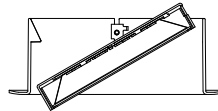

## Features

- Housing:** .026" galvanized steel. UL listed for direct contact with thermal insulation. Airseal® housing minimizes air leakage to less than 2 CFM at 1.57PSF (or 75PA), which complies with Title 24, the International Energy Conservation Code, and Washington State Energy Code (Section 502.4). This helps to reduce heat loss and condensation in ceiling. Access door for inspection of junction box.
- Lower frame and top cover:** .026" galvanized steel. Accommodates ceilings up to 1 1/2" (38mm) thick. 3/8" (9.5mm) deep integral lip with four notches at 90° apart to simplify alignment. Locks into position along length of mounting bars with locking screws.
- Junction Box:** 2.5" X 5 3/8" X 2" (27 cu. in) .032" galvanized steel. UL listed 90° supply conductors. Rated for branch circuit wiring supplying connected luminaires (daisy chaining).
- Retaining clips:** Permit easy and fast installation of light engine/trim.
- Mounting bars:** .059" galvanized steel. Bars pivot for easy attachment and wire-in below ceiling line. Bars extend to accommodate 16" (406mm) to 24" (610mm) O.C. joist spacing. Bars can accommodate 12" (305mm) O.C. joist spacing after a slight field modification (see Instruction sheet). Features integral self tapping phillips/square drive screws for secure attachment to wood or metal construction. Also available with integral nails. Attaches to T-bar ceilings without the need of accessories. Bars installed on shortest dimension of frame, but can be easily repositioned 90 degrees from original position.
- Driver:** ELV: 120V, 50/60Hz. RoHS compliant, Class 2 power supply. Complies with FCC rules per Title 47 Part 15 (Class B) for EMI/RFI (conducted & radiated). Class A sound rating. **0-10V:** 120/277V, 50/60Hz. RoHS compliant, Class 2 power supply. Complies with FCC rules per Title 47 Part 15 (Class A) for EMI/RFI (conducted & radiated). Class A sound rating.
- Ceiling cutout:** 6 3/8" (162mm).

## Electrical

**Lifetime:** Expected lifetime 45,000 hours at L70 and backed by a 5-year limited warranty. (see Philips.com/warranties for details)

## Recommended dimmers

See LED-DIM Specification Sheet.

## Labels

IC/AirSeal complies with Air Leakage.

cULus listed for ceiling or wall installation. Suitable for damp locations.

This product complies with the requirements of the California Energy Commission regulated under Title 24, and has been listed in the Title 20 database.

# L6RA LyteCaster 6" Round adjustable

General purpose downlight, 1500 lumens

## Reflector: Round adjustable

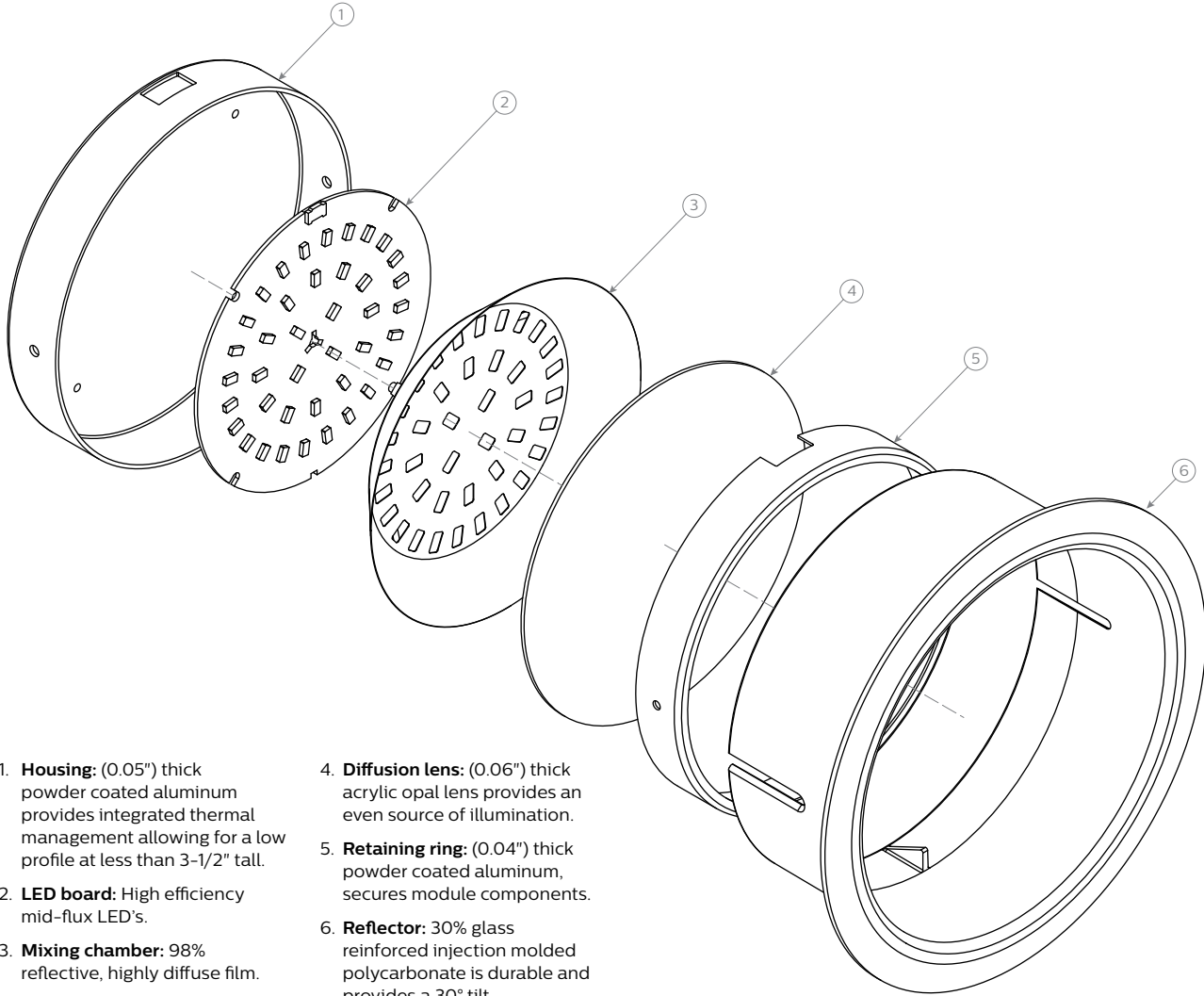

- 1. **Housing:** (0.05") thick powder coated aluminum provides integrated thermal management allowing for a low profile at less than 3-1/2" tall.
- 2. **LED board:** High efficiency mid-flux LED's.
- 3. **Mixing chamber:** 98% reflective, highly diffuse film.
- 4. **Diffusion lens:** (0.06") thick acrylic opal lens provides an even source of illumination.
- 5. **Retaining ring:** (0.04") thick powder coated aluminum, secures module components.
- 6. **Reflector:** 30% glass reinforced injection molded polycarbonate is durable and provides a 30° tilt.

## Electrical

Screw / Nail Frame-in kit Electrical specifications	Input volts	Input freq.	Input current	LED drive current	Input power	LED power	THD factor	Power factor
L6RAE1	120V	50/60Hz	0.16A	545mA	19W	17W	<20%	>0.9
L6RAZ10U	120V	50/60Hz	0.16A	545mA	19W	15W	<10%	>0.9
	277V	50/60Hz	0.07A	545mA	19W	15W	<15%	>0.9

# L6RA LyteCaster 6" Round adjustable

General purpose downlight, 1500 lumens

## 80 CRI, 1500 lumens (downlight photometry shown)

### Candela Curves

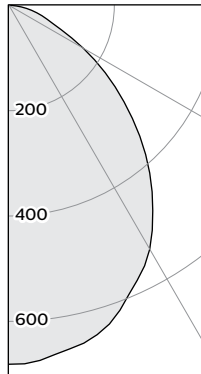

Angle	Mean CP	Lumens
0	681	
5	677	64
10	662	
15	647	182
20	616	
25	576	265
30	535	
35	476	298
40	416	
45	351	270
50	285	
55	223	199
60	163	
65	109	112
70	77	
75	55	58
80	34	
85	14	17
90	0	

### Single unit data

Height to Lighted Plane	Initial Center Beam Foot-Candles	Beam Dia. (ft)*
5'	27	6.0'
6'	19	7.2'
7'	14	8.4'
8'	11	9.6'
9'	8	10.8'

\* Beam diameter is where foot-candles drop to 50% of maximum.

### Multiple unit data - RCR 2

Spacing on center	Initial Center Beam Foot-Candles	Watts per Sq. Ft.
5'	61.1	0.76
6'	40.1	0.50
7'	28.7	0.36
8'	23.9	0.30
9'	19.1	0.24

38'x38'x10' Room, Workplane 2.5' above floor, 80/50/20% Reflectances

### Coefficients of utilization

Ceiling	80%				70%		50%		30%		0%											
Wall	70	50	30	10	50	10	50	10	50	10	0											
RCR	Zonal cavity method - Effective floor reflectance = 20%																					
Room Cavity Ratio	0	1	2	3	4	5	6	7	8	9	10	119	119	119	119	116	116	111	111	106	106	100
	1	110	106	102	99	104	97	100	94	96	91	87	87	87	83	82	89	80	86	78	75	75
	2	101	94	88	83	92	82	89	80	86	78	75	75	75	71	71	82	70	80	69	77	68
	3	93	84	77	71	82	70	80	69	77	68	65	65	65	61	61	74	61	72	60	69	59
	4	86	75	67	61	74	61	74	61	69	59	56	56	56	53	53	67	53	65	53	63	52
	5	80	68	60	54	67	53	65	53	63	52	50	50	50	47	47	61	47	59	47	57	44
	6	74	62	53	47	61	47	59	47	57	47	44	44	44	42	42	56	42	54	42	53	42
	7	69	56	48	42	56	42	54	42	53	42	40	40	40	38	38	51	38	50	38	49	38
	8	64	52	44	38	51	38	50	38	48	37	36	36	36	35	35	47	35	46	34	45	34
	9	60	48	40	35	47	35	46	34	45	34	32	32	32	32	32	44	32	43	31	42	31
	10	57	44	37	32	44	32	43	31	42	31	30	30	30	30	30	44	32	43	31	42	31

Frame: L6RAE1  
Light engine: L6R15835  
Trim: L6RDW

Report no<sup>3</sup>: 462GFR

Output lumens: 1465lm  
Input Watts: 17.1W  
Spacing Criterion: 1.2

Efficacy: 85.7lm/W  
CCT<sup>2</sup>: 3500K  
CRI: ≥80

### Zonal lumens & percentages

Zone	Lumens	%Luminaire
0-30	512	34.9%
0-40	809	55.2%
0-60	1279	87.3%
0-90	1465	100.0%

### CRI and CCT adjustment factors

90CRI 2700K: = 71%
80CRI 2700K: = 89%
80CRI 3000K: = 97%
80CRI 3500K: = 100%

## 90 CRI, 1145 lumens (downlight photometry shown)

### Candela Curves

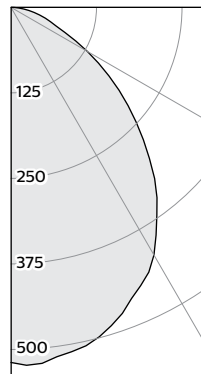

Angle	Mean CP	Lumens
0	519	
5	522	49
10	511	
15	499	140
20	476	
25	449	207
30	418	
35	372	233
40	327	
45	274	211
50	223	
55	175	157
60	129	
65	87	89
70	61	
75	43	46
80	27	
85	12	13
90	0	

### Single unit data

Height to Lighted Plane	Initial Center Beam Foot-Candles	Beam Dia. (ft)*
5'	21	6.0'
6'	14	7.2'
7'	11	8.4'
8'	8	9.6'
9'	6	10.8'

\* Beam diameter is where foot-candles drop to 50% of maximum.

### Multiple unit data - RCR 2

Spacing on center	Initial Center Beam Foot-Candles	Watts per Sq. Ft.
5'	47.7	0.78
6'	31.3	0.51
7'	22.4	0.37
8'	18.6	0.30
9'	14.9	0.24

38'x38'x10' Room, Workplane 2.5' above floor, 80/50/20% Reflectances

### Coefficients of utilization

Ceiling	80%				70%		50%		30%		0%											
Wall	70	50	30	10	50	10	50	10	50	10	0											
RCR	Zonal cavity method - Effective floor reflectance = 20%																					
Room Cavity Ratio	0	1	2	3	4	5	6	7	8	9	10	119	119	119	119	116	116	111	111	106	106	100
	1	110	106	102	99	104	97	100	94	96	91	87	87	87	83	82	89	80	86	78	74	74
	2	101	94	88	83	92	82	89	80	86	78	74	74	74	71	71	82	70	79	69	77	68
	3	93	84	76	71	82	70	79	69	77	68	64	64	64	61	61	74	61	71	60	69	59
	4	86	75	67	61	74	61	74	61	69	59	56	56	56	53	53	67	53	65	53	63	52
	5	80	68	60	54	67	53	65	53	63	52	50	50	50	47	47	61	47	59	47	57	46
	6	74	62	53	47	61	47	59	47	57	47	44	44	44	42	42	56	42	54	42	53	42
	7	69	56	48	42	56	42	54	42	53	42	40	40	40	38	38	51	38	50	38	48	37
	8	64	52	44	38	51	38	50	38	48	37	36	36	36	35	35	47	35	46	34	45	34
	9	60	48	40	34	47	34	46	34	45	34	32	32	32	32	32	44	32	43	31	42	31
	10	57	44	36	31	43	31	43	31	42	31	30	30	30	30	30	44	32	43	31	42	31

### Zonal lumens & percentages

Zone	Lumens	%Luminaire
0-30	396	34.6%
0-40	629	54.9%
0-60	997	87.0%
0-90	1145	100.0%

Frame: L6RAE1  
Light engine: L6R15927  
Trim: L6R6W

Report no<sup>3</sup>: 509GFR

Output lumens: 1145lm  
Input Watts: 17.6W  
Spacing Criterion: 1.2

Efficacy: 65.1lm/W  
CCT<sup>2</sup>: 2700K  
CRI: ≥90

1. Wattage: controlled to within ± 10%
2. Correlated Color Temperature: within specs as defined in ANSI\_NEMA\_ANSLG C78.377-2008: Specifications for the Chromaticity of Solid State Lighting Products.
3. Tested using absolute photometry as specified in LM79: IESNA Approved Method for the Electrical and Photometric Measurements of Solid-State Lighting Products.

© 2014 Koninklijke Philips N.V. All rights reserved.  
Philips reserves the right to make changes in specifications and/or to discontinue any product at any time without notice or obligation and will not be liable for any consequences resulting from the use of this publication.  
philips.com/luminaires



Philips Lighting, North America Corporation  
200 Franklin Square Drive, Somerset, NJ 08873  
Tel. 855-486-2216

Imported by: Philips Lighting,  
A division of Philips Electronics Ltd.  
281 Hillmount Rd, Markham, ON, Canada L6C 2S3  
Tel. 800-668-9008