

Cable Tray Ground Clamp

Type CTGC



Use:
Terminates ground wire to cable tray.

- Features:**
- For aluminum or copper conductors.
 - 1/4" hex wrench tightens both tray and conductor set screws.
 - Tray-gripping serrations bite through insulating oxide on surface of aluminum tray.
 - For 1/2" max. straight tray rail, or 1/4" 90° tray rail.
 - Conductor size #6 to 250 MCM

Material/Finish:
Clamp - Extruded Aluminum/Tin Plated
Screws - Steel/Zinc Electroplated

Options:
Stainless steel screws are available - add suffix **SS**

Third Party Certification:

-  UL Listed: E-24264
-  CSA Certified: 009795
For copper conductors only.

Catalog Number	Conductor Range AWG/kcmil		Dimensions in Inches	
	Min.	Max.	A	B
CTGC-6-25A	6	250	2	1 3/4

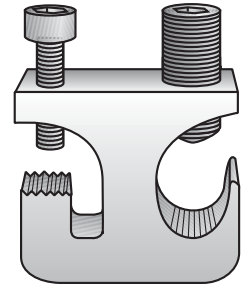
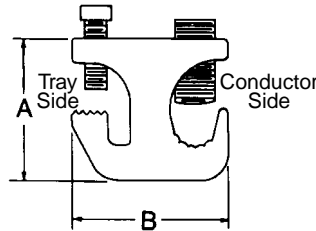

Type CTGC

Applicable Third Party Standards:

- UL Standard: 467
- CSA Standard: C22.2 No. 41
- NEC 250-77 and 318-6

Ground Rod Clamps

Commodity Grade



Type GRC

Use:
To ground a conductor to a driven ground rod.

- Features:**
- High strength cast bronze.
 - Suitable for direct burial.

Material:
Cast Bronze

Third Party Certification:

-  UL Listed: E-24264
Suitable for direct burial.
-  CSA Certified: 057250

Applicable Third Party Standards:
UL Standard 467
CSA Standard: C22.2 No. 41
National Electrical Code
Articles 250-112, 250-113 and 250-115
NEMA: FB-1

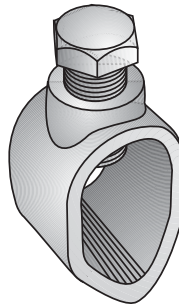

Type GRC

Catalog Number	Ground Rod Size Inches	Screw Thread Size (UNC-2A)	Conductor Range AWG		Dimensions in Inches		
			Min.	Max.	Max. Height	Max. Width Across Open End	Side Length
GRC-50-02B	1/2	3/8 - 16	10	2	1 13/16	1 3/16	1 1/16
GRC-62-02B	5/8	3/8 - 16	10	2	1 7/8	1 5/16	5/8
GRC-62-10B	3/4	3/8 - 16	8	1/0	1 15/16	7/8	1
GRC-75-10B	3/4	3/8 - 16	8	1/0	2 3/16	1 1/16	1 1/8

Universal Ground Clamp System

Type G

Use:
For connecting grounding conductors to cold water ground pipe in sizes 1 1/4" through 12".

Features:

- Standard built-in ground wire connector for #8 Sol. through #2 Str. AWG wire.
- Provision for separate 2-station attachment of additional swivel accessories are listed in ground clamp accessories tables. See page MA-3.
- Cast Bronze clamps are suitable for direct burial.

Material/Finish:

Catalog Numbers with suffix "G" are Malleable Iron, Hot Dip Galvanized. Bolts and Nuts are Steel, Hot Dip or Mechanically Galvanized.

Catalog Numbers with suffix "B" are Cast Bronze with Silicon Bronze Bolts and Nuts.

Accessories: (see page MA3)

- For larger conductors add Type GWD dead end terminals.
- For connecting conductors run in conduit, add Type GH swivel ground hubs.
- For connecting armored ground wire, add Type GWA Terminal.

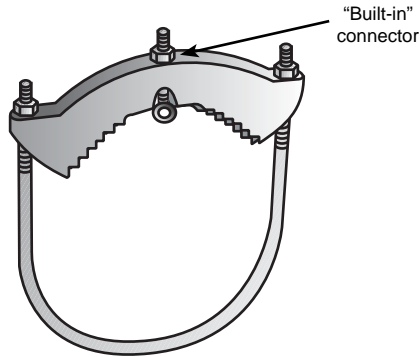

Type G

Third Party Certification:
UL Listed: E-24264



CSA Certified: 009795

Applicable Third Party Standards:
UL Standard: 467
CSA Standard: C22.2 No. 18
Fed. Spec: W-F-406E

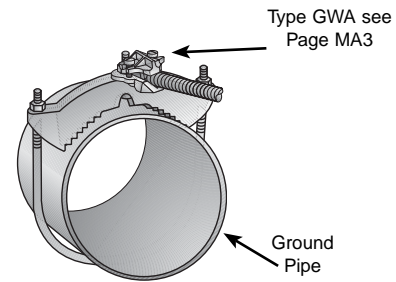

Type G with Type GWA
Armor Ground Wire Connector

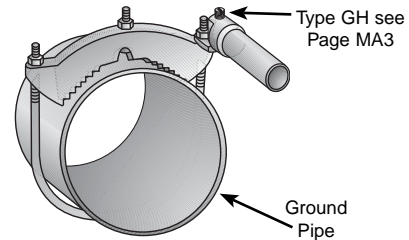

Type G with Type GH
Ground Hub

Malleable Iron Catalog Number	Cast Bronze Catalog Number	Nominal Size	Ground Pipe Size O.D. Range		Dimensions in Inches			U-Bolt
			Min.	Max.	Thk.	Width	Height Max.	
G-200G	G-200B	1 1/4-1 1/2-2	1.660	2.375	7/8	3 3/8	4 1/2	5/16
G-350G	G-350B	2 1/2-3-3 1/2	2.875	4.000	7/8	5 1/4	6 1/8	5/16
G-500G	G-500B	4-4 1/2-5	4.500	5.563	7/8	6 13/16	8	5/16
G-600G	G-600B	6	6.000	7.100	7/8	8 3/8	9 1/8	5/16
G-800G	G-800B	8	8.000	9.300	7/8	10 3/8	11 13/16	5/16
G-1000G	G-1000B	10	10.000	11.400	7/8	12 1/4	13 13/16	5/16
G-1200G	G-1200B	12	12.000	13.500	7/8	14 13/16	16	5/16

Type GES

Flexible Ground Strap

Use:
To provide flexible connection between ground hub and universal clamp.

Material: Copper

Third Party Certification:
UL Listed: E-24264



Applicable Third Party Standards:
UL Standard: 467
CSA Standard: C22.2 No. 41
Fed. Spec: W-F-406E

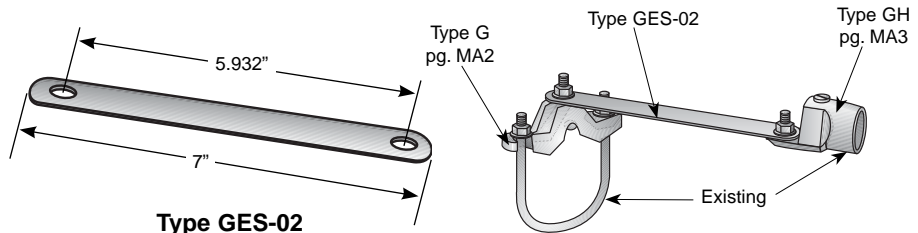

Type GES-02

Type GES-02 between Hub and
Ground Clamp

Note:
Suitable for direct burial when used with clamps and accessories that are suitable for direct burial.

Catalog Number	Number of Straps (Required)	Mounting Centers	Dimensions in Inches			Max. Ground Wire Size
			Width	Strap Holes	Thickness	
GES-02	1	6	1	.342	1/16	2 AWG/kcmil
	2	6	1	.342	1/16	2/0 AWG/kcmil
	3	6	1	.342	1/16	3/0 AWG/kcmil
	4	6	1	.342	1/16	250 AWG/kcmil

Universal Ground Clamp Accessories

Type GH, GWA & GWD - Swivel Types

Use:

For use with the universal ground clamps to connect grounding conductors run bare, in armor, or in conduit. Fits all basic ground clamp systems, G-200G through G-1200G and G-200B through G-1200B. See Page MA2.

Material/Finish:

Type GH-G - Malleable Iron-Hot Dip Galvanized; Steel Screws Zinc Electroplated
 Type GH-B - Cast Bronze, Brass Screws
 Type GWA - Cast Bronze, Silicon Bronze Screws
 Type GWD - Cast Bronze, Brass Screws

Third Party Certification:



Applicable Third Party Standards:

UL Standard: 467
 Fed. Spec: W-F-406E

Note:

All cast bronze and brass accessories are suitable for direct burial.

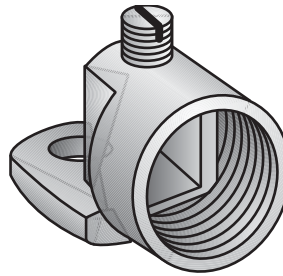

Type GH-G
 Malleable Iron – Hot Dip Galvanized

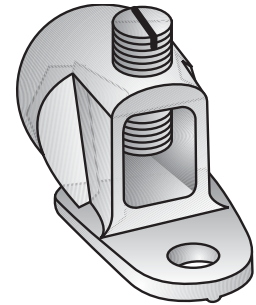

Type GH-B
 Cast Bronze

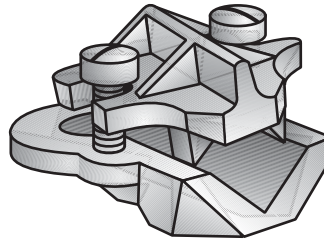

Type GWA
 Cast Bronze

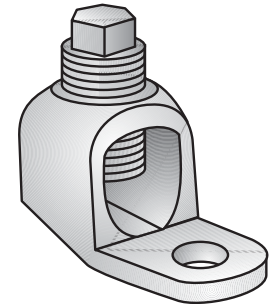

Type GWD
 Cast Bronze

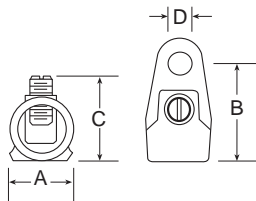

Type GH

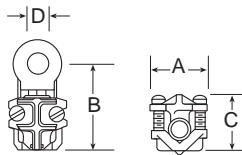

Type GWA

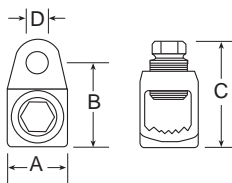

Type GWD

GROUND HUBS								
Malleable Iron Catalog Number	Cast Bronze Catalog Number	Hub Trade Size (In.)	Conductor Range AWG/kcmil		Dimensions in Inches			
			Min.	Max.	A	B	C Max.	D
GH-50G	GH-50B	½	8	2	1	1½	1¾	¾
GH-75G	GH-75B	¾	4	2/0	1¼	1¾	1½	¾
GH-100G	GH-100B	1	1	250	1½	2½	2¾	¾
GH-125G	GH-125B	1¼	4/0	500	1¾	2½	2½	¾

ARMORED GROUND WIRE CONNECTOR							
Catalog Number	Conductor Range AWG/kcmil		Max. Armor Dia.	Dimensions in Inches			
	Min.	Max.		A	B	C Max.	D
GWA-04B	8 Sol.	4 Str.	.396	1½	1¼	1¼	¾

BARE OR INSULATED WIRE DEAD END TERMINAL HUB						
Catalog Number	Conductor Range AWG/kcmil		Dimensions in Inches			
	Min.	Max.	A	B	C Max.	D
GWD-25B	1	250 Mcm	1½	1¼	1¼	¾
GWD-50B	4/0	500 Mcm	1¾	1¾	2½	¾

Heavy Duty Ground Clamps

Type GF-19G Combination Armored Clamp or Bare Ground Wire

Use:
For connecting armored or bare grounding wire to ground pipe

Material/Finish:
Malleable Iron, Hot Dip or Mechanically Galvanized
Screws are Steel, Zinc Electroplated

Third Party Certification:
 UL Listed: E-24264

Applicable Third Party Standards:
UL Standard: 467
Fed. Spec: W-F-406E

Catalog Number	Ground Pipe Size Inches	Conductor Range AWG		Dimensions in Inches		
		Min.	Max.	Height	Width	Clamp Width
GF-19G	1/2-3/4-1	8	4	2 $\frac{3}{8}$	1 $\frac{1}{8}$	1 $\frac{1}{8}$

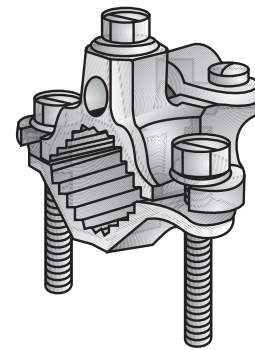

Type GF-19G

Type G-50 Heavy Duty Ground Clamp w/Swivel Hub for threaded rigid conduit or IMC.

Use:
For connecting grounding conductor (run in conduit) to ground pipe.

Material/Finish:
Malleable Iron, Hot Dip or Mechanically Galvanized
Screws: Steel/Zinc Electroplated

Third Party Certification:
 UL Listed: E-24264

Applicable Third Party Standards:
UL Standard: 467
Fed. Spec: W-F-406E

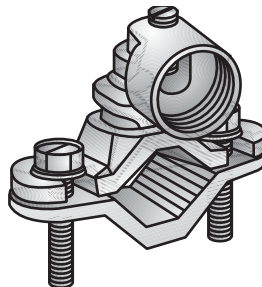

Type G-50G

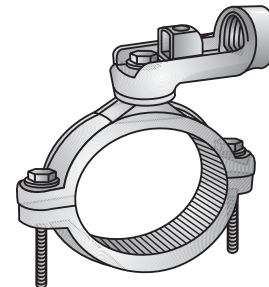

Type G-51G & Type G-52G

Ground Pipe Size Inches	Catalog Number	Conductor Range AWG/kcmil		Dimensions in Inches		
		Min.	Max.	Conduit Center to Top of Fitting	Clamp Width	Clamp Width
1/2	G-50G	8	2	1 $\frac{1}{4}$	1 $\frac{1}{8}$	2 $\frac{1}{2}$
3/4	G-51G	6	1/0	1 $\frac{1}{2}$	2 $\frac{1}{4}$	2 $\frac{1}{2}$
1	G-52G	1/0	250	1 $\frac{1}{2}$	3 $\frac{3}{8}$	2 $\frac{1}{2}$

Pipe Ground Clamps

Commodity Grade

Type GC

For bare wire

Type GCA

For armored cable

Type GCH

With conduit hub

Use:

To ground a conductor to metallic pipe, tubing or ground rod.

Features:

- High strength cast copper alloy
- Screws electroplated to resist corrosion

Material:

Casting - Copper Alloy

Screws - Steel

Finish:

Copper Alloy - Natural finish

Screws - Zinc Electroplated

Features:

- GC: Bare wire clamp from #10 solid to #3 stranded AWG.
- GCA: Armored cable or rigid conduit clamp from #8 solid to #4 stranded AWG.
- GCH: Rigid conduit clamp from #10 solid #4 stranded AWG.
- GCA, GCH and GC-100-02B are reversible for attachment to ground rods.

Third Party Certification:



UL Listed: E-24264



CSA Certified: 057250

Applicable Third Party Standards:

UL Standard: 467

CSA Standard : C22.2 No. 41

National Electrical Code

Article 250-26(c), 250-112, 250-115

NEMA: FB-1

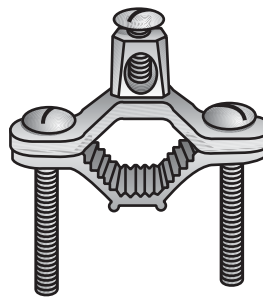

Type GC-100-02B

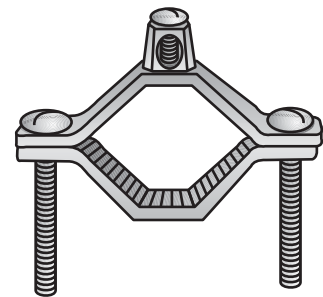

Type GC-200-02B

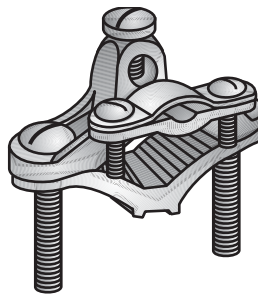

Type GCA-100-04B

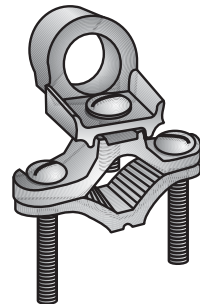

Type GCH-100-50-04B

Catalog Number	Ground Pipe Size Inches	Conductor Range AWG Min. Max.	Conduit Hub Size Inches	Dimensions in Inches			Top of Pipe to Top of Fitting
				Height	Width	Clamp Width	
GC-100-02B	½ - 1	10 2	--	2½	2⅝	1⅞	--
GC-200-02B	1¼ - 2	10 2	--	3⅞	3¾	1⅞	--
GCA-100-04B	½ - 1	8 4	--	2½	2¾	1⅞	--
GCH-100-50-04B	½ - 1	10 4	½	2¼	2¾	1⅞	1⅞