

Data and specifications subject to change without notice

Project name	Type
Order number	
Date	

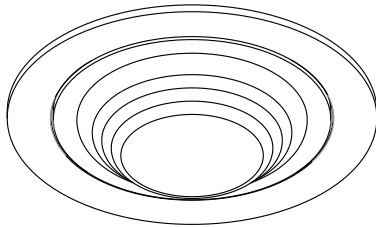

# CORAL

## MR16 TRIM

### SPECIFICATIONS

The Coral is a die cast shower trim which features a stepped drop glass diffuser. This glass design provides uniform vertical and horizontal illumination. The Coral trim includes a silicone gasket and a sealed glass diffuser.

NOTE: Trim & Housing combination are designed for typical 5/8" drywall application, contact factory for various ceiling thickness.

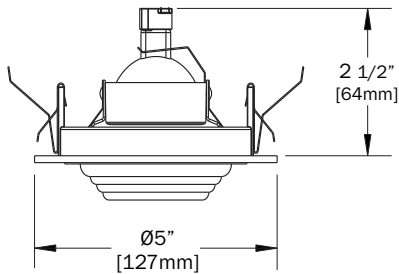

- ◆ Made of die-cast aluminum
- ◆ Powder coated or plated trim ring finishes
- ◆ Wet location listed
- ◆ Lamp holder accepts 1 lens accessory
- ◆ Designed for non-cover glass MR16 lamp
- ◆ Available with clear or frosted glass
- ◆ 50W or 75W maximum rating depending on the housing
- ◆ See metal halide trim spec sheet for MH options

Applications: Coral trim can be used for showers, soffits, saunas, or any place where a wet listed trim is required.

### ORDER GUIDE

HOUSING	VOLTAGE	TRIM	FINISH	GLASS
No Housing (Max 20W) <sup>1</sup>	120	2-110 Coral	01 - White	F - Frosted
2-010-I/C (Max 50W)	277		02 - Chrome	C - Clear
2-010-I/C-A/T (Max 50W)	347 <sup>2</sup>		05 - Matte Silver	
2-010-I/C-TOR (Max 50W)			06 - Bronze	
2-010-I/C-A/T-TOR (Max 50W)			11 - Matte Nickel	
2-012-I/C-TOR (Max 50W)				
2-012-I/C-A/T-TOR (Max 50W)				
2-020-F (Max 50W)				
2-020-F-D/A (Max 50W)				
2-030-R (Max 50W)				
2-030-R-TOR (Max 50W) <sup>2</sup>				
2-060-F (Max 75W)	Note: 1) "No Housing" indicates use with a remote Class 2 transformer Transformer and R12S socket sold separately 2) Consult factory for availability			
2-060-F-D/A (Max 75W)				
2-060-F-D/A-TOR (Max 75W)				
2-060-F-C/P (Max 75W)				
2-100-C/H (Max 75W)				

\*Spec sheets are subject to change without notice