

Data and specifications subject to change without notice

Project name	Type
Order number	
Date	

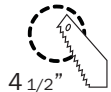
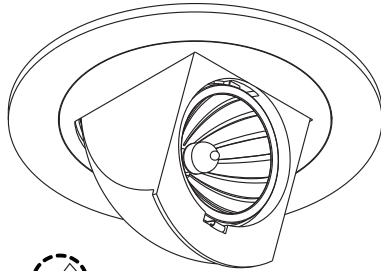

4 1/2" Round hole cutout

## SPLIT MR16 TRIM

### SPECIFICATIONS

The Split is designed to rotate 359° and features a pull down system that allows for up to 85° of vertical adjustability.

NOTE: Trim & Housing combination are designed for typical 5/8" drywall application, contact factory for various ceiling thickness.

- ◆ Made of die-cast aluminum
- ◆ Powder coated or plated finishes
- ◆ Lamp holder accepts 1 Split lens accessory
- ◆ Designed for non-cover glass MR16 lamp
- ◆ Clear glass lens included
- ◆ 50W or 75W maximum rating depending on the housing

Applications: Split trim can be used for highlighting, wall washing, grazing, sloped ceilings and straight down light applications.

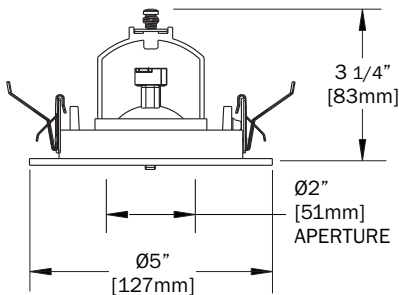

### ORDER GUIDE

HOUSING	VOLTAGE	TRIM	FINISH	OPTIONAL LENS
No Housing (Max 20W) <sup>1</sup>	120	2-200 Split	01 - White	SL - Softening Lens
2-010-I/C (Max 50W)	277		04 - Black	EL - Elongating Lens
2-010-I/C-A/T (Max 50W)	347 <sup>2</sup>		05 - Matte Silver	FRO - Frosted Lens
2-010-I/C-TOR (Max 50W)			06 - Bronze	PER-FRO - Perimeter Frosted Lens
2-010-I/C-A/T-TOR (Max 50W)			09 - Gold	SPDL - Spread Lens
2-012-I/C-TOR (Max 50W)			11 - Matte Nickel	
2-012-I/C-A/T-TOR (Max 50W)				
2-020-F (Max 50W)				
2-020-F-D/A (Max 50W)				
2-030-R (Max 50W)				
2-030-R-TOR (Max 50W) <sup>2</sup>				
2-060-F (Max 75W)				
2-060-F-D/A (Max 75W)				
2-060-F-D/A-TOR (Max 75W)				
2-060-F-C/P (Max 75W)				
2-100-C/H (Max 75W)				

Note:

- 1) "No Housing" indicates use with a remote Class 2 transformer  
Transformer and R12S socket sold separately
- 2) Consult factory for availability

\*Spec sheets are subject to change without notice