

Data and specifications subject to change without notice

Project name	Type
Order number	
Date	

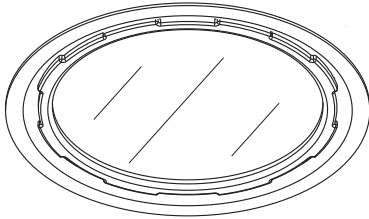

SUPER FLUSH SERIES



SPECIFICATIONS

Standard Features

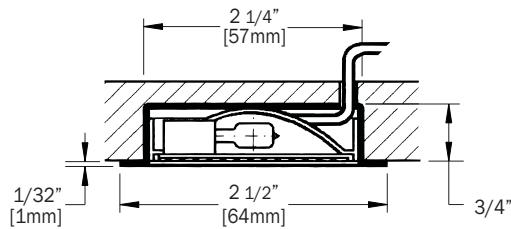
- ◆ Super Flush has a flange thickness of less than 1/32", making it the shallowest profile of any millwork luminaire on the market.
- ◆ Push fit Installation
- ◆ 6ft (2m) lead is standard, custom lead length available, contact factory
- ◆ Recommended hole cutout 2 1/4" (57mm)
- ◆ 10 or 20 Watt G4 bi-pin halogen lamp (Osram lamp included and installed)
- ◆ 10W is available with frosted lens, 20W is available with clear lens
- ◆ Approved for blind hole applications
- ◆ Certified as a stand alone luminaire



ORDER GUIDE

SERIES	WATTAGE	FINISH
520	129 - 10 Watts	01 - White
10W 20W	229 - 20 Watts	02 - Chrome
 		04 - Black
66° 32°		09 - Gold
		11 - Matte Nickel

Note:

- 1) All cabinet luminaires are to be powered with remote Class 2 transformers, sold separately
- 2) See transformer section for requirement

*Spec sheets are subject to change without notice

