

Type: **NZM2-XKS**
 Article No.: **260030**
 Sales text **Screw terminal 3pole**

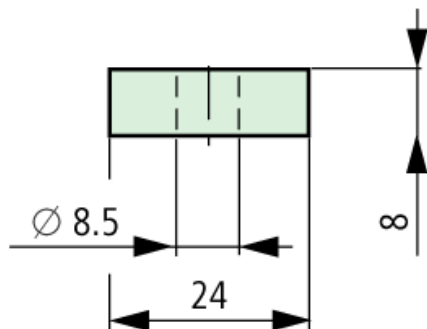

Ordering information			
For use with			
Motor rating AC-3 at 400 V 50/60 Hz			NZM2(-4), PN2(-4), N(S)2(-4)
Motor rating AC-3 at 400 V 50/60 Hz			Three- and four-pole
Terminal capacities			
Type of conductor			Copper cable lugs Aluminium cable lug
Terminal capacities		mm ²	1 × 4 – 185 2 × 4 – 70 1 × 10 – 50 2 × 10 – 50
AWG/kcmil		mm ²	1 × 11 – 3/0 2 × 12 1 × 8 – 1/0 2 × 8 – 1/0
Cu strip (number of segments × width × segment thickness)		mm ²	2 × 16 × 0.8
Copper busbar width × thickness	Width	mm	16 × 5

Space requirement



Notes concerning the product group

Type contains parts for a terminal located at top or bottom for 3 or 4 pole circuit-breakers.

Standard connection with all NZM2, PN2 and N2 circuit-breakers.

Conversion kit for circuit-breaker with box terminal.

Use special cable lug narrow version, 059775

Fitted within the switch housing

If a busbar is used, insulation (400 mm) e.g. sleeving and a NZM2(-4)-XKSA cover are required.

$U_e \approx 525 \text{ V AC}$:

- For all other connection material a NZM2(-4)-XKSA shroud must be used.

Dimensions

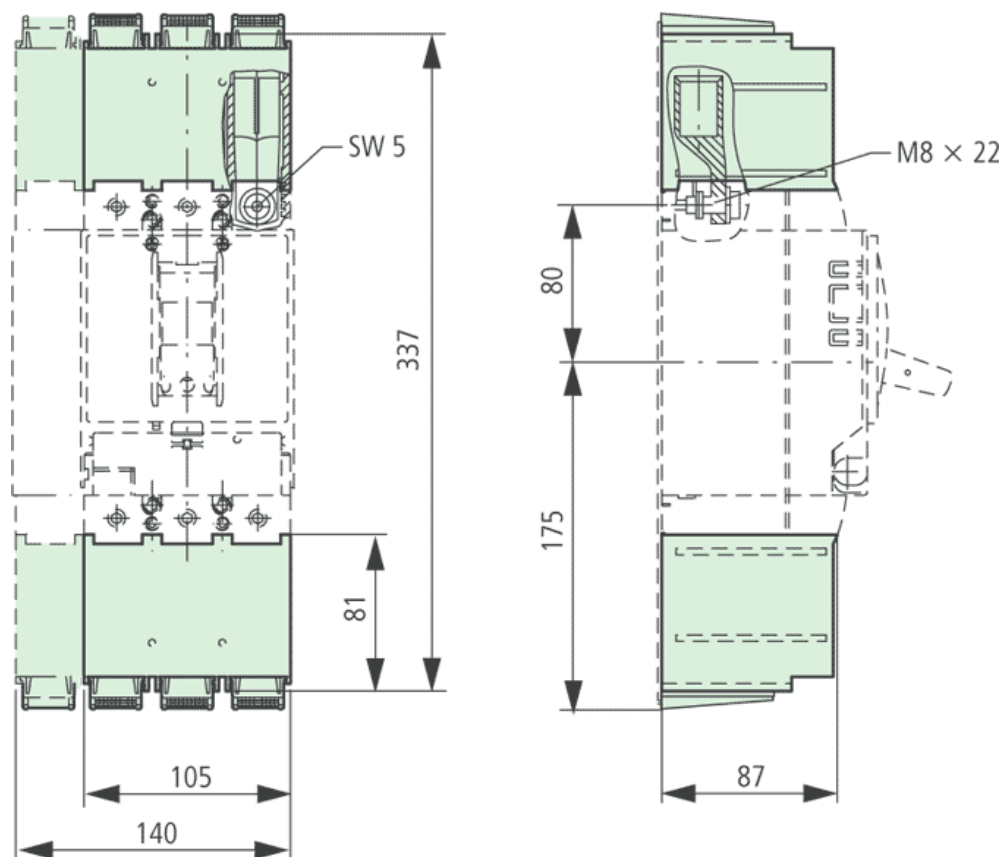

Moeller GmbH, Hein-Moeller-Str. 7-11, D-53115 Bonn
E-Mail: catalog@moeller.net, Internet: www.moeller.net, <http://catalog.moeller.net>
HPL-C2007G V2.1 © 2007 by Moeller GmbH