

FUWL-L

4 IN 1 LED FLOOD LIGHT/WALL PACK

87W (7127 lumens)

148W (12769 lumens)



Approvals:

cULus listed

Suitable for outdoor use.

DESCRIPTION

The newly designed and versatile FUWL-L is a highly efficient LED flood light and wall mount luminaire. This fixture is supplied with a wall bracket (for surface mounting), a wiring box (for feed-through mounting), a trunion (for flood mounting) and a slipfitter (for area lighting on a 2-3/8" tenon). This fixture is best suited for entrances, underpasses, or anywhere controlled security lighting is required, as well as general lighting of grounds, and floodlighting of signs and building fronts. The FUWL-L is made of tough die cast aluminum housing and is IP65 rated.

TECHNICAL SPECIFICATIONS

- Die Cast Aluminum housing
- Bronze UV resistant powder coat finish (standard)
- Input voltage: 120-277V AC or 347V AC
- High quality, long life LEDs
- Estimated lifespan of 50,000 hours
- 87W that offers 7127 total lumens
- 148W that offers 12769 total lumens
- 5000K color temperature
- Low starting temperature of -40°C

WEIGHT AND EPA

Weight

Fixture: 12.62 lbs

Slipfitter: 3.30 lbs

EPA

At 30°: 1.30 ft²



DIMENSIONS

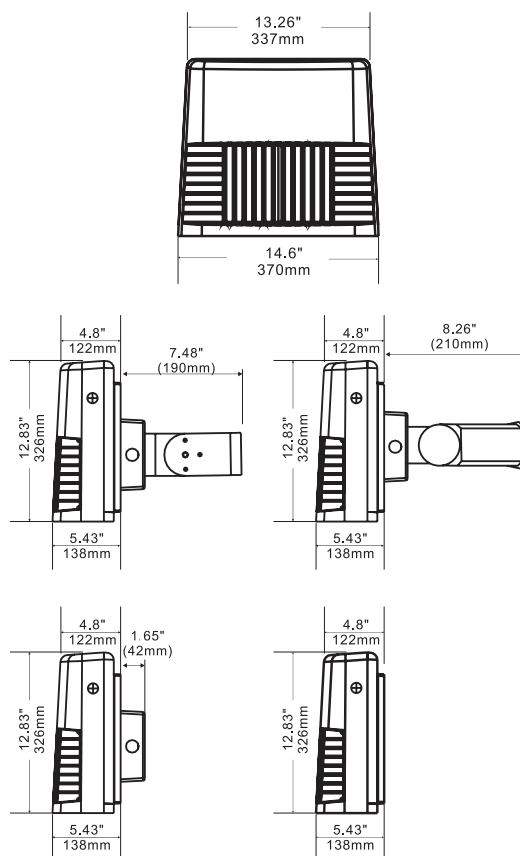

ORDERING GUIDE

FUWL	L			50K		
Series	Lamp type	Lumen package delivered	Voltage	Color temperature	Color	Options
FUWL	L - LED	S1 - 7127 Lumens (87W) S2 - 12769 Lumens (148W)	W - 120-277V H - 347V	50K - 5000K	Blank - Bronze (standard) WH - White SP - Special color	P_____ - Photocell (specify voltage)

DLC (Design-Lights Consortium®) qualified products. Please visit www.designlights.org/QPL to verify the latest update of the DLC Qualified Products List and validate which ones are qualified. Some restrictions may apply.