

NIR-NIRA



Surface or pendant mounting on stem or chain.

Individual or continuous row installation.

Reflectors available without or with apertures for uplight component.

Available for Rapid Start - Slimline - High Output lamps.

Baked white enamel finish.

58

NIR - LESS APERTURES

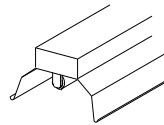

NIRA - WITH APERTURES

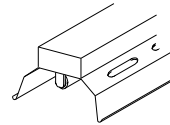

RAPID START / SLIMLINE LAMPS

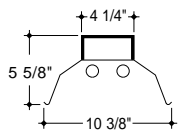
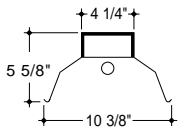

HIGH OUTPUT LAMPS

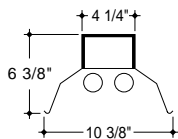
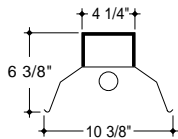

| | "L" | CAT. NO. | VOLTS* | BALLAST* | CAT. NO. | VOLTS* | BALLAST* |
|-----------------------|-----|---------------------|--------|----------|----------------------|--------|----------|
| 1-32 W/T8/RS | 4' | NIR-4-132- | 120 | ES | NIRA-4-132- | 120 | ES |
| 1-40 W/T12/RS | 4' | NIR-4-140- | 120 | ES | NIRA-4-140- | 120 | ES |
| 2-32 W/T8/RS (tan.) | 8' | NIR-8-232- | 120 | ES | NIRA-8-232- | 120 | ES |
| 2-40 W/T12/RS (tan.) | 8' | NIR-8-240- | 120 | ES | NIRA-8-240- | 120 | ES |
| 1-75 W/T12/SL | 8' | NIR-8-175- | 120 | STD | NIRA-8-175- | 120 | STD |
| 2-75 W/T12/SL (tan.) | 16' | NIR-16-275- | 120 | ES | NIRA-16-275- | 120 | ES |
| 2-32 W/T8/RS | 4' | NIR-4-232- | 120 | ES | NIRA-4-232- | 120 | ES |
| 2-40 W/T12/RS | 4' | NIR-4-240- | 120 | ES | NIRA-4-240- | 120 | ES |
| 4-32 W/T8/RS (tan.) | 8' | NIR-8-432- | 120 | ES | NIRA-8-432- | 120 | ES |
| 4-40 W/T12/RS (tan.) | 8' | NIR-8-440- | 120 | ES | NIRA-8-440- | 120 | ES |
| 2-75W/T12/SL | 8' | NIR-8-275- | 120 | ES | NIRA-8-275- | 120 | ES |
| 1-60 W/T12/HO | 4' | NIR-4-160- | 120 | STD | NIRA-4-160- | 120 | STD |
| 2-60 W/T12/HO (tan.) | 8' | NIR-8-260- | 120 | STD | NIRA-8-260- | 120 | STD |
| 1-110 W/T12/HO | 8' | NIR-8-1110- | 120 | ES | NIRA-8-1110- | 120 | ES |
| 2-110 W/T12/HO (tan.) | 16' | NIR-16-2110- | 120 | ES | NIRA-16-2110- | 120 | ES |
| 2-60 W/T12/HO | 4' | NIR-4-260- | 120 | STD | NIRA-4-260- | 120 | STD |
| 2-110 W/T12/HO | 8' | NIR-8-2110- | 120 | ES | NIRA-8-2110- | 120 | ES |

*VOLTS *BALLAST
 | |
 120 ES = ENERGY SAVING
 277 EL = ELECTRONIC
 347 STD = STANDARD

HT SPECULAR
 see page 17

ORDERING EX: CAT. NO. = NIR-4-240-120-ES