

Cushion-Grip Screwdrivers

Conduit-Fitting and Reaming Screwdriver

Additional Features:

- Hooded-blade design keeps tip from slipping out of screws, especially when tightening hard-to-reach conduit fittings. Thicker hood is designed for rugged use.
- Reams and smooths 1/2" (13 mm), 3/4" (19 mm), and 1" (25 mm) thin-wall conduit ends to protect wire and permit correct installation of fittings.
- Reams both the inside and outside of the conduit at the same time.
- Longer Cushion-Grip handle provides comfort and more torque for reaming.
- Replaceable reaming blade is now held in place with a 1/16" set screw.



85191

| Cat. No. | Tip Size | Shank Length | Overall Length | Weight (lbs.) |
|----------|--------------------------------------|----------------|-----------------|---------------|
| 85191 | 5/16" (8 mm) | 2-1/2" (64 mm) | 7-1/2" (191 mm) | .50 |
| 19353 | conduit reamer replacement blade kit | | | .01 |

Conduit Reamer

- Locks onto screwdrivers; reams and smooths thin-wall conduit.
- Reams ID and OD at the same time.
- Two set-screws for round- and square-shank screwdrivers.



19352

| Cat. No. | Conduit Capacity | Weight (lbs.) |
|----------|--|---------------|
| 19352 | 1/2", 3/4", 1" | .20 |
| 19353 | conduit reamer replacement blade kit for 19352 | .01 |
| 19351 | conduit reamer replacement blade for 19350 | .01 |

- Fits up to 3/8" (10 mm) keystone-tip screwdrivers.
- NOT for use on power tools.

Rapi-Driv® Screwdrivers

Cabinet-Tip Screwdrivers – Rapi-Driv®

Additional Features:

- Crank-action handle spins screws fast with one hand.
- Saves time and effort, especially on long-threaded screws in switch plates, light fixtures, etc.

| Cat. No. | Tip Size | Shank Length | Overall Length | Weight (lbs.) |
|----------|--------------|--------------|-----------------|---------------|
| 670-3 | 3/16" (5 mm) | 4" (102 mm) | 7-3/4" (197 mm) | .15 |
| 670-6 | 3/16" (5 mm) | 6" (152 mm) | 9-3/4" (248 mm) | .20 |
| 671-6 | 1/4" (6 mm) | 6" (152 mm) | 9-3/4" (248 mm) | .20 |



670-6

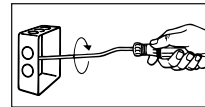

Phillips Screwdrivers – Rapi-Driv®

Additional Features:

- Crank-action handle spins screws fast with one hand.
- Saves time and effort, especially on long-threaded screws in switch plates, light fixtures, etc.

| Cat. No. | Tip Size | Shank Length | Overall Length | Weight (lbs.) |
|----------|----------|--------------|-----------------|---------------|
| 681-6 | No. 1 | 6" (152 mm) | 9-3/4" (248 mm) | .20 |
| 682-6 | No. 2 | 6" (152 mm) | 9-3/4" (248 mm) | .25 |



682-6

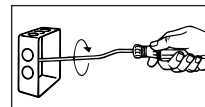

Square-Recess Screwdrivers – Rapi-Driv®

Additional Features:

- Crank-action handle spins screws fast with one hand.
- Color-coded handle ends for quick and easy identification.

| Cat. No. | Tip Size | Shank Length | Overall Length | Weight (lbs.) |
|----------|----------|--------------|-----------------|---------------|
| 691-6 | No. 1 | 6" (152 mm) | 9-3/4" (248 mm) | .35 |
| 692-6 | No. 2 | 6" (152 mm) | 9-3/4" (248 mm) | .35 |



692-6

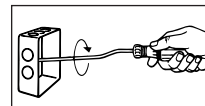

All dimensions are in inches and (millimeters).

WARNING: Always wear approved eye protection.

WARNING: NOT insulated. Will NOT protect against electrical shock.

WARNING: Do NOT use to pry or chisel.

