

## IPS SW DOUBLE BELL COUPLING

Size		Symbol	$\varnothing C$	D	L	$\varnothing C$	D	L
in	mm	No.	inches			millimeters		
¾	21	10-7510	1.086	0.066	9.750	27.6	1.7	247.7
1	27	10-1010	1.351	0.066	9.750	34.3	1.7	247.7
1¼	35	10-1210	1.698	0.066	9.750	43.1	1.7	247.7
1½	41	10-1510	1.938	0.066	9.750	49.2	1.7	247.7
2	53	10-2010	2.417	0.070	10.250	61.4	1.8	260.4
3	78	10-3010	3.542	0.070	10.250	90.0	1.8	260.4
4	103	10-4010	4.542	0.070	10.250	115.4	1.8	260.4
5	129	10-5010	5.610	0.095	10.250	142.5	2.4	260.4
6	155	10-6010	6.669	0.110	10.250	169.4	2.8	260.4
8❖	203	10-8010	8.667	0.115	10.250	220.1	2.9	260.4

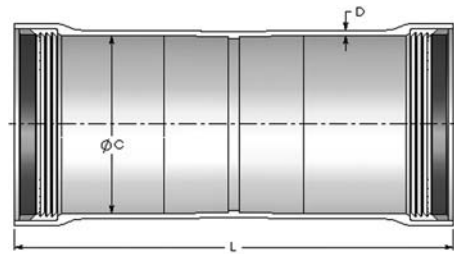

## IPS SW 5° DOUBLE BELL COUPLING

Size		Symbol	$\varnothing C$	D	L	$\varnothing C$	D	L
in	mm	No.	inches			millimeters		
¾	21	10-7511	1.086	0.066	0.125	27.6	1.7	3.2
1	27	10-1011	1.351	0.066	0.125	34.3	1.7	3.2
1¼	35	10-1211	1.698	0.066	0.125	43.1	1.7	3.2
1½	41	10-1511	1.938	0.066	0.125	49.2	1.7	3.2
2	53	10-2011	2.417	0.070	0.125	61.4	1.8	3.2
3	78	10-3011	3.542	0.070	0.125	90.0	1.8	3.2
4	103	10-4011	4.542	0.070	0.125	115.4	1.8	3.2
5	129	10-5011	5.610	0.095	0.125	142.5	2.4	3.2
6	155	10-6011	6.669	0.110	0.125	169.4	2.8	3.2
8❖	203	10-8011	8.667	0.115	0.125	220.1	2.9	3.2

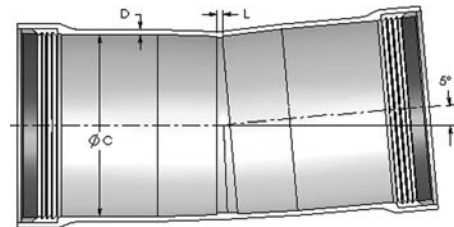

## IPS SW SLEEVE

Size		Symbol	$\varnothing C$	D	L	$\varnothing C$	D	L
in	mm	No.	inches			millimeters		
¾	21	10-7516	1.086	0.066	12	27.6	1.7	304.8
1	27	10-1016	1.351	0.066	12	34.3	1.7	304.8
1¼	35	10-1216	1.698	0.066	12	43.1	1.7	304.8
1½	41	10-1516	1.938	0.066	12	49.2	1.7	304.8
2	53	10-2016	2.417	0.070	12	61.4	1.8	304.8
3	78	10-3016	3.542	0.070	12	90.0	1.8	304.8
4	103	10-4016	4.542	0.070	12	115.4	1.8	304.8
5	129	10-5016	5.610	0.095	12	142.5	2.4	304.8
6	155	10-6016	6.669	0.110	12	169.4	2.8	304.8
8❖	203	10-8016	8.667	0.115	12	220.1	2.9	304.8

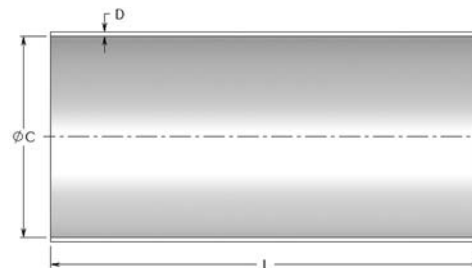

❖ Not UL Listed, CSA Certified or NEMA compliant.

