

COMMERCIAL & INDUSTRIAL UNIT HEATER

SHU SERIES

THE POWER OF DISPERSION

°STELPRO designs heaters for all circumstances. Take the SHU, the large volume heater that is distinguished by its appealing appearance, its manufacturing and its sturdy composition. It is usually installed in large garages, but it is not uncommon for it to be seen in warehouses or any other kind of commercial construction site requiring a generous volume of heat. The SHU works with great ease and has an incredible power scale from 2 kW to 60 kW. What could be better!



INSTANT HEAT

PERMANENTLY LUBRICATED MOTOR

WIDE RANGE OF POWER: 2 KW TO 60 KW

THERMALLY PROTECTED

WALL OR CEILING INSTALLATION

BRACKET INCLUDED

IDEAL FOR:

WAREHOUSE, FACTORY, INDOOR PARKING GARAGE, LARGE INDUSTRIAL AND COMMERCIAL AREAS

COLOUR

textured charcoal

FINISH

epoxy-polyester powdercoat

MANUFACTURING

- heavy-duty, 18-gauge steel cabinet
- adjustable louvers and protective screen
- thermal protection with automatic reset

MOTOR

permanently enclosed lubricated ball bearing motor for long-lasting operation

ELEMENT

nichrome element produces instant heat

CONTROL

connection of multiple units to the same thermostat is possible with a relay kit without transformer (optional) and an external transformer (not provided)

INSTALLATION

- wall or ceiling mounted with universal mounting bracket (included)
- minimum distance from adjacent walls: 6 in. (2 kW to 30 kW units), 12 in. (40 kW to 60 kW units)
- maximum mounting heights: 8 ft. (2 kW to 10 kW units), 10 ft. (15 kW to 30 kW units), 15 ft. (40 kW to 60 kW units)

ACCESSORIES

PRODUCT	DESCRIPTION	PRICE
SHUT1	built-in single pole thermostat (capillary)	62.50
SHUT2	built-in double pole thermostat (capillary)	74.50
SHUFS*	fan switch	55.75
SHUDIS*	disconnect switch [80 A]	155.00
SHUC24RX*	relay kit without transformer 24 V	95.50
SHUFS-RCV	remote control circuit for ventilation mode 240 V	55.75

* Factory installed

TECHNICAL SPECIFICATIONS

WITHOUT CONTROL		BUILT-IN THERMOSTAT		240 V CONTROL		24 V CONTROL		VOLTS	KW	CFM
CODE	PRICE	CODE	PRICE	CODE	PRICE	CODE	PRICE			
SHU0281	854.00	SHU0281T	915.00	SHU0281C	927.00	SHU0281C24	965.00	208	2	250
---	---	SHU0283CT*	989.00	SHU0283C*	927.00	SHU0283C24*	965.00	208	2	250
SHU0221	854.00	SHU0221T	915.00	SHU0221C	927.00	SHU0221C24	965.00	240	2	250
SHU0271	1022.00	SHU0271T	1085.00	SHU0271C	1097.00	SHU0271C24	1134.00	277	2	250
---	---	SHU0231CT	1158.00	SHU0231C	1097.00	SHU0231C24	1134.00	347	2	250
---	---	SHU0251CT	1158.00	SHU0251C	1097.00	SHU0251C24	1134.00	480	2	250
---	---	SHU0253CT*	1158.00	SHU0253C*	1097.00	SHU0253C24*	1134.00	480	2	250
---	---	SHU0261CT	1158.00	SHU0261C	1097.00	SHU0261C24	1134.00	600	2	250
---	---	SHU0263CT*	1158.00	SHU0263C*	1097.00	SHU0263C24*	1134.00	600	2	250
SHU0381	854.00	SHU0381T	915.00	SHU0381C	927.00	SHU0381C24	965.00	208	3	250
---	---	SHU0383CT*	989.00	SHU0383C*	927.00	SHU0383C24*	965.00	208	3	250
SHU0321	854.00	SHU0321T	915.00	SHU0321C	927.00	SHU0321C24	965.00	240	3	250
SHU0371	1057.00	SHU0371T	1119.00	SHU0371C	1132.00	SHU0371C24	1169.00	277	3	250
---	---	SHU0331CT	1193.00	SHU0331C	1132.00	SHU0331C24	1169.00	347	3	250
---	---	SHU0351CT	1193.00	SHU0351C	1132.00	SHU0351C24	1169.00	480	3	250
---	---	SHU0353CT*	1193.00	SHU0353C*	1132.00	SHU0353C24*	1169.00	480	3	250
---	---	SHU0361CT	1193.00	SHU0361C	1132.00	SHU0361C24	1169.00	600	3	250
---	---	SHU0363CT*	1193.00	SHU0363C*	1132.00	SHU0363C24*	1169.00	600	3	250
SHU0481	862.00	SHU0481T	924.00	SHU0481C	935.00	SHU0481C24	974.00	208	4	250
---	---	SHU0483CT*	998.00	SHU0483C*	935.00	SHU0483C24*	974.00	208	4	250
SHU0421	862.00	SHU0421T	924.00	SHU0421C	935.00	SHU0421C24	974.00	240	4	250
SHU0471	1085.00	SHU0471T	1146.00	SHU0471C	1158.00	SHU0471C24	1196.00	277	4	250
---	---	SHU0431CT	1221.00	SHU0431C	1158.00	SHU0431C24	1196.00	347	4	250
---	---	SHU0451CT	1221.00	SHU0451C	1158.00	SHU0451C24	1196.00	480	4	250
---	---	SHU0453CT*	1221.00	SHU0453C*	1158.00	SHU0453C24*	1196.00	480	4	250
---	---	SHU0461CT	1221.00	SHU0461C	1158.00	SHU0461C24	1196.00	600	4	250
---	---	SHU0463CT*	1221.00	SHU0463C*	1158.00	SHU0463C24*	1196.00	600	4	250
---	---	SHU0581T	1064.00	SHU0581C	1076.00	SHU0581C24	1112.00	208	5	450
---	---	SHU0583CT*	1138.00	SHU0583C*	1076.00	SHU0583C24*	1112.00	208	5	450
SHU0521	1001.00	SHU0521T	1064.00	SHU0521C	1076.00	SHU0521C24	1112.00	240	5	450
SHU0571	1124.00	SHU0571T	1186.00	SHU0571C	1198.00	SHU0571C24	1235.00	277	5	450
---	---	SHU0531CT	1260.00	SHU0531C	1198.00	SHU0531C24	1235.00	347	5	450
---	---	SHU0551CT	1260.00	SHU0551C	1198.00	SHU0551C24	1235.00	480	5	450
---	---	SHU0553CT*	1260.00	SHU0553C*	1198.00	SHU0553C24*	1235.00	480	5	450
---	---	SHU0561CT	1260.00	SHU0561C	1198.00	SHU0561C24	1235.00	600	5	450
---	---	SHU0563CT*	1261.00	SHU0563C*	1198.00	SHU0563C24*	1235.00	600	5	450
---	---	SHU0781CT	1602.00	SHU0781C	1541.00	SHU0781C24	1578.00	208	7.5	700
---	---	SHU0783CT*	1602.00	SHU0783C*	1541.00	SHU0783C24*	1578.00	208	7.5	700
---	---	SHU0721CT	1602.00	SHU0721C	1541.00	SHU0721C24	1578.00	240	7.5	700
---	---	SHU0771CT	1799.00	SHU0771C	1737.00	SHU0771C24	1775.00	277	7.5	700
---	---	SHU0731CT	1799.00	SHU0731C	1737.00	SHU0731C24	1775.00	347	7.5	700
---	---	SHU0751CT	1799.00	SHU0751C	1737.00	SHU0751C24	1775.00	480	7.5	700
---	---	SHU0753CT*	1799.00	SHU0753C*	1737.00	SHU0753C24*	1775.00	480	7.5	700
---	---	SHU0761CT	1799.00	SHU0761C	1737.00	SHU0761C24	1775.00	600	7.5	700
---	---	SHU0763CT*	1799.00	SHU0763C*	1737.00	SHU0763C24*	1775.00	600	7.5	700

* Three-phase unit that can be field-converted to a single phase unit
 * Three-phase unit
 --- not available

THROW DISTANCE AND HEAT RISE

UNITS	THROW DISTANCE		HEAT RISE		
	KW	M	FT.	°C	°F
2		8.5	28	17	31
3		8.5	28	35	62
4		8.5	28	52	93
5		9.4	31	55	99
7.5		9.4	31	54	97
10		9.4	31	85	153
15		10.7	35	52	93
20		11.3	37	89	160
25		10.2	33'6"	133	240
30		10.7	35	135	243
40		10.7	35	132	237
50		10.7	35	141	254
60		10.7	35	156	280

TECHNICAL DRAWINGS

2 KW TO 10 KW UNITS

weight: approx. 40 lb (18 kg)

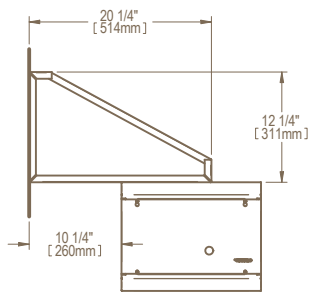

LEFT SIDE

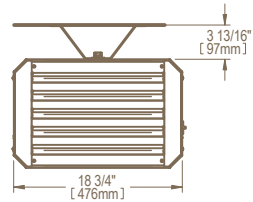

FRONT

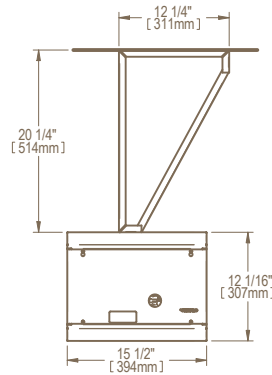

RIGHT SIDE

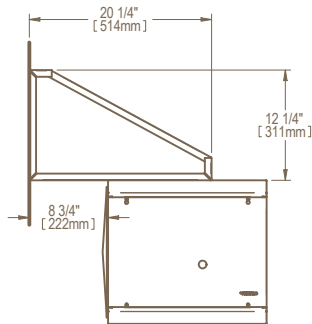

LEFT SIDE

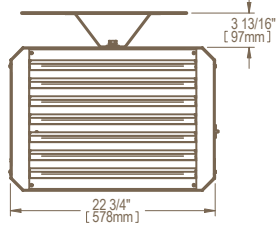

FRONT

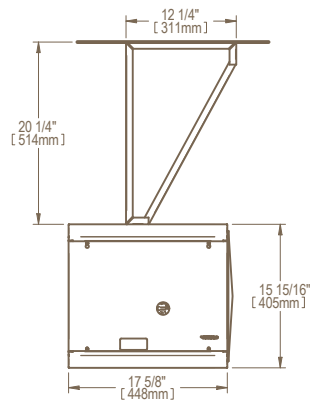

RIGHT SIDE

15 KW TO 30 KW UNITS

weight: approx. 67 lb (30 kg)

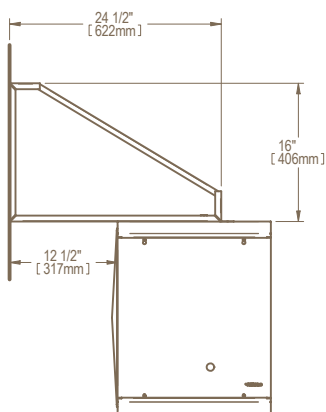

LEFT SIDE

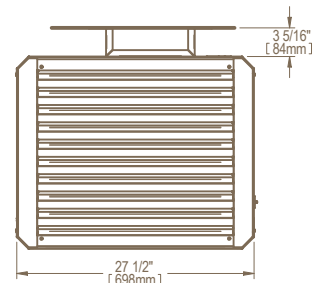

FRONT

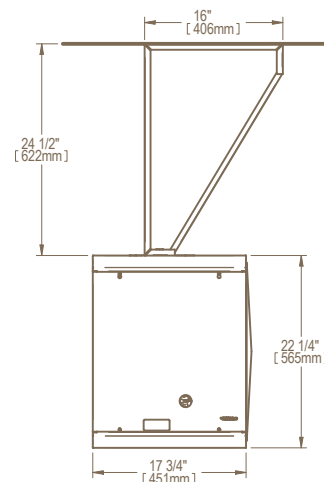

RIGHT SIDE

40 KW TO 60 KW UNITS

weight: approx. 100 lb (45 kg)

