



OVERLOAD RELAY 34...40 A FOR MOTOR PROTECTION SZ S0, CLASS 10, F. MOUNTING ONTO CONTACTOR MAIN CIRCUIT: SPRING TERMINAL AUX. CIRCUIT: SPRING TERMINAL MANUAL-AUTOMATIC-RESET

| | |
|---|-----------------------------|
| product brand name | SIRIUS |
| Product designation | 3RU2 thermal overload relay |
| General technical data: | |
| Size of contactor can be combined company-specific | S0 |
| Active power loss total typical | 7.5 W |
| Insulation voltage | |
| • with degree of pollution 3 Rated value | 690 V |
| Surge voltage resistance Rated value | 6 kV |
| Protection class IP | |
| • on the front | IP20 |
| • of the terminal | IP20 |
| Temperature compensation | -40 ... +60 °C |
| Type of assignment | 2 |
| Ambient conditions: | |
| Installation altitude at height above sea level maximum | 2 000 m |
| Ambient temperature | |
| • during operation | -40 ... +70 °C |
| • during storage | -55 ... +80 °C |
| • during transport | -55 ... +80 °C |
| Relative humidity during operation | 0 ... 90 % |
| Main circuit: | |
| Adjustable response value current of the current-dependent overload release | 34 ... 40 A |
| Operating voltage | |

| | |
|---|--------------|
| <ul style="list-style-type: none"> • Rated value | 690 V |
| <ul style="list-style-type: none"> • at AC-3 Rated value maximum | 690 V |
| Operating frequency Rated value | 50 ... 60 Hz |
| Operating current Rated value | 40 A |
| Operating current | |
| <ul style="list-style-type: none"> • at AC-3 — at 400 V Rated value | 40 A |

Auxiliary circuit:

| | |
|---|--|
| Number of NC contacts | |
| <ul style="list-style-type: none"> • for auxiliary contacts — Note | 1 for contactor disconnection |
| Number of NO contacts | |
| <ul style="list-style-type: none"> • for auxiliary contacts — Note | 1 for message "Tripped" |
| Number of CO contacts | |
| <ul style="list-style-type: none"> • for auxiliary contacts | 0 |
| Design of the auxiliary switch | integrated |
| Operating current of the auxiliary contacts at AC-15 | |
| <ul style="list-style-type: none"> • at 24 V • at 110 V • at 120 V • at 125 V • at 230 V • at 400 V | 3 A 3 A 3 A 3 A 2 A 1 A |
| Operating current of the auxiliary contacts at DC-13 | |
| <ul style="list-style-type: none"> • at 24 V • at 110 V • at 125 V • at 220 V | 2 A 0.22 A 0.22 A 0.11 A |

Protective and monitoring functions:

| | |
|---|----------|
| Trip class | CLASS 10 |
| Design of the overload circuit breaker | thermal |

UL/CSA ratings:

| | |
|--|--------------|
| Full-load current (FLA) for three-phase AC motor | |
| <ul style="list-style-type: none"> • at 480 V Rated value • at 600 V Rated value | 40 A 40 A |
| Contact rating of the auxiliary contacts acc. to UL | B600 / R300 |

Installation/ mounting/ dimensions:

| | |
|--------------------------|-----------------|
| mounting position | any |
| Mounting type | direct mounting |

| | |
|---|--------|
| Height | 102 mm |
| Width | 45 mm |
| Depth | 84 mm |
| Required spacing | |
| <ul style="list-style-type: none"> • with side-by-side mounting <ul style="list-style-type: none"> — forwards 0 mm — Backwards 0 mm — upwards 6 mm — downwards 6 mm — at the side 6 mm • for grounded parts <ul style="list-style-type: none"> — forwards 0 mm — Backwards 0 mm — upwards 6 mm — at the side 6 mm — downwards 6 mm • for live parts <ul style="list-style-type: none"> — forwards 0 mm — Backwards 0 mm — upwards 6 mm — downwards 6 mm — at the side 6 mm | |

| Connections/ Terminals: | |
|---|--|
| Product function | |
| <ul style="list-style-type: none"> • removable terminal for auxiliary and control circuit | No |
| Type of electrical connection | |
| <ul style="list-style-type: none"> • for main current circuit • for auxiliary and control current circuit | spring-loaded terminals spring-loaded terminals |
| Arrangement of electrical connectors for main current circuit | Top and bottom |
| Type of connectable conductor cross-section | |
| <ul style="list-style-type: none"> • for main contacts <ul style="list-style-type: none"> — single or multi-stranded 1x (1 ... 10 mm²) — finely stranded with core end processing 1x (1 ... 6 mm²) — finely stranded without core end processing 1x (1 ... 6 mm²) • for AWG conductors for main contacts 1x (18 ... 8) | |
| Type of connectable conductor cross-section | |
| <ul style="list-style-type: none"> • for auxiliary contacts <ul style="list-style-type: none"> — single or multi-stranded 2x (0,5 ... 2,5 mm²) — finely stranded with core end processing 2x (0.5 ... 1.5 mm²), 2x (0.75 ... 2.5 mm²) | |

— finely stranded without core end processing

2x (0.5 ... 1.5 mm²)

- for AWG conductors for auxiliary contacts

2x (20 ... 14)

Design of screwdriver shaft

5 to 6 mm diameter

Safety related data:

Proportion of dangerous failures

- with low demand rate acc. to SN 31920
- with high demand rate acc. to SN 31920

50 %
50 %

MTTF with high demand rate

2 280 y

T1 value for proof test interval or service life acc. to IEC 61508

20 y

Mechanical data:

Size of overload relay

S0

Display:

Display version

- for switching status

Slide switch

Certificates/ approvals:

| General Product Approval | For use in hazardous locations | Declaration of Conformity |
|--------------------------|--------------------------------|---------------------------|
|--------------------------|--------------------------------|---------------------------|



| Test Certificates | Shipping Approval |
|-------------------|-------------------|
|-------------------|-------------------|

[Typprüfbescheinigung/Werkzeugnis](#)

[spezielle Prüfbescheinigung](#)
[n](#)



| Shipping Approval | other |
|-------------------|-------|
|-------------------|-------|



[Umweltbestätigung](#)

Further information

Information- and Downloadcenter (Catalogs, Brochures,...)

<http://www.siemens.com/industrial-controls/catalogs>

Industry Mall (Online ordering system)

<http://www.siemens.com/industrymall>

Cax online generator

<http://support.automation.siemens.com/WW/CAXorder/default.aspx?lang=en&mlfb=3RU21264FC0>

Service&Support (Manuals, Certificates, Characteristics, FAQs,...)

<https://support.industry.siemens.com/cs/ww/en/ps/3RU21264FC0>

Image database (product images, 2D dimension drawings, 3D models, device circuit diagrams, EPLAN macros, ...)

http://www.automation.siemens.com/bilddb/cax_de.aspx?mlfb=3RU21264FC0&lang=en

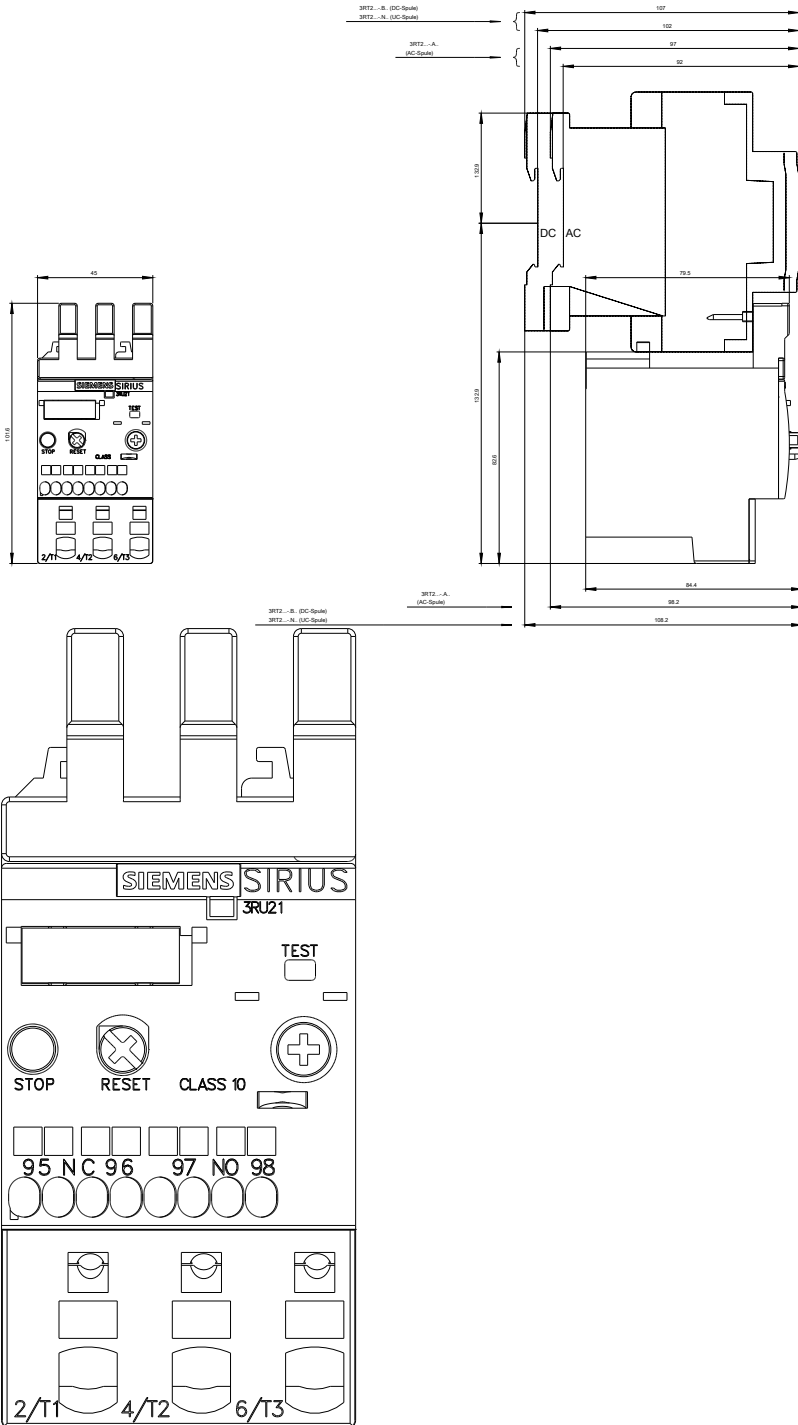

~~MEMBER: 3RU2126-4FC0~~ AIS FUER

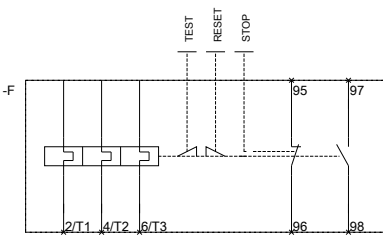

last modified:

29.06.2015

~~MEMBER: 3RU2126-4FC0~~ AIS FUER