

# ECS Selector Switch Control Stations

## Explosionproof, Dust-Ignitionproof, Factory Sealed and Non-Factory Sealed

### CEC:

Class I, Division 1 and 2, Groups B, C, D  
Class II, Division 1 and 2, Groups E, F, G  
Class III  
CSA Type 3R, 7BCD, 9EFG

### Applications

- Push buttons and selector switches are used in conjunction with contactors and magnetic starters for remote control of motors. They provide circuit control and selection.
- Pilot lights provide visual indication that an electrical circuit is engaged either at a remote or local location.
- Toggle switches are used to connect or disconnect electrical operating lighting or other low power loads.

### Features

- Corrosion resistant captive stainless steel hex head bolts hold cover to body.
- Dozens of possible combinations of push buttons, selector switches and pilot lights. Contact your local sales representative for combinations not found in the catalog.
- Push buttons supplied standard with neoprene weather boot.
- Clearly marked terminals with brass screws assure quick, easy wiring.
- Push buttons and selector switches employ heavy duty, 10 Amp 600 Vac rated contact blocks.
- Push button and selector switch contacts are silver cadmium oxide assuring long trouble free operation.
- Pilot Lights are supplied with jewel guard and 120 Vac lamp.
- Factory sealed push buttons are supplied with lockout type guards. Hole in guard locks with up to 1/4" hasp. Permits locking of push button to prevent unauthorized operation.
- Factory sealed control stations confine the arcing to the devices within the enclosure. Eliminates the need for adding external sealing fittings at each conduit entry. (Non-factory sealed devices available, contact your local sales representative.)
- Smooth rounded integral bushing in hub protects conductor insulation.
- Accurately tapped, tapered hubs for tight, rigid joints and ground continuity.
- Temperature rating: T6

### Standard Materials

- Cover: aluminum alloy
- Body: cast copperfree (4/10 of 1% max.) aluminum
- Push buttons: aluminum upper barrel and phelonic lower barrel
- Dust cap models: neoprene buttons
- Pilot light guard and body assembly: aluminum and tempered glass jewel
- Clamping ring: steel
- Selector switch: aluminum operator mechanism and nylon cam

### Standard Finishes

- Body and cover: baked epoxy paint
- Operators: natural finish

### Options

- LED pilot light available. Substitute **J** in catalog number with **L**.
- Three position selector switches with modified operation.
  - Momentary contact right position, spring return to center, maintained contact left position. Add suffix —**S634**.
  - Momentary contact left position, spring return to center, maintained contact right position. Add suffix —**S635**.
- Selector switch lockout for factory sealed units locks two or three position handle in any position. Add suffix —**S349**.



1-Gang — Start and Stop

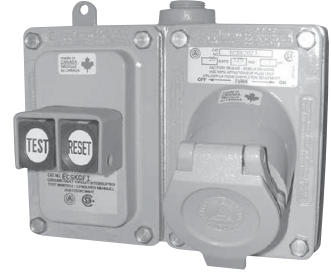

2-Gang — GFCI and Receptacle

- Pilot light jewel/guard assembly, order by suffixes:
  - Red —**JR**
  - Amber —**JA**
  - Blue —**JB**
  - Clear —**JC**
  - Green —**JG**
  - Opal —**JO**
- For colored LED jewel/guard assembly, order by suffixes:
  - Red —**LR**
  - Amber —**LA**
  - Blue —**LB**
  - Clear —**LC**
  - Green —**LG**
  - Opal —**LO**
- Securing rod for push button factory sealed units. Add suffix —**S153**.
- CSA Type 4X enclosure and cover. Add suffix —**4X**.

### CEC Certifications and Compliances

- CSA Standards: CSA C22.2 No. 25, CSA C22.2 No. 30, CSA C22.2 No. 14-M
- CSA Certified: 038339

# ECS Selector Switch Control Stations

Explosionproof, Dust-Ignitionproof, Factory Sealed and Non-Factory Sealed

**CEC:**

Class I, Division 1 and 2, Groups B, C, D  
 Class II, Division 1 and 2, Groups E, F, G  
 Class III  
 CSA Type 3R, 7BCD, 9EFG

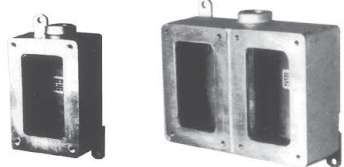
Hub Size (Inches)	Description	Catalog Number	
<b>ECS Series Mounting Boxes</b>			
CSA Certified when complete with ECKS cover assembly. Boxes and covers sold separately. Boxes are complete with feed-thru hubs, mounting feet, ground screw and close-up plug for dead-end use. For 1/2" entry on ECS-172 and ECS-275 reducer required.			
	3/4	1-Gang	<b>ECS175</b>
	1	1-Gang	<b>ECS110</b>
	3/4	2-Gang	<b>ECS275</b>
	1	2-Gang	<b>ECS210</b>

Description	Catalog Number
<b>ECS Replacement Covers</b>	
Blank Cover	<b>ECSKB</b>
1 Device Cover	<b>ECSK1B</b>
2 Device Cover	<b>ECSK2B</b>
Dual Push button/Selector Switch Cover	<b>ECSK2P</b>
Pilot Light and Dual Push button/Selector Switch Cover	<b>ECSK3P</b>

**Dimensions in Millimeters (Inches)**

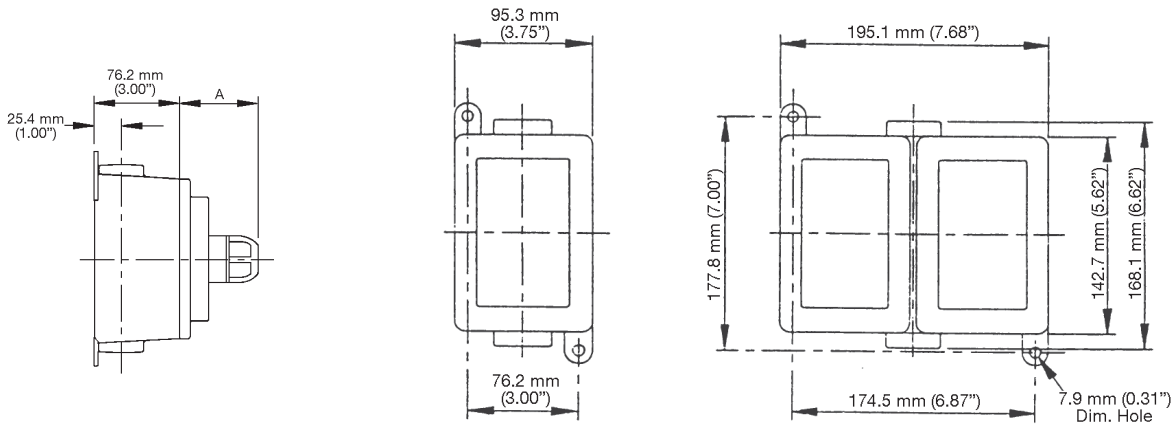

Device	A — Dimensions in Millimeters (Inches)
Push Button Switch	45.0 (1.81)
Selector Switch	57.2 (2.25)
Pilot Light	69.9 (2.75)
Mushroom Head Switch	56.4 (2.18)
Snap Switch	39.6 (1.56)
GFI	41.1 (1.62)
Photocontrol	53.8 (2.12)



CONTROLS: NEC/CEC EXPLOSIONPROOF CONTROL STATIONS AND SWITCHES

