

Finishes and Materials

Finishes on Steel

Bare (Suffix BC)

Pregalvanized (Suffix PGC)

A zinc coating is applied to the steel coil at the mill prior to fabrication. Once the material is worked by roll-forming, cutting, or punching, minimal protection is provided for raw edges. This weakness is typical with precoated material and affects the channel section around holes, extreme ends, and the edges of the U-shape lips. Superstrut® pregalvanized material is in conformance with ASTM A-525/G-90 specification standards, representing 0.90 oz. of zinc per square foot of steel. This finish is often referred to as “mill galvanized.”

Electrogalvanized (Suffix EGC)

Often referred to as “zinc plated” or “electroplated zinc,” the steel and 0.5 mils of zinc are bonded by an electrolysis process. Electrogalvanizing is most commonly applied to small fittings, hardware, and threaded products.

GoldGalv® (No Suffix)

Gold coloured zinc dichromate is applied over the zinc, producing a chemically bonded non porous barrier for protection from moisture and air. This extends the protective life of the zinc, and provides an excellent base for paint, if desired. The GoldGalv® hardware finish also provides a low electrical resistance when grounding of the system is required. Superstrut® channel and fittings are plated after fabrication, so there are no unprotected edges from cutting or punching. Where field cutting is necessary or scratches occur due to construction handling, you still have the sacrificial protection of the plated zinc to minimize the corrosion of raw edges and prevent spreading.

Hot-Dipped Galvanized (Suffix HDGC)

The material is zinc coated after fabrication providing total product protection on all surfaces. The fabricated channel or fitting is suspended and then dipped into tanks of hot zinc for a prolonged period, creating a coherent bond. The result is superior corrosion resistance as compared to pregalvanized material. Hot-dipped galvanizing is not recommended for threaded products, considering the zinc coating thickness will often disrupt the threads. Superstrut® hot-dipped galvanized is in conformance with ASTM Specifications A-123 (formerly A-386) and A-153. Superstrut channels maintain a minimum 1.5 oz. of zinc per square foot of steel or 2.5 mils (ASTM A-123, Thickness Grade 65). This finish is also referred to as “Hot-dipped galvanized after fabrication”.

Epoxy Powder Coated — Green, Grey or White (Suffix GR, GY or WH)

Epoxy powder resins are applied electrostatically to the steel after fabrication. Once the material is completely covered with the powder-form epoxy, it proceeds through a 400°F (204°C) baking process for ten minutes, creating a chemical bond. This results in a minimum of 1.5 mil thickness of epoxy coating providing excellent resistance to chipping or peeling.

Special Materials

Aluminum (Suffix ALC)

Superstrut® channel is available in aluminum. Fittings in HDG finish or fiberglass material are suggested for fastening products.

Stainless Steel (Suffix SS)

Superstrut® channel is supplied in Type 316 (T316L) stainless steel. All fittings and accessories are in 316SS (SS6). Contact your Regional Sales Office for availability.

Thomas & Betts reserves the right to change material and finish specifications without notice, to improve its products.

Bare (suffix BC) is available upon request.

Fittings and Brackets

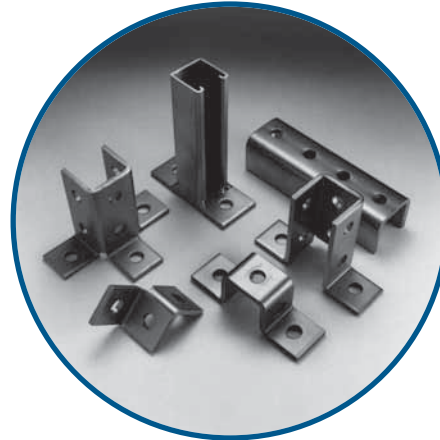
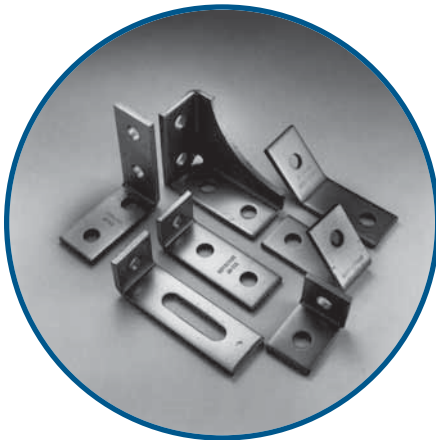

Material

Superstrut® fittings and brackets are manufactured from hot rolled carbon steel.

Dimensions

The following standard dimensions apply to all fittings except as indicated on the individual drawings.

Hole spacing	13/16 in. from end of fittings
Hole spacing	1-7/8 in. centers
Hole size	9/16 in. diameter
Material	1-5/8 in. wide
Material	1/4 in. thick

Application Instructions

Parts drawings illustrate a typical use for the fitting, and in many cases other uses for the part are appropriate.

Design Data

Load ratings vary depending fittings and brackets are used with 12, *14 or 16 gauge channel. Ratings are shown for each channel material. (See page A57 for Engineering Data and Specifications).

Nuts and Bolts Required

Unless otherwise noted, nuts and bolts for use with fittings and brackets should be ordered separately.

The standard bolt for the 9/16 in. hole is a 1/2 in. hex head cap screw 1 in. long. The 1 in. length may be used with all Series channel.

Design Load

For more information on design load, see page A57 Engineering Data and Specifications.

Finishes and Special Materials

Standard finishes are Hot Dipped Galvanized (HDGC) and GoldGalv® (no suffix). Fittings are also available in ElectroGalvanized (EG) and Stainless Steel 316 (SS6C). Contact your Regional Sales Office for availability and minimum quantities.

Aluminum channel

For Aluminum channel, we suggest fittings in HDG (C) or SS6 (C).

Fittings and Brackets

Angular Fittings

AB225

AB225HDGC
AB225EG
AB225
AB225SS6
Wt./C 58 lb.

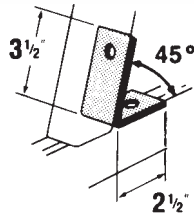

Other angles available. Contact your Regional Sales Office.

AB226

AB226HDGC
AB226SS6
Wt./C 119 lb.

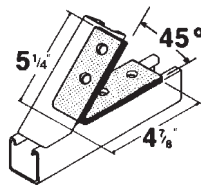

Other angles available. Contact your Regional Sales Office.

AB227

AB227HDGC
AB227EG
AB227
AB227SS6
Wt./C 58 lb.

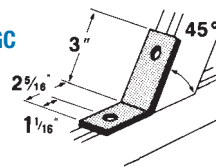

Other angles available. Contact your Regional Sales Office.

AB228

AB228HDGC
AB228SS6
Wt./C 69 lb.

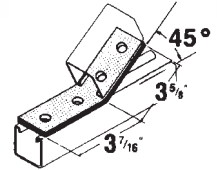

Other angles available. Contact your Regional Sales Office.

AB231

AB231EG

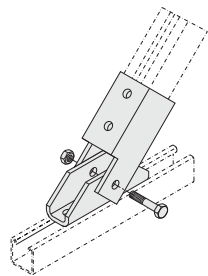
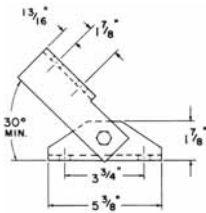

AB232

AB232EG

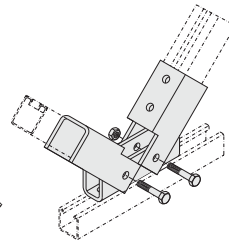
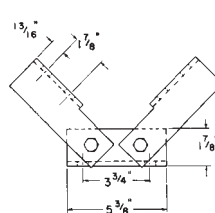

AB239

*Finishes

- HDGC
- GoldGalv®
- EG

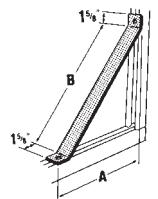

Cat. No.	A (in.)	B (in.)	Wt./C lb.
AB239-1*	7-13/16	8-1/2	148
AB239-2*	13-3/4	17	255
AB239-3*	19-3/4	25-1/2	363

"Z" Shape Fittings

A209

A209HDGC
A209EG
A209
A209SS6
Wt./C 55 lb.

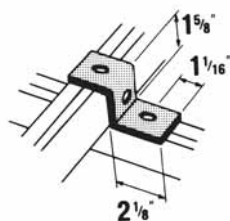

For attaching A and AR Series channel.

B209

B209HDG
B209EG
B209
Wt./C 43 lb.

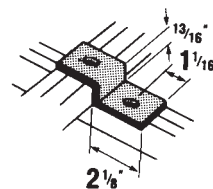

For attaching B and BR Series channel.

C209

C209
Wt./C 49 lb.

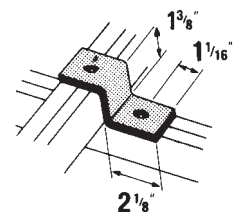

For attaching C Series channel.

D209

Wt./C 45 lb.

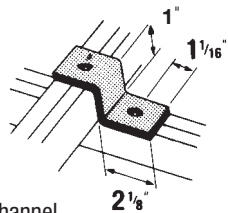

For attaching D Series channel.

CZ209

For attaching H Series and A back to back.

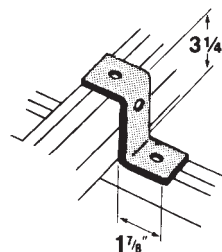

EZ209

EZ209HDGC
EZ209EG
EZ209
EZ209SS6

For attaching E Series channel.

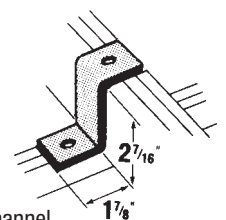

Standard Dimensions

Hole Spacing
Hole Spacing
Hole Size
Material

13/16 in. From End
1-7/8 in. Centers
9/16 in. Diam.
1-5/8 in. Width
1/4 in. Thick

Materials

HDG(C)
EG(C)
(No suffix)
SS6(C)

Hot-Dipped Galvanized
Electrogalvanized
GoldGalv®
Stainless Steel 316