

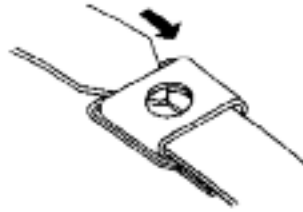

Stainless Steel Cable Ties and Accessories

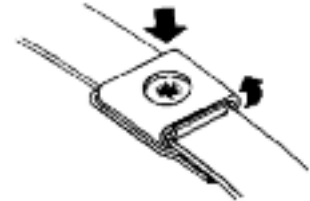

After wrapping the object to be tied, insert the free end of the tie through the buckle and into the tool.



Squeeze the handle of the tool to create the dual lock and cut off the tail. The cable tie forms a low-profile dual lock.



- The tail is formed into a fold lock behind the buckle
- The tool forces a dimple in the band into a hole in the buckle

Dual Lock

Thomas & Betts has a complete package of stainless steel cable ties and accessories that are easy to apply and superior in quality. These products have been designed for tying, lashing and identification applications in demanding environments such as boiler rooms, chemical plants, refineries, pulp/paper mills, shipyards and offshore oil platforms. They are made of a variety of high-quality stainless steel materials which offer excellent corrosion resistance, high temperature and durability characteristics. There is also a variety of high-quality installation and identification tools to complete your cable tie accessory needs.

For cable bundling, I.D. tags and other general bundling applications – especially in hazardous environments – Thomas & Betts Stainless Steel Cable Ties provide a strong, safe, permanent installation with a unique, dual lock.

The Type 304 stainless steel ties are completely fireproof – no toxic fumes, no sagging cables. They are extremely resistant to corrosion and UV light, with the ability to withstand the harshest temperature extremes. Yet they are surprisingly economical.

The low-profile ties are fast and easy to apply. A quick squeeze of the installation tool forms two strong locks – a dimple lock and a fold lock.

Their two-piece configuration adds to its versatility. Available in standard lengths to wrap bundle diameters from 1 to 10 inches, Thomas & Betts Stainless Steel Cable Ties can be supplied in other lengths on special order.

Low-profile Thomas & Betts Stainless Steel Ties are fireproof and resist corrosion, UV light and extreme weather conditions for safe, permanent cable bundling.

Installation Hand Tool

The installation hand tool is a lightweight, pocket size hand tool which quickly and easily applies the stainless steel cable ties.

To use, simply separate the pull-up handle from the body, push the release lever down and insert the clamp tail as far as possible. Squeeze the pull-up handle until the band is tight. Finally, move the pull-up handle to the locking/cut-off position by moving it away from the body as far as it will go. Then squeeze to form the dual lock and cut off the excess tail.

Catalogue Number System

CABLE TIE TYPE
SS = Two-piece solid stainless steel cable tie, Type 304
TYS = Multi-lock stainless steel cable tie, Type 316
SSR = Reusable stainless steel cable tie, Type 200/300
SSH = Heavy-duty stainless steel clamp, Type 201
TS = Roller bar locking stainless steel cable tie, Type 302/304
LS = Ball locking stainless steel cable tie, Type 302/304/316

	Bundle Diameter	Tensile Strength	Width	Length	Weight
Cat. No.	For Bundle Dia. of (in./mm)	Tensile Strength (lb./N)	Width (in./mm)	Length (in./mm)	Weight (lb./kg)
SS10-250	2/51	200/890	0.25/6.35	10.0/254	1.1/4.89
SS17-250	4/101	200/890	0.25/6.35	16.5/419	1.8/8.00

Stainless Steel Cable Ties and Accessories

SSR - Reusable

Ties to use and reuse with quickness and ease!

- Made of high-strength, corrosion-resistant 200/300 Series stainless steel
- Coated with a non-toxic, halogen-free, low-smoke Nylon 11, protecting cables from damage or interference due to direct contact with the stainless steel
- Nylon 11 is also chemical and weather-resistant, UV-protective, extremely flexible at low temperature, user-friendly on installer's hands and easy on bundles
- Unique buckle design for quick, easy application and re-use

- Insert cable tie tail through holding tabs and locking emboss.
- Bend cable tie tail up.
- Insert cable tie tail back through holding tabs, creating as tight a bend as possible. For increased tensile strength follow steps #4 and #5.
- Bend cable tie tail up.
- Fold cable tie tail over holding tabs.

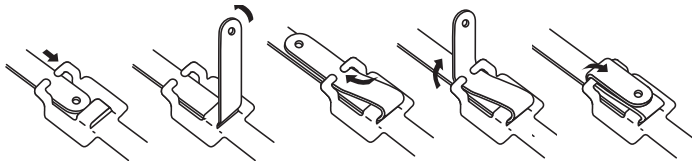

Cat. No.	Tensile Strength (lb./N)	Width (in./mm)	Length (in./mm)	Weight (lb./kg)	Std. Pkg.
Reusable Stainless Steel Cable Ties – Coated					
SSR6-250C	75/333.60	0.25/6.35	6/152	1.4/0.64	100
SSR9-250C			9/229	1.8/0.82	
SSR12-250C			12/305	2.1/0.95	
SSR18-250C			18/457	3.0/1.36	
SSR24-250C			24/610	3.7/1.68	
SSR6-375C	100/444.80	0.38/9.53	6/152	1.8/0.82	
SSR9-375C			9/229	2.0/0.91	
SSR12-375C			12/305	3.1/1.41	
SSR18-375C			18/457	4.4/2.00	
SSR24-375C			24/610	6.6/2.99	
SSR30-375C			30/762	7.0/3.18	
SSR36-375C	36/914	8.3/3.76			



WTAE200
Cable Tie Tensioner



WTAE201
Tensioning Hook



DAS250
Pistol Grip Tensioning Tool

Cat. No.	Description	Weight (lb./kg)	Std. Pkg.
Tensioning Tools			
SSR6-250C	Cable Tie Tensioner: For tensioning Reusable Ties and Multi-Lok Ties	0.6/0.27	1
SSR9-250C	Tensioning Hook: For tensioning Reusable Ties and Multi-Lok Ties	0.1/0.05	
SSR12-250C	Pistol Grip Tensioning Tool: For installing Multi-Lok, Ball Lock, & Roller Bar Lock SS Ties	1.0/0.45	

Stainless Steel Cable Ties and Accessories

Specifications



Mini Stainless Steel Cable Ties



Standard Stainless Steel Cable Ties



Reusable Stainless Steel Cable Ties



Multi-Lok Ties — Uncoated



Multi-Lok Ties — Coated



Free-End Clamps

Cat. No.		Width (in./mm)	Length (in./mm)	Thickness (in./mm)	Max. Dia. Single Wrap (in./mm)	Max. Dia. Double Wrap (in./mm)				
Specifications for Stainless Steel Ties										
SS7-180		0.18/4.50	6.5/165	0.02/0.51	1.7/43	(single wrap only)				
SS10-180			10/254		2.8/71					
SS16-180			16/406		4.7/119					
SS23-180			22.5/572		6/152	—				
SS29-180			29.0/737		8/203	—				
SS10-250		0.25/6.35	10/254		0.02/0.51	2.1/153	(single wrap only)			
SS17-250			16.5/419			4.3/109				
SS23-250			22.5/572			6.5/165				
SS29-250			29/737			8.5/215				
SS35-250			35/889			10.5/265				
SSR6-250C		0.25/6.35	6/152			0.02/0.51	1.5/38	N/A		
SSR9-250C			9/229				2.5/63	1.1/28		
SSR12-250C			12/305				3.4/86	1.5/38		
SSR18-250C			18/457				5.4/137	2.5/64		
SSR24-250C			24/610				7.3/185	3.5/89		
SSR6-375C		0.38/9.53	6/152	0.02/0.51			1.5/38	N/A		
SSR9-375C			9/229				2.5/63	1.1/28		
SSR12-375C			12/305				3.4/86	1.5/38		
SSR18-375C			18/457				5.4/137	2.5/64		
SSR24-375C			24/610				7.3/185	3.5/89		
SSR30-375C			30/762		9.1/231		4.4/112			
SSR36-375C			36/914		11.0/280		5.3/135			
Uncoated		Nylon 11 Coated								
TYS6-280	TYS6-280C	0.28/7.00	6/152		0.01/0.25		1.9/48	(single wrap only)		
TYS9-280	TYS9-280C		9/229				2.8/71			
TYS12-280	TYS12-280C		12/305			3.8/96				
TYS18-280	TYS18-280C		18/457			5.7/144				
TYS24-280	TYS24-280C		24/610			7.6/193				
TYS6-470	TYS6-470C	0.47/12.00	6/152			0.01/0.25	1.9/48		(single wrap only)	
TYS9-470	TYS9-470C		9/229				2.8/71			
TYS12-470	TYS12-470C		12/305	3.8/96						
TYS18-470	TYS18-470C		18/457	5.7/144						
TYS24-470	TYS24-470C		24/610	7.6/193						
SSH10-250		0.25/6.35	10/250	0.02/0.51			2.0/50	N/A		
SSH16-250			16/400				3.5/88	1.5/38		
SSH19-250			19/480				5.0/127	2.5/64		
SSH27-250			27/680				7.0/177	3.5/89		
SSH34-250			34/860				9.0/228	4.5/114		
SSH16-375		0.38/9.53	16/400		0.02/0.51		3.5/88	1.5/38		
SSH44-375			44/1,120				12.0/304	6.0/152		
SSH18-500		0.5/12.70	18/460				0.03/0.76	4.0/101	2.0/5.0	
SSH31-500			31/780					8.0/203	4.0/101	
SSH21-625		0.63/15.88	21/530					0.03/0.76	5.0/127	2.5/64
SSH56-625			56/1,420			16.0/406			8.0/203	
SSH69-625			69/1,750			20.0/508			10.0/254	
SSH24-750		0.75/19.05	24/600			0.03/0.76			6.0/152	3.0/76
SSH37-750			37/940						10.0/254	5.0/127
SSH50-750			50/1,270						14.0/355	7.0/177
SSH62-750			62/1,570	18.0/457					9.0/228	

Specifications (cont'd)

Cat. No.		Stainless Steel Type	Coating or Finish	Min. Loop Tensile Strength Single Wrap (lb./N)	Min. Loop Tensile Strength Double Wrap (lb./N)	Application Tools Used	Max. Dia. Single Wrap (in./mm)	
Specifications for Stainless Steel Ties (cont'd)								
SS7-180		304	Dull to Bright	100/445	(single wrap only)	WTA290	<ul style="list-style-type: none"> • Wire/cable bundling • I.D. tagging 	
SS10-180								
SS16-180								
SS23-180								
SS29-180								
SS10-250								
SS17-250				200/890		WTA250		
SS23-250								
SS29-250								
SS35-250		200/300	Nylon 11 Coated (Uncoated or other colours available on special order)	75/334	300/1,334	WTAE200	<ul style="list-style-type: none"> • Reusable • Cable bundling • Oil rigs • Telecommunications towers • Hazardous and corrosive environments • Cable trays 	
SSR6-250C								
SSR9-250C								
SSR12-250C								
SSR18-250C								
SSR24-250C								
SSR6-375C				100/445		500/2,224		WTAE201
SSR9-375C								
SSR12-375C								
SSR18-375C								
SSR24-375C								
SSR30-375C								
SSR36-375C					WTC075			
Uncoated Nylon 11 Coated (cont'd)								
TYS6-280	TYS6-280C	316	Uncoated or Nylon 11 Coated Black	250/1,112	(single wrap only)	WTAE200	<ul style="list-style-type: none"> • Self-locking • Cable bundling • Hazardous and corrosive environments 	
TYS9-280	TYS9-280C							
TYS12-280	TYS12-280C							
TYS18-280	TYS18-280C							
TYS24-280	TYS24-280C							
TYS6-470	TYS6-470C							WTAE201
TYS9-470	TYS9-470C							
TYS12-470	TYS12-470C							
TYS18-470	TYS18-470C							
TYS24-470	TYS24-470C							WTC075
SSH10-250		201	Bright	450/2,002	1,200/5,338	WTJ020 WTC075 WTC001	<ul style="list-style-type: none"> • Industrial hoses • Cable bundling • High strength 	
SSH16-250								
SSH19-250								
SSH27-250								
SSH34-250								
SSH16-375								900/4,003
SSH44-375								
SSH18-500				1,400/6,227	3,300/14,678	WTC075 WTC001		
SSH31-500								
SSH21-625								1,700/7,562
SSH56-625								
SSH69-625				2,000/8,896	5,000/22,240	WTC001		
SSH24-750								
SSH37-750								
SSH50-750								
SSH62-750								

Ty-Rap® Stainless Steel Cable Ties have passed a variety of mechanical, environmental, and electrical tests. Other data can be made available upon request. S.S. Series also available in (316) Stainless.