

A.
About
Panduit

B.
Copper
Systems

C.
Fiber
Systems

D.
Faceplates,
Outlet
Frames &
Surface
Mount Boxes

E.
Keystone
Cabling
Systems

F.
Zone
Cabling

G.
Cable
Routing
Systems

H.
Surface
Raceway

J.
Cabinets,
Racks &
Cable
Management
Systems

K.
Power
Management

L.
Grounding
&
Bonding

M.
Identification
Products

N.
Cable
Management
Accessories

O.
Part
Number
Index

FiberRunner® Accessories (continued)



FR716DR



FR516DR



FRSTRCBL



FRTBKT-X

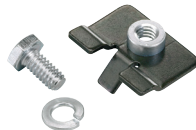

FRQMC-X



TR1-12-X
TR1-58-X



TRC18FR-X8Y

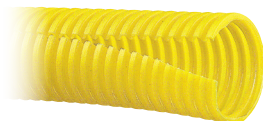

CLT150F-X4

Part Number	Part Description	Couplers Required	Std. Pkg. Qty.	Std. Ctn. Qty.
-------------	------------------	-------------------	----------------	----------------

3/8" Nut Driver

FR38DR	Used to disassemble 4x4, 6x4, and 12x4 FiberRunner® QuikLock™ Couplers when required.	—	1	10
--------	---	---	---	----

7/16" Nut Driver

FR716DR	7/16" nut driver for use with the FiberRunner®, GridRunner®, and Wyr-Grid® Systems.	—	1	10
---------	---	---	---	----

5/16" Nut Driver

FR516DR	Used to disassemble 2x2 FiberRunner® QuikLock™ Couplers when required.	—	1	10
---------	--	---	---	----

Strut Clip Kit

FRSTRCBL	Strut mounting clip assembly allows FiberRunner® Channel to be attached directly to standard 1 5/8" wide strut structures. Contains two clips and all hardware for assembly. Bolts release with 7/16" nut driver.	—	1	10
----------	---	---	---	----

1/4" T-Bolt Kit

FRTBKT-X	T-bolts can be used for additional attachment when securing FiberRunner® Channel to mounting brackets. For example, a T-bolt can be inserted thru a 12x4 mounting bracket and positioned within the center rib structure on the underside of 12x4 channel. By tightening the nut, the 12x4 channel is more securely fastened to the mounting bracket.	—	10	100
----------	---	---	----	-----

FiberRunner® Quick Mount Clips

FRQMC-X	Used wherever additional FiberRunner® Slide Clamps would be helpful. For example, use on 12x4 FiberRunner® QuikLock™ Brackets to accommodate dual runs of 6x4 or 4x4 FiberRunner® Channel.	1/2"	10	—
---------	--	------	----	---

Threaded Rod in One Foot Lengths

TR1-12-X	Threaded rod can be used with various mounting brackets. Length = 12" (305mm).	1/2"	10	—
TR1-58-X	Threaded rod can be used with various mounting brackets. Length = 12" (305mm).	5/8"	10	—

Threaded Rod Cover

TRC18FR-X8Y	Used to protect cabling from threaded rod. Vertical slit allows easy installation. For indoor use only. Gray.	1/2" – 5/8"	10	100
TRC18FR-X20Y	Used to protect cabling from threaded rod. Vertical slit allows easy installation. Black.	1/2" – 5/8"	10	100

Slit Corrugated Loom Tubing

CLT150F-X4*	Slit corrugated loom tubing provides a vertical pathway as cables transfer from the FiberRunner® Fitting to the equipment below. Inside diameter is 1.48" (37.6mm) and outside diameter 1.73" (43.9mm). Sold in 10' rolls.	—	1	—
-------------	--	---	---	---

*For other colors replace X4 (Yellow) with X3 (Orange) or X20 (Black).

Continues on next page