

Disconnects

Panduit® Pan-Term® Disconnects are designed and precision made to function as a reliable method of making quick, repeatable interconnections. Available with nylon, premium nylon, vinyl insulation or non-insulated.



- Fully insulated design provides excellent protection from electrical shorts and provides additional installer protection for safety from electrical shocks
- Funnel entry speeds insertion and minimizes turned back wire strands
- Integrated metal insulation grip provides double crimp insulation grip for high vibration or conductor strain environments on select **Supra-Grip™** Disconnects and **DiscoGrip™** Disconnects
- Applicable sizes are UL Listed and CSA Certified, as noted
- Wide assortment of manual, controlled cycle, battery operated hydraulic and pneumatic crimping tools for reliable connections at the lowest installed cost

Panduit continually provides new designs to meet the application challenges encountered by our customers. Panduit offers a wide assortment of Pan-Term® termination products at the lowest installed cost.

Features and Benefits – Pan-Term® Disconnects

Pan-Term® Disconnects are fabricated from brass and are electro tin-plated for a long, corrosion resistant operating life.

Nylon Fully Insulated Female Receptacles and Male Tabs Type DNF-FIB

Available in tab sizes to accommodate 0.110", 0.187", 0.205" or 0.250" tabs

Fully insulated design provides protection from electrical shorts

Expanded wire entry (on select sizes) accommodates large insulation or multiple wires

Maximum insulation temperature 221°F (105°C)

Insulation support restricts excessive wire movement to minimize stress on crimp joint

Funnel entry for faster wire insertion and lower installed cost



UL and CSA rated up to 600 V per UL 310. Flammability – UL 94 HB.

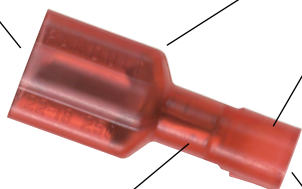

Disco-Grip™ Premium Nylon Fully Insulated Female Receptacles and Male Tabs Type DPF

Available in tab sizes to accommodate 0.110", 0.187", 0.205" or 0.250" tabs

Fully insulated design provides protection from electrical shorts

Maximum insulation temperature 221°F (105°C)

Funnel entry for faster wire insertion and lower installed cost



UL and CSA rated up to 600 V per UL 310. Flammability – UL 94V-2. Male products available 0.250" width in standard and oversized housing configurations.

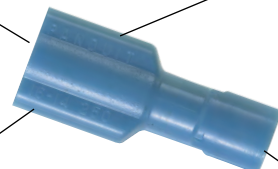

Supra-Grip™ Nylon Fully Insulated Female Disconnects Type DNG-FB

Available in tab sizes to accommodate 0.187" or 0.250" tabs

Fully insulated design provides protection from electrical shorts

Maximum insulation temperature 221°F (105°C)

Funnel entry for faster wire insertion and lower installed cost

Fully integrated metal insulation grip for high vibration, high strain relief, and double crimp requirements



UL and CSA rated up to 600 V per UL 310. Flammability – UL 94 HB.



Panduit® designs and manufactures a full line of labeling products, software, and printers to assist you with your labeling requirements.

See pages E1.1 – E2.27.

Continues on next page

Features and Benefits – Pan-Term® Disconnects (continued)

Nylon Barrel Insulated Female Receptacles and Male Tabs Type DNF

Available in tab sizes to accommodate 0.110", 0.187", 0.205" or 0.250" tabs

Maximum insulation temperature 194°F (90°C)



Funnel entry for faster wire insertion and lower installed cost

Insulation grip sleeve provides a superior insulation crimp for high vibration and high strain relief applications



UL and CSA rated up to 300 V per UL 310.
Flammability – UL 94 HB.
Male products available 0.250" width.

Vinyl Barrel Insulated Female Receptacles and Male Tabs Type DV and DVF

Available in tab sizes to accommodate 0.187", 0.205", or 0.250" tabs

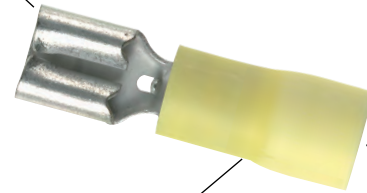

Insulation support to protect electrical crimp

Insulation grip sleeve provides a superior insulation crimp for high vibration and high strain relief applications



UL and CSA rated up to 300 V per UL 310.
Male products available 0.250" width.
Flammability – UL 94V-0.

Non-Insulated Female Receptacles and Male Tabs Type D

Available in tab sizes to accommodate 0.187" or 0.250" tabs

Sleeved barrel assures crimp reliability

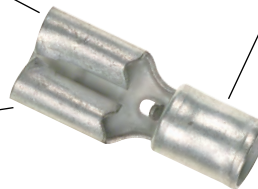

Maximum recommended operating temperature 302°F (150°C)



UL and CSA rated up to 2000 V per UL 310.
Male products available 0.250" width.

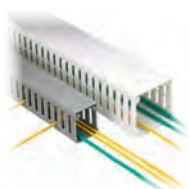

Panduit® wiring duct offers a wide variety of sizes and types to meet the wire capacity needs and space constraints of the smallest wall mounted to the largest integrated systems.

See pages C1.1 – C1.53.



A comprehensive selection of cable ties used to bundle, mount, and identify wire and cable.

See pages B1.1 – B1.106.

B1.
Cable
Ties

B2.
Cable
Accessories

B3.
Stainless
Steel Cable
Ties &
Accessories

C1.
Wiring
Duct

C2.
Abrasion
Protection

C3.
Cable
Management

D1.
Terminals

D2.
Power
Connectors

D3.
Grounding
Connectors

E1.
Labeling
Systems

E2.
Labels

E3.
Pre-Printed
&
Write-On
Markers

E4.
Permanent
Identification

E5.
Industrial
Safety
Solutions

F.
Keystone
Cabling
Systems

G.
Part
Number
Index

Selection Guide – Pan-Term® Disconnects

Material	Style	Design	Feature	Type	Page Number
Nylon	Fully Insulated	Female	Funnel Entry, Ins. Grip	DNG-FB	D1.33
		Female	Funnel, Ins. Support, Two-Pc.	DNF-FIB	D1.35
		Female	Funnel, Ins. Support, Three-Pc.	DNF-FI	D1.35
		Female	Funnel Entry, Premium Nylon	DPF-FIB	D1.36
		Male	Funnel, Ins. Support, Two-Pc.	DNF-FIM	D1.34
	Barrel Insulated	Male	Premium Nylon	DPF-FIM	D1.36
		Female Right Angle	Funnel Entry, Ins. Support	DNFR-FIB	D1.39
		Female Right Angle	Funnel Entry, Open Top	DNFR-B	D1.40
		Female	Funnel Entry, Ins. Grip	DNF	D1.37
		Male	Funnel Entry, Ins. Grip	DNF-M	D1.41
Vinyl	Barrel Insulated	Female	Funnel Entry, Ins. Grip, Three-Pc.	DVF	D1.38
		Female	Funnel Entry, Butted Seam, Two-Pc.	DV-B	D1.38
	Male	Funnel Entry, Butted Seam, Two-Pc.	DV-MB	D1.42	
	Piggyback	Funnel Entry, Ins. Grip	DV-P	D1.41	
Heat Shrink	Fully Insulated	Female	Heat Shrink Insulated	DNH-FIB	D1.37
		Male	Heat Shrink Insulated	DNH-FIM	D1.37
Non-Insulated		Female	Sleeved Barrel	D	D1.39
		Female Right Angle	Sleeved Barrel	DR	D1.40
		Male	Butted Seam	D-MB	D1.42
		Adapter	Two Female to One Male	D-A	D1.41



Part Number System for Pan-Term® Disconnects

P	NF	—	14	250	FIB	—	M
Type	Insulation		Wire Range	Tab Size	Special Configuration		Std. Pkg. Size
D = Disconnects	N = Nylon NF = Nylon, Funnel Entry NFR = Nylon, Funnel Entry, Right Angle NG = Nylon, Funnel Entry, Metal Insulation Grip NH = Heat Shrink PF = Premium Grade Nylon, Funnel Entry R = Non-insulated, Right Angle V = Vinyl VF = Vinyl Funnel Entry = Non-Insulated (leave blank)		18 = #22 – 18 14 = #16 – 14 10 = #12 – 10	110 = 0.110 x 0.032 111 = 0.110 x 0.020 187 = 0.187 x 0.032 188 = 0.187 x 0.020 205 = 0.187/0.205 x 0.032 206 = 0.187/0.205 x 0.020 250 = 0.250 x 0.032	A = Adapter B = Butted Seam FB = Metal Insulation Grip, Female FI = Fully Insulated, Female FIB = Fully Insulated, Butted Seam, Female FIM = Fully Insulated, Male FIMB = Fully Insulated, Male with oversized housing M = Male MB = Butted, Male P = Piggyback = Female (leave blank)		Q = 25 L = 50 C = 100 D = 500 M = 1000

UL LISTED CERTIFIED **Supra-Grip™ Female Disconnect, Nylon Fully Insulated – Funnel Entry**

Type DNG-FB

- Disconnect can be inserted and removed from the male tab without the use of tools for lower installed cost
- Flared barrel extension integrated into stamping to provide insulation grip for double crimp requirements
- Fully insulated design provides protection from electrical shorts
- Internal barrel serrations assure good wire contact and maximum tensile strength
- Internal wire stop assures proper length of insertion into terminal barrel, providing a higher-quality connection
- Mates with DNF-FIMB family
- UL Flammability UL 94 HB, maximum insulation temperature 221°F (105°C)
- UL and CSA rated up to 600 V per UL 310

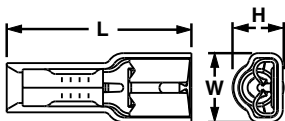

Part Number	Wire Range	Color Code	Max. Ins. (In.)	Figure Dimensions (In.)			Tab Size (In.)	Recommended Installation Tool	Std. Pkg. Qty.**	Std. Ctn. Qty.
				L	W	C				
DNG18-187FB-C	22 – 18 AWG	Red	0.126	0.89	0.29	0.22	0.187 x 0.032	CT-1015	100	1000
DNG18-188FB-C				0.89	0.29	0.22	0.187 x 0.020			
DNG18-250FB-L				0.93	0.35	0.22	0.250 x 0.032			
DNG14-187FB-L*	16 – 14 AWG	Blue	0.153	0.89	0.29	0.25	0.187 x 0.032	CT-1015	50	250
DNG14-188FB-L*				0.89	0.29	0.25	0.187 x 0.020			
DNG14-250FB-L				0.93	0.35	0.25	0.250 x 0.032			

*UL Recognized for use with copper alloy tabs.

**Bulk packaging may be available, contact Panduit® Customer Service for additional information. For crimping tool information see www.panduit.com/tools.