

GRSS Conduit Outlet Boxes with Multiple Hubs

Explosionproof, Dust-Ignitionproof, Raintight

UNILETS™ for use with Threaded Metal Conduit. Furnished with Internal Ground Screw and O-ring gasket.

NEC/CEC:

Class I, Division 1 and 2, Groups B♦, C, D
Class II, Division 1 and 2, Groups E, F, G
Class III

Applications

- Complies with a wide range of classified area requirements.
- Corrosion-resistant: ideal indoors or out.
- For pulling of wires.
- Connect conduit lengths and change direction of conduit runs.
- Provide access for maintenance.

Features

- Accurately tapped, tapered hub threads for tight, rigid joints and ground continuity.
- Furnished with covers.
- General purpose wiring.
- Multiple hubs permit flexibility.
- Copperfree aluminum body and cover provide superior corrosion resistance.
- Internal ground screw standard.
- Cover o-ring included.

Standard Materials



- Bodies and covers: copperfree (4/10 of 1% max.) aluminum

Standard Finishes

- Epoxy powder coat

NEC/CEC Certifications and Compliances

- UL Standard: UL 886 (UL 1203)
- UL Listed: E85310
- CSA Standard: C22.2 No. 25, C22.2 No. 30
- CSA Certified: 025875

Box Type	Conduit Size (Inches)	Cover Opening mm (in)	Hubs	Plugs	Capacity dm ³ (in ³)	Catalog Number ♦
GRSS Outlet Box with Cover						
						
GRSS	1/2	85.9 (3.38)	7	4	0.48 (29.0)	GRSS50
	3/4	85.9 (3.38)	7	4	0.48 (29.0)	GRSS75
	1	85.9 (3.38)	7	4	0.48 (29.0)	GRSS100
GRSSA Outlet Box with Cover						
						
GRSSA	1/2	85.9 (3.38)	13	5	0.48 (29.0)	GRSSA50
	3/4	85.9 (3.38)	13	5	0.48 (29.0)	GRSSA75

Dimensions in Millimeters (Inches)

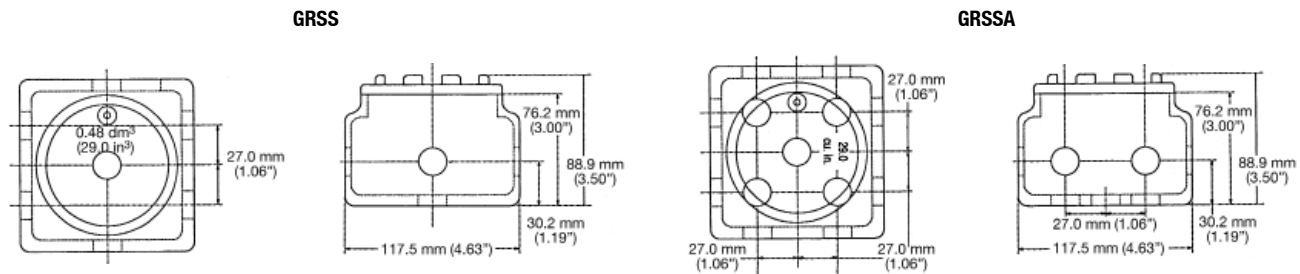

♦ In Class I, Division 1, Group B atmospheres, all conduit runs must have a sealing fitting (not supplied) field-installed adjacent to the enclosure.