

TYPE YBA-A

BREAK-AWAY HYLUG™

Aluminum Compression Terminals
UL Listed 90° C, Up to 35 kV ♦

The Break-Away HYLUG™ line of Aluminum terminals are designed to provide maximum field flexibility by allowing the installer (using the break-away feature) to easily convert a two-hole terminal into a one-hole terminal to suit the application while retaining UL Listing and CSA Certification.

The Break-Away HYLUG™ line of terminals encompasses a wide range of features that offers the installer the flexibility to meet the requirements of challenging projects.

Features & Benefits

- Break-Away feature allows for field modification of the terminal from a two-hole design to a one-hole design
- Field modification of the terminal does not require specialized tooling or training
- Narrow tongue design allows for the terminal to fit into tight spaces
- Accommodates copper and aluminum wire
- Factory prefilled with PENETROX™ oxide inhibiting compound
- Slotted second stud provides built in flexibility for the terminal to conform to various bus bar dimensions.
- Terminals are range taking when installed with Y644 or PAT644XT-18V tooling platforms
- Electro-tin plated provides durable long lasting corrosion resistance
- Internal bevel edge provides easy cable insertion
- Connector clearly marked with wire size, die index, and color code



C-93

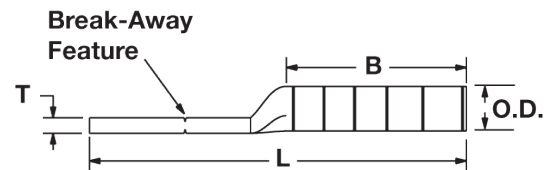

NOTE: Field bending straight lugs to achieve an angular connection will void UL Listing / CSA Certifications and BURNDY will not be liable for the connection.

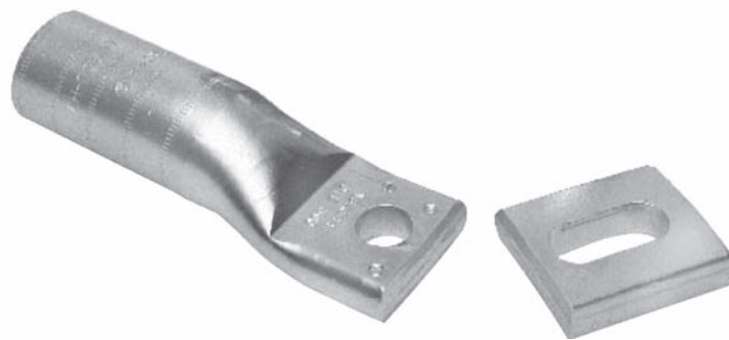

Compression Connections

BURNDY®

Aluminum Compression — Long Barrel — Break-Away

TYPE YBA-A

BREAK-AWAY HYLUG™

(Continued)

Aluminum Compression Terminals

UL Listed 90° C, Up to 35 kV ♦

C-94

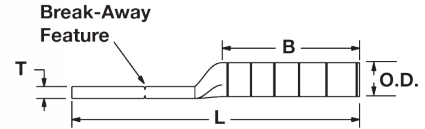

NOTE: Field bending straight lugs to achieve an angular connection will void UL Listing / CSA Certifications and BURNDY will not be liable for the connection.

Catalog Number	Conductor Size (Concentric and Compact)	Dimensions						Installation Tooling (# of crimps)						
		Stud Hole Spacing	Stud Hole Size	Tongue Width	B	T	L	Dieless	MD6, MD7, MD7-34R platforms OUR840**	Y500CTHS, PAT60018V, PATMD6 platform	35, 39, 750 platforms, *46 platforms	Color Code	Die Index	
YBA25A	1/0	1" to 1.75"	1/2	1.03	1.05	0.17	4.59	MY29 (MY29 platform tools for use on CODE conductor only), 644 platforms (1), 4-POINT® platforms (2)	W241 (2) X241 (4)	W241 (2)	U25ART (1)	Tan	296	
YBA26A	2/0	1" to 1.75"	1/2	1.03	1.17	0.20	4.78		—	—	U26ART (2)	Olive	297	
YBA27A	3/0	1" to 1.75"	1/2	1.04	1.31	0.26	5.02		—	—	U27ART (2)	Ruby	467	
YBA28A	4/0	1" to 1.75"	1/2	1.17	1.39	0.30	5.19		—	W660 (4)	U28ART (2)	White	298	
YBA29A	250 kcmil	1" to 1.75"	1/2	1.26	1.45	0.33	5.28		—	—	U29ART (2)	Red	324	
YBA30A	300 kcmil & ±4/0 AWG CCA DLO (329/22)	1" to 1.75"	1/2	1.38	1.53	0.36	5.64	644 platforms (1) 4-POINT® platforms (4)	—	—	U30ART (2)	Blue	470	
YBA31A	350 kcmil & ±250 kcmil CCA DLO (399/22)	1" to 1.75"	1/2	1.52	1.85	0.39	6.07		—	—	U31ART (2)	Brown	299	
YBA32A	400 kcmil	1" to 1.75"	1/2	1.62	2.26	0.43	6.15		—	—	U32ART (4)	Green	472	
YBA34A	500 kcmil & ±350 kcmil CCA DLO (551/22)	1" to 1.75"	1/2	1.62	2.34	0.46	6.80		—	—	U34ART (4)	Pink	300	
YBA36A	600 kcmil & ±500 kcmil CCA DLO (779/22)	1" to 1.75"	1/2	1.31	2.47	0.52	7.09		—	—	U36ART (4)	Black	473	
YBA39A	700 / 750 kcmil & ±600 kcmil CCA DLO (925/22)	1" to 1.75"	1/2	1.62	2.46	0.43	7.07		—	—	U39ART-2 (4)	Yellow	936	
YBA42A	600 - 900 kcmil	1" to 1.75"	1/2	1.62	2.46	0.39	7.15		—	—	U42ART (4)	Gray	303	
YBA44A	1000 kcmil & ±750 or 800 kcmil CCA DLO (1184/22) or (1250/22)	1" to 1.75"	1/2	1.65	2.74	0.55	7.76		Y644 platform (1)	—	—	P44ART (4)	Brown	302

† Can only be crimped with PAT46 or Y46 platform tools using the P44ART die

‡ UL Listed with DLO Copper Clad Aluminum conductor using Y644 tools ONLY

* Y46 and PAT46 platforms require PUADP-1 adaptor to use U dies

** OUR840 can use X-style dies only

▲ U die for 900 AL only