

**COMPRESSION
TERMINALS &
ACCESSORIES**

Compression terminals are used to make convenient and reliable connections to switch pads, transformers, and other electrical equipment. They accommodate either copper, aluminum, ACSR, ACAR, Alumoweld, or steel conductor and come with one, two or four hole NEMA drilled pads to match the equipment drilling. Standard copper and aluminum terminals are also listed in the compression section C.

**TYPES YCA-2N
& YCAB-4N**

HYLUG™

ACCOMMODATES: COPPER

MATERIAL: COPPER

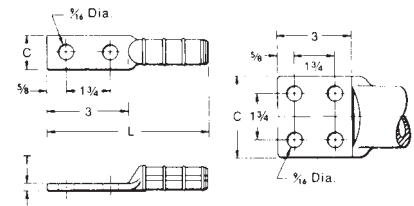

Fig. 1

Fig. 2

Compression HYLUG™ terminals designed for terminating copper conductors to switch pads and other substation or switch yard apparatus. NEMA standard mounting holes. Made of pure copper. Installed with same die as equivalent full-tension jumper loop and repair sleeves.

Catalog Number	Conductor	Fig. No.	C	L	T	Die Index	Tools, Die Set Catalog Number, & (Number of Crimps)		
							MD7, MD6	Y35, Y750, Y45†, Y46‡	Y60-
YCA25-2N	1/0 (7, 19)	1	7/8	5-3/8	1/8	165	W165 (3)	U165/U205 (3)	—
YCA26-2N	2/0 (7, 19, 37)		1	5-1/4	1/4	166	W166 (6)	U166/U459 (3)	—
YCA27-2N	3/0 (7, 19)		1-1/8	5-3/8		167	—	U167/U568 (3)	L167 (1)
YCA28-2N	4/0 (7, 12, 19)		1-1/4		168	—	U168 (3)	L168 (1)	
YCAB28-4N	4/0 (7, 12, 19)	2	3	5-5/8	3/8	169	—	U169 (4)	L169 (1)
YCA29-2N	250 (7, 19, 37)	1	1-3/8			5-1/2	170	—	U170 (5)
YCA30-2N	300 (19, 37)		1-1/2	6-1/2	1/2	267	—	U267 (6)	L267 (2)
YCA31-2N	350 (12, 19, 37)		1-5/8			6-3/4	209	—	U209 (6)
YCAB32-4N	400 (19, 37)		2	3	7-1/8	210	—	U210 (6)	L210 (2)
YCA34-2N	500 (19, 37)	1	1-7/8	6-1/2	3/8		—		
YCAB34-4N	500 (19, 37)	2	3	6-7/8	1/2	—	627	—	L627 (3)
YCA39-2N	750 (37, 61)	1	2-3/8	7-1/4	5/8	—			
YCAB39-4N	750 (37, 61)	2	3	7-1/2	1/2	—	—	—	
YCAB44-4N	1000 (61)			7-7/8	5/8	345	—	—	L345 (4)

YCAB have brazed pads.

† U Die with adapter PT-6515
‡ U Die with adapter PUADP-1

To ensure proper tightening torque use BURNDY® BTW torque wrenches.