

WMFB SERIES™ FLOOR BOXES



Multi-Service Floor Box Assembly Kits for Wood Floors for New and Retrofit Residential Applications.

CODE REFERENCE

cULus Listed
Nonmetallic Outlet Boxes:
 File E143222 Guide QCMZ.
 Meets Article 314.27(C) of NEC.

WMFB Series Floor Boxes Ordering Information

Knockouts:

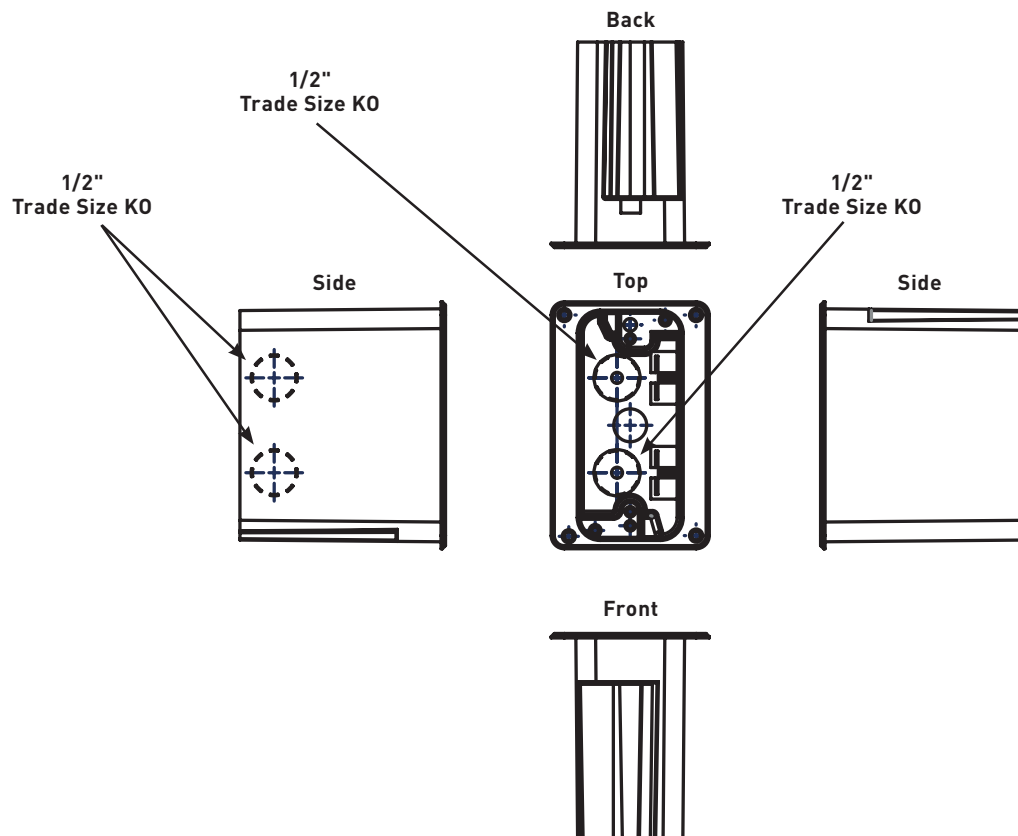

COLOR OPTIONS

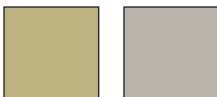

WMFB Series™ Cover Plates are available in these colors as indicated in the part number descriptions.

Custom color options are also available. Consult the factory for more information.

WMFB SERIES™ FLOOR BOXES

WMFB Series Floor Boxes Ordering Information (continued)

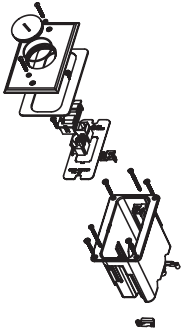
WMFB1KS2B Single-Gang Floor Box Assembly

Includes single-gang box, device plate with two openings for communication devices, and brass cover with one screw plug. For hole cut dimensions, see installation instructions sheet.

Box Dimensions:
2 1/8" W x 3 3/4" L x 3 7/8" D
[54mm W x 95mm L x 98mm D]
Device Plate:
3 1/8" W x 4 15/16" L
[79mm W x 125mm L]

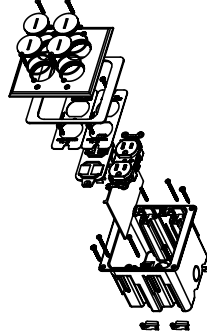
WMFB2DRKS4B Dual-Gang Floor Box Assembly

Includes dual-gang box, one 15A tamper-resistant duplex receptacle, 106 adapter with four openings for communication devices, and brass cover with four screw plugs. For hole cut dimensions, see installation instructions sheet.

Box Dimensions:
3 1/4" W x 3 3/4" L x 3 7/8" D
[83mm W x 95mm L x 98mm D]
Device Plate:
4 7/8" W x 5 1/16" L
[124mm W x 129mm L]

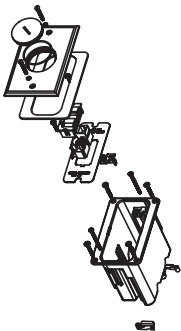
WMFB1KS2N Single-Gang Floor Box Assembly

Includes single-gang box, device plate with two openings for communication devices, and nickel cover with one screw plug. For hole cut dimensions, see installation instructions sheet.

Box Dimensions:
2 1/8" W x 3 3/4" L x 3 7/8" D
[54mm W x 95mm L x 98mm D]
Device Plate:
3 1/8" W x 4 15/16" L
[79mm W x 125mm L]

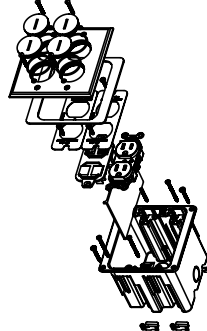
WMFB2DRKS4N Dual-Gang Floor Box Assembly

Includes dual-gang box, one 15A tamper-resistant duplex receptacle, 106 adapter with four openings for communication devices, and nickel cover with four screw plugs. For hole cut dimensions, see installation instructions sheet.

Box Dimensions:
3 1/4" W x 3 3/4" L x 3 7/8" D
[83mm W x 95mm L x 98mm D]
Device Plate:
4 7/8" W x 5 1/16" L
[124mm W x 129mm L]

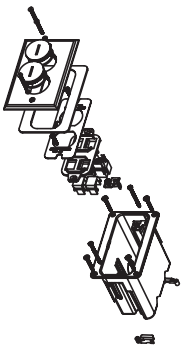
WMFB1KS4B Single-Gang Floor Box Assembly

Includes single-gang box, 106 adapter with four openings for communication devices, and brass cover with two screw plugs. For hole cut dimensions, see installation instructions sheet.

Box Dimensions:
2 1/8" W x 3 3/4" L x 3 7/8" D
[54mm W x 95mm L x 98mm D]
Device Plate:
3 1/8" W x 4 15/16" L
[79mm W x 125mm L]

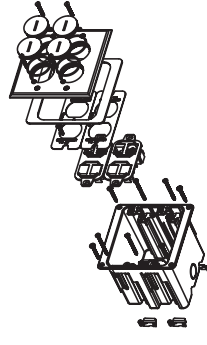
WMFB2KS8B Dual-Gang Floor Box Assembly

Includes dual-gang box, two 106 adapter with eight openings for communication devices, and brass cover with four screw plugs. For hole cut dimensions, see installation instructions sheet.

Box Dimensions:
3 1/4" W x 3 3/4" L x 3 7/8" D
[83mm W x 95mm L x 98mm D]
Device Plate:
4 7/8" W x 5 1/16" L
[124mm W x 129mm L]

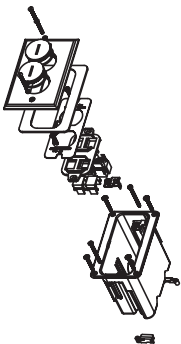
WMFB1KS4N Single-Gang Floor Box Assembly

Includes single-gang box, 106 adapter with four openings for communication devices, and nickel cover with two screw plugs. For hole cut dimensions, see installation instructions sheet.

Box Dimensions:
2 1/8" W x 3 3/4" L x 3 7/8" D
[54mm W x 95mm L x 98mm D]
Device Plate:
3 1/8" W x 4 15/16" L
[79mm W x 125mm L]

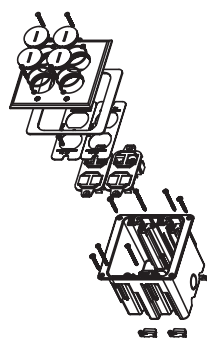
WMFB2KS8N Dual-Gang Floor Box Assembly

Includes dual-gang box, two 106 adapter with eight openings for communication devices, and nickel cover with four screw plugs. For hole cut dimensions, see installation instructions sheet.

Box Dimensions:
3 1/4" W x 3 3/4" L x 3 7/8" D
[83mm W x 95mm L x 98mm D]
Device Plate:
4 7/8" W x 5 1/16" L
[124mm W x 129mm L]