

Ordering

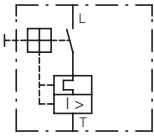
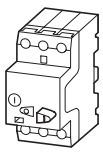

PKZM01

Max. motor rating AC-3		
220 V	380 V	440 V
230 V	400 V	
240 V	415 V	

Rated
uninter-
rupted
current

Setting range

Overload
releases

Short-
circuit
releases

P	P	P	I_u	I_r	I_{rm}
kW	kW	kW	A	A	A

Screw terminals

Part no.
Article no.

Price
See price
list

Std. pack

Information relevant for export to
North America



Motor-protective circuit-breakers, type "1"; and type "2" coordination

–	–	–	0.16	0.1...0.16	2.2	PKZM01-0.16 278475	1 off 	Product Standards	UL 508; CSA-C22.2 No.14; IEC60947- 4-1; CE marking				
–	0.06	0.06	0.25	0.16...0.25	3.5	PKZM01-0.25 278476	1 off 	UL File No.	E36332				
0.06	0.09	0.12	0.4	0.25...0.4	5.6	PKZM01-0.4 278477	1 off 	UL CCN	NLRV				
0.09	0.12	0.18	0.63	0.4...0.63	8.8	PKZM01-0.63 278478	1 off 	CSA File No.	12528				
0.12	0.25	0.25	1	0.63...1	14	PKZM01-1 278479	1 off 	CSA Class No.	3211-05				
0.25	0.55	0.55	1.6	1...1.6	22	PKZM01-1.6 278480	1 off 	NA Certification	UL Listed, CSA certified				
0.37	0.75	1.1	2.5	1.6...2.5	35	PKZM01-2.5 278481	1 off 	Suitable for	Branch circuits, or suitable for group installations				
0.75	1.5	1.5	4	2.5...4	56	PKZM01-4 278482	1 off 	See also	→ Page 34				
1.1	2.2	3	6.3	4...6.3	88	PKZM01-6.3 278483	1 off 						
2.2	4	4	10	6.3...10	140	PKZM01-10 278484	1 off 						
3	5.5	5.5	12	8...12	168	PKZM01-12 278485	1 off 						
4	7.5	9	16	10...16	224	PKZM01-16 283390	1 off 						
5.5	9	11	20	16...20	280	PKZM01-20 283383	1 off 	Product Standards	UL 508; CSA-C22.2 No.14; IEC/EN 60947- 4-1; CE marking				
5.5	12.5	12.5	25	20...25	350	PKZM01-25 288893	1 off 	UL File No.	E36332				
								UL CCN	NLRV				
								CSA File No.	12528				
								CSA Class No.	3211-05				
								NA Certification	UL Listed, CSA certified				

Notes

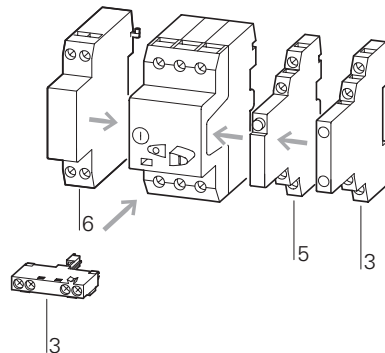

Accessories

3 Standard auxiliary contacts

5 Trip-indicating auxiliary contact

6 Shunt release, undervoltage release

Phase failure sensitivity to IEC/EN 60947-4-1, VDE 0660 Part 102.

Can be snap-fitted to IEC/EN 60715 top-hat rail with 7.5 or 15 mm height

Page

→ 10

→ 12

→ 29