

Accessories

Cover Clip

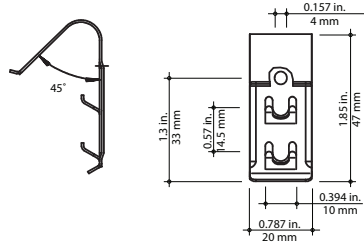

Dimensions



Secure covers to tray quickly with this cover clip. Available in stainless steel (type 316), the cover clip uses built-in tabs to secure the cover and to facilitate removal of the cover when required. No tools required.

EXPRESS TIP

Refer to page C44 for an application example.

Cat. No.	Material	Weight	
		lb./ea.	kg/ea.
ETA-CC-S6	Stainless Steel (Type 316)	0.10	0.05



Standard Packaging

Blackburn® Grounding Connector



Dimensions

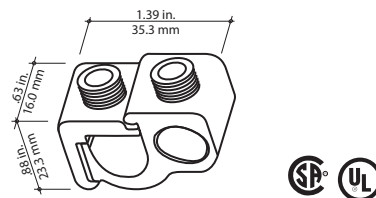

Note: To ensure electrical continuity, the Blackburn® GPT-2 grounding connector and ground wire **MUST** be used in all QuikLok™ Series tray applications.

Cat. No.	Conductor Range	Weight	
		lb./ea.	kg/ea.
GPT-2	#12-#2 AWG	0.06	0.03

ETG Lay-In Ground Lug

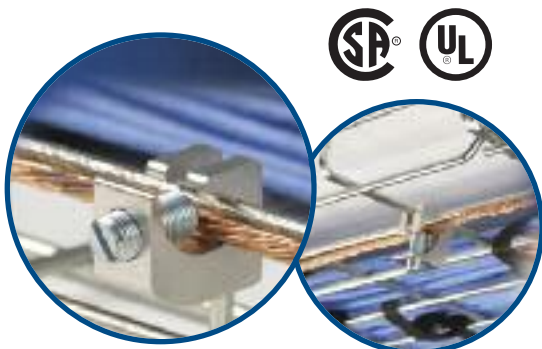
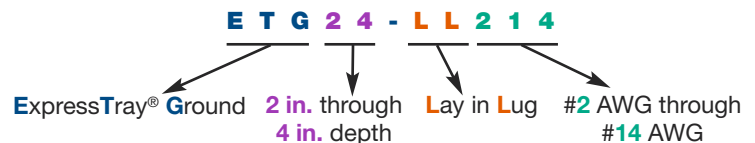

- Lay in lug design easily installs onto any ExpressTray® 2 in. through 4 in. deep without any disassembly required.
- Approved for steel and stainless steel wire mesh trays.
- Accepts 12 AWG solid through 2 AWG stranded aluminum and 14 AWG solid/stranded through 2 AWG stranded copper conductors.
- “Slotted hook” design sits securely onto the ExpressTray® mesh intersections to restrict swiveling.
- **Must be** used on each length of QuikLok™ Series tray applications to meet CSA requirements.